

OCTA NORM

PROFILE

KOMBINIEREN
MIT SYSTEM

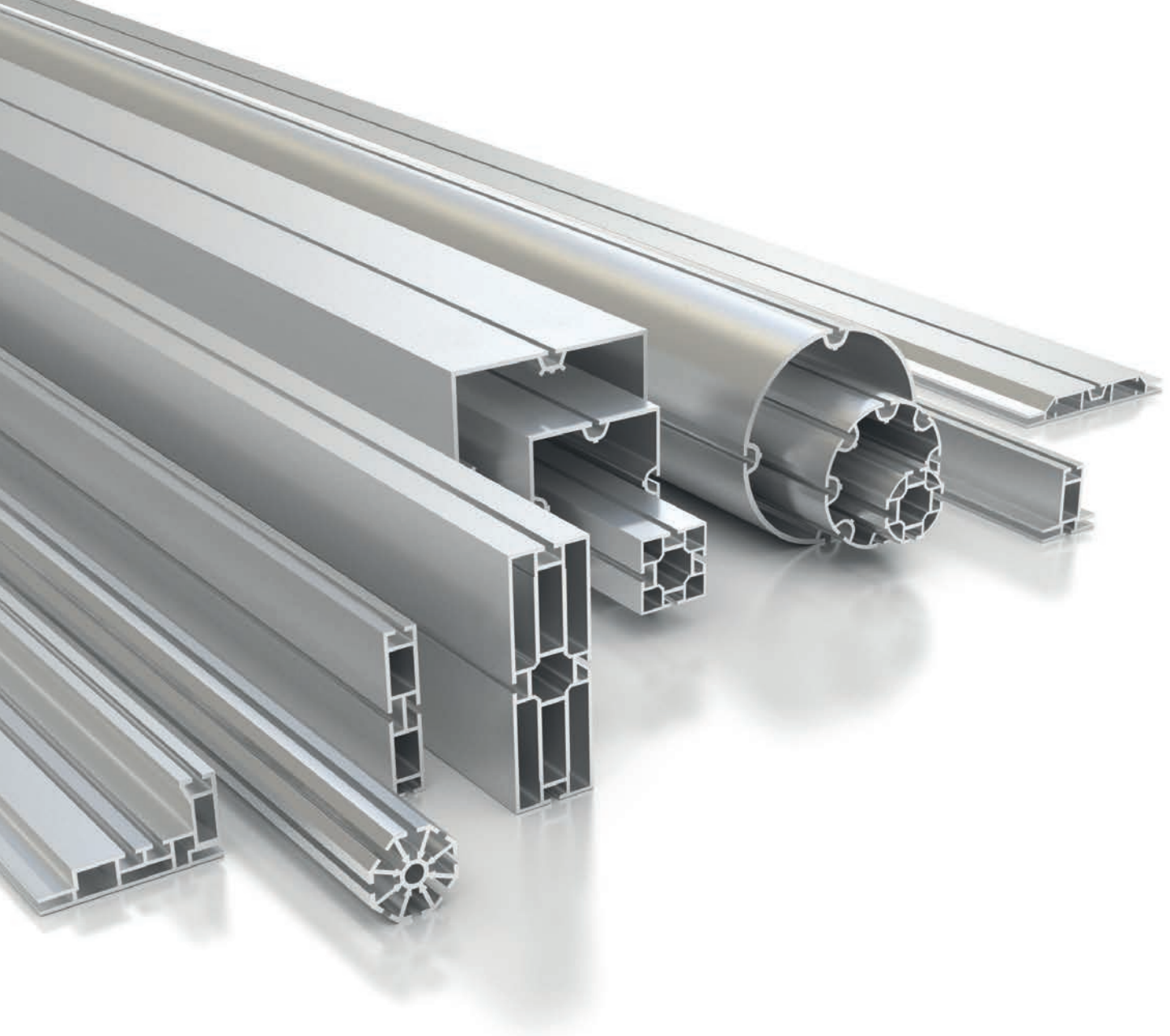

- In dieser Broschüre werden alle Aluminium-Profilquerschnitte, die zum besseren Verständnis nach Form und Funktion unterteilt sind, gezeigt
- Alle Profile sind in ihrer Originalgröße abgebildet, sofern nichts Gegenteiliges angegeben ist
- Die Länge ist standardmäßig 5000 oder 6000 mm, Sonderlängen können bis max. 6930 mm gefertigt werden
- Alle Profile können konfektioniert geliefert werden
- Alle Profile lieferbar in roh, matt eloxiert (E6|EV1), glänzend eloxiert (E4|EV1), schutzeloxiert oder RAL-pulverbeschichtet
- Ein Großteil der abgebildeten Profile ist abhängig von der Nachfrage und der Pulverbeschichtung ab Lager erhältlich
- Die mit * gekennzeichneten Artikel sind nur auf Anfrage mit einer Lieferzeit und Mindestabnahmemenge erhältlich
- Sonderprofilformen nach Ihren Vorgaben sind auf Anfrage möglich

INHALT

ALUMINIUMPROFILE	5
STÜTZEN UND ZARGEN	7
Quadratprofile	9
Rechteckprofile	15
Achteckprofile	27
Dreieckprofile	29
Winkelprofile	31
Scharnierprofile	33
Rundprofile	35
Ovalprofile	37
STOFFBEFESTIGUNG	39
Spannrahmenprofile	41
Stoffhalteprofile	53
PROFILSONDERFORMEN	55
Abdeckprofile	57
Wandaufnahmepprofile	59
Sockelwinkel	61
Sonstige Profile	63
REINRAUMPROFILE	65
Wandprofile	67
Deckenprofile	73
Türprofile	75
KUNSTSTOFFPROFILE	81
INDEX	87



ALU MINI UM



Die OCTANORM-Systeme umfassen ein äußerst umfangreiches Sortiment an Aluminiumprofilen. Die hohe spezifische Festigkeit unserer hochwertigen Aluminiumlegierung macht es zu einem idealen Werkstoff für unsere OCTANORM-Komponenten und garantiert eine jahrzehntelange Wiederverwendbarkeit. Das geringe Gewicht begünstigt kurze Aufbauzeiten und reduziert zudem die Transportkosten und CO₂-Emissionen.

STÜTZEN UND ZARGEN

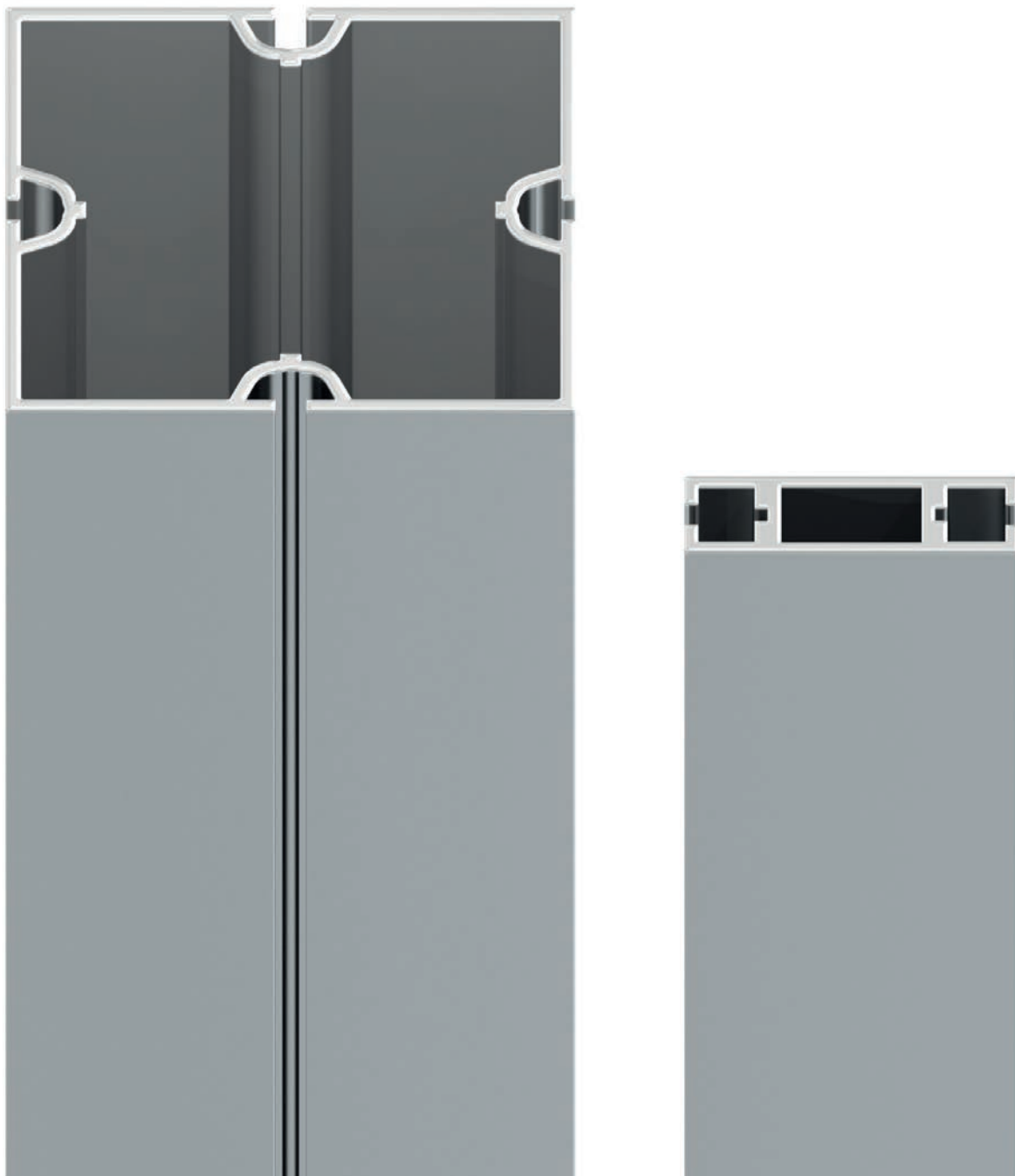

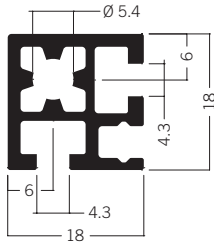

M 1618 Quadratprofil 18 mm
1.99 kg | 5000 mm

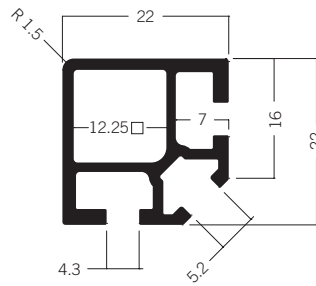

M 1625 Quadratprofil 22 mm
2.15 kg | 5000 mm

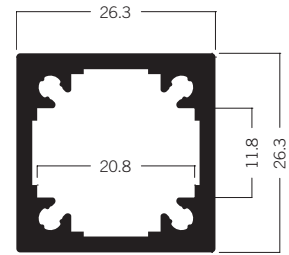

M 1400 Quadratprofil 26.3 mm
2.17 kg | 5000 mm

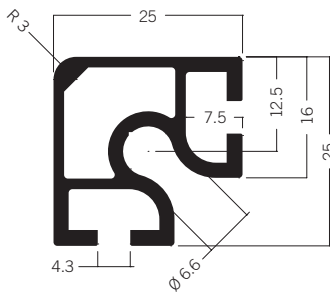

V 2000 Quadratprofil 25 mm
2.89 kg | 5000 mm

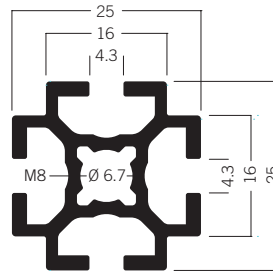

S 10* Quadratprofil 25 mm
3.08 kg | 5000 mm

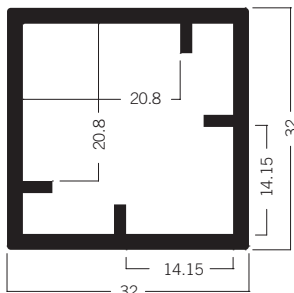

S 1123 Quadratprofil 32 mm
3.77 kg | 5000 mm

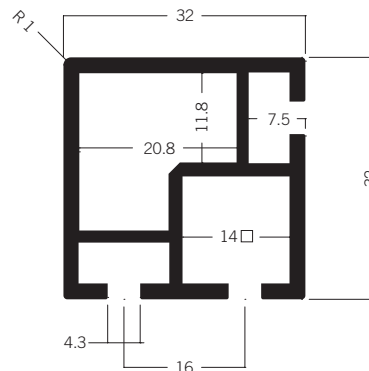

S 1125 Quadratprofil 32 mm
4.03 kg | 5000 mm

STÜTZEN UND ZARGEN

Quadratprofile

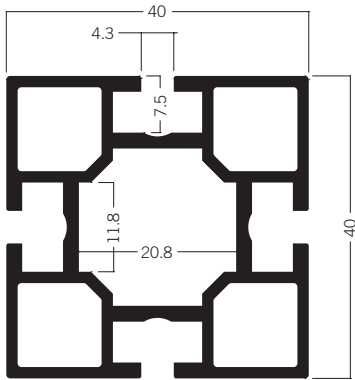

M 1000 Quadratprofil 40 mm
5.78 kg | 5000 mm

M 1001 Quadratprofil 40 mm
6.97 kg | 6000 mm

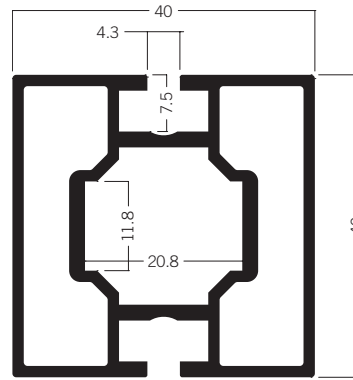

M 1002 Quadratprofil 40 mm
5.55 kg | 5000 mm

M 1003 Quadratprofil 40 mm
6.92 kg | 6000 mm

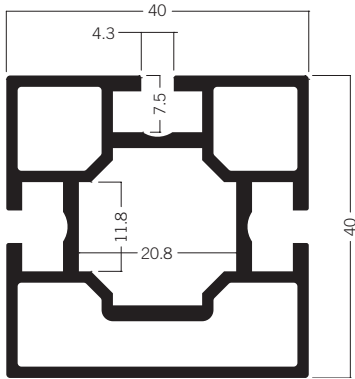

M 1005 Quadratprofil 40 mm
6.66 kg | 6000 mm

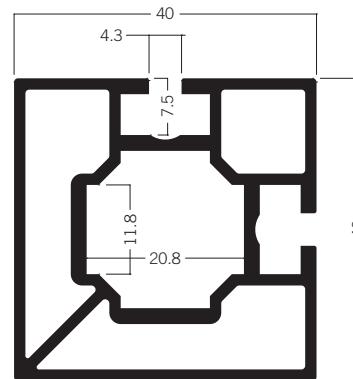

M 1007 Quadratprofil 40 mm
7.17 kg | 6000 mm

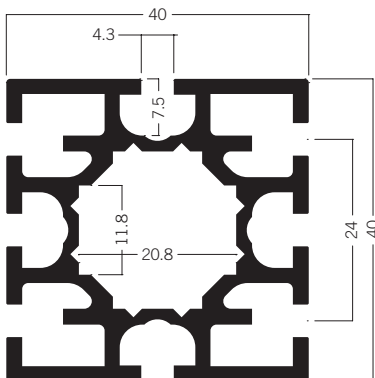

S 209 Quadratprofil 40 mm
8.05 kg | 6000 mm

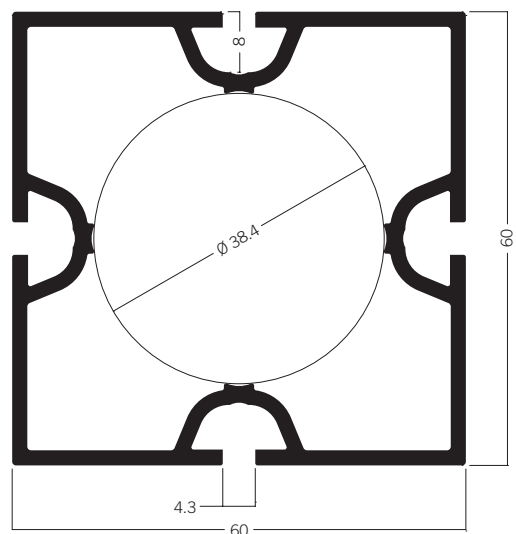

M 1010 Quadratprofil 60 mm
8.13 kg | 5000 mm

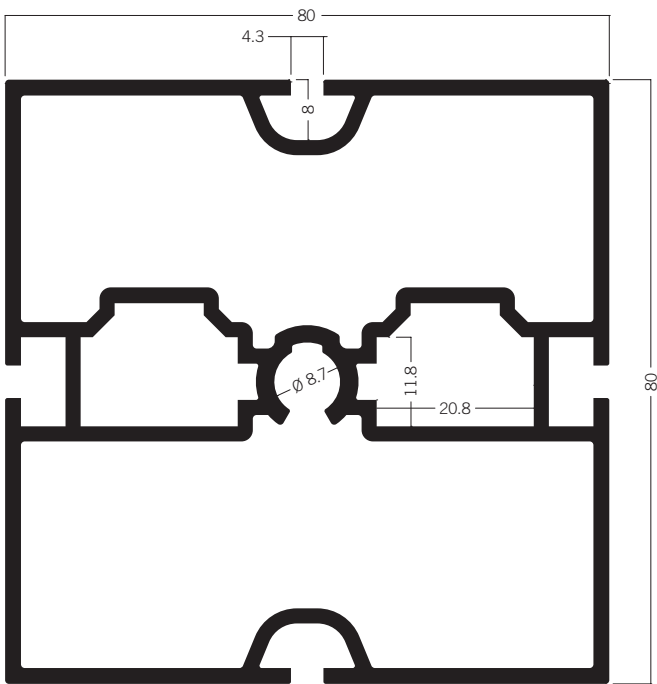

M 1018 Quadratprofil 80 mm
14.91 kg | 5000 mm

M 1019 Quadratprofil 80 mm
17.80 kg | 6000 mm

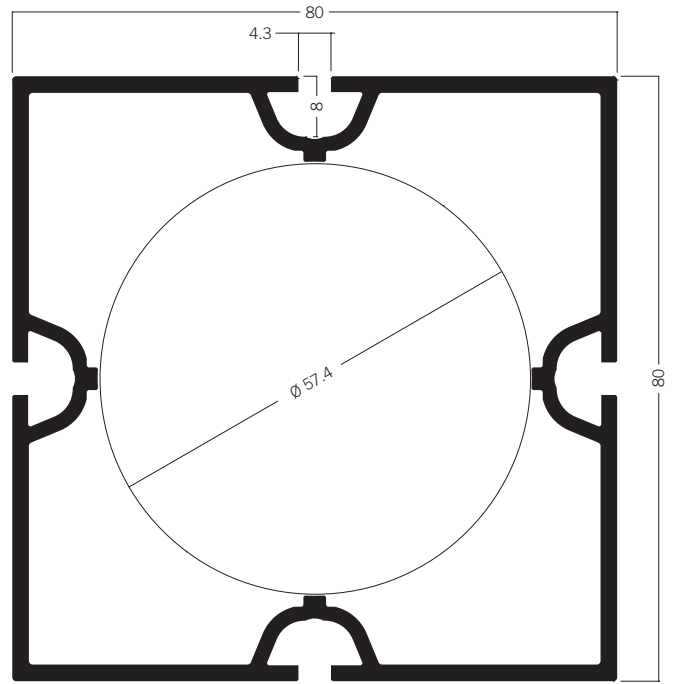

M 1020 Quadratprofil 80 mm
11.51 kg | 5000 mm

M 1021 Quadratprofil 80 mm
12.89 kg | 6000 mm

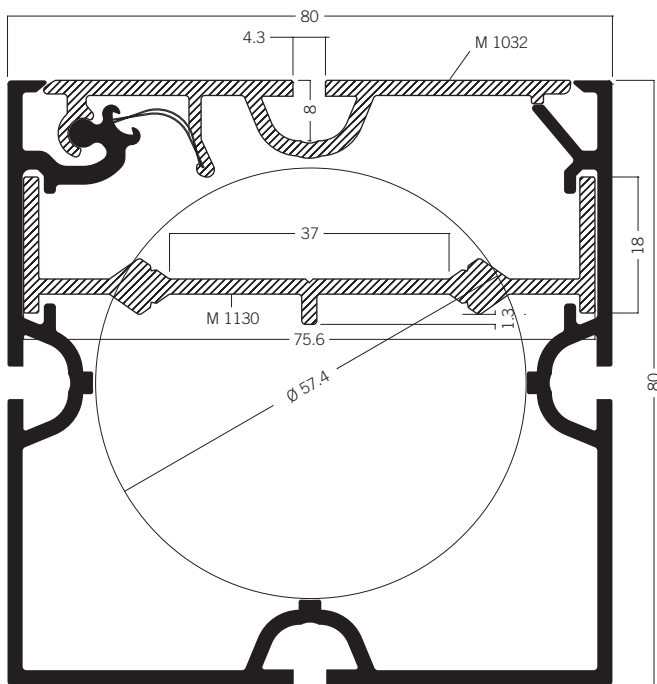

M 1022* Quadratprofil 80 mm
15.66 kg | 5000 mm

M 1023 Quadratprofil 80 mm
17.24 kg | 6000 mm

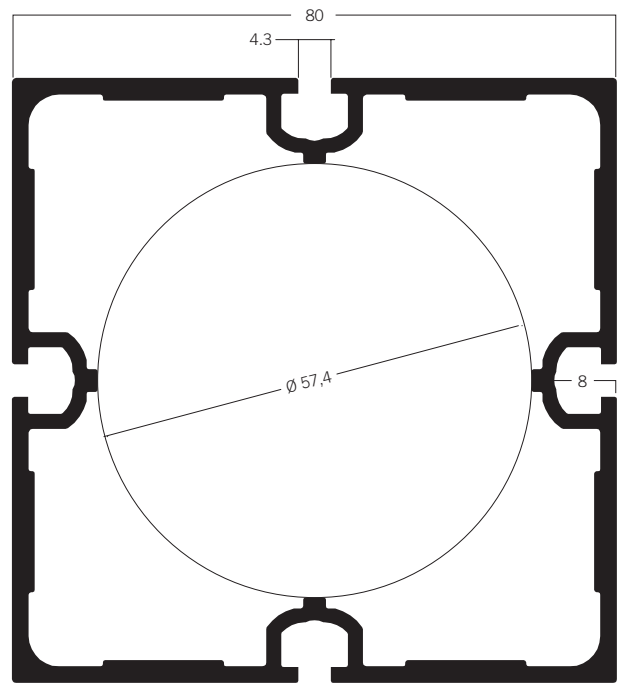

U 1020 Quadratprofil 80 mm
15.50 kg | 6000 mm

STÜTZEN UND ZARGEN

Quadratprofile

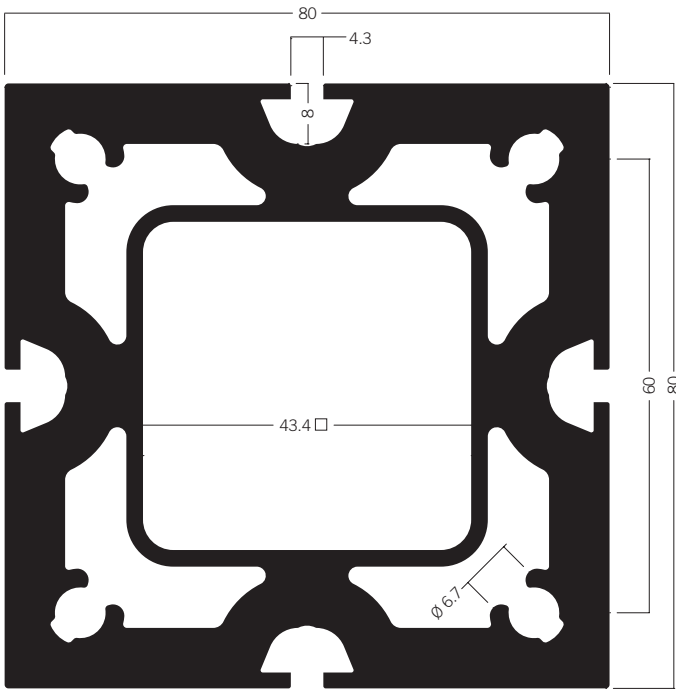

DFS 84 Stützenprofil 80 mm
38.95 kg | 5040 mm

DFS 84/6000 Stützenprofil 80 mm
46.28 kg | 6000 mm

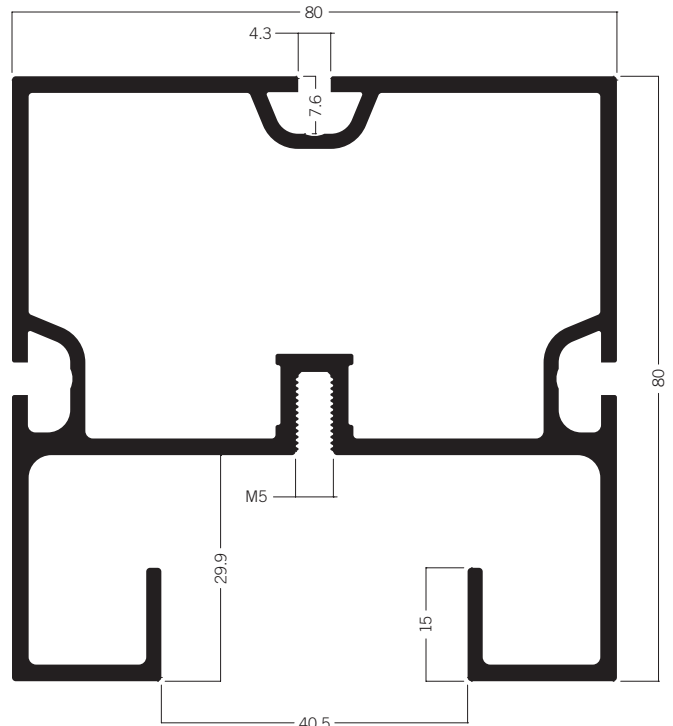

M 1059 Stromschienehalterprofil 80 mm
15.92 kg | 6000 mm

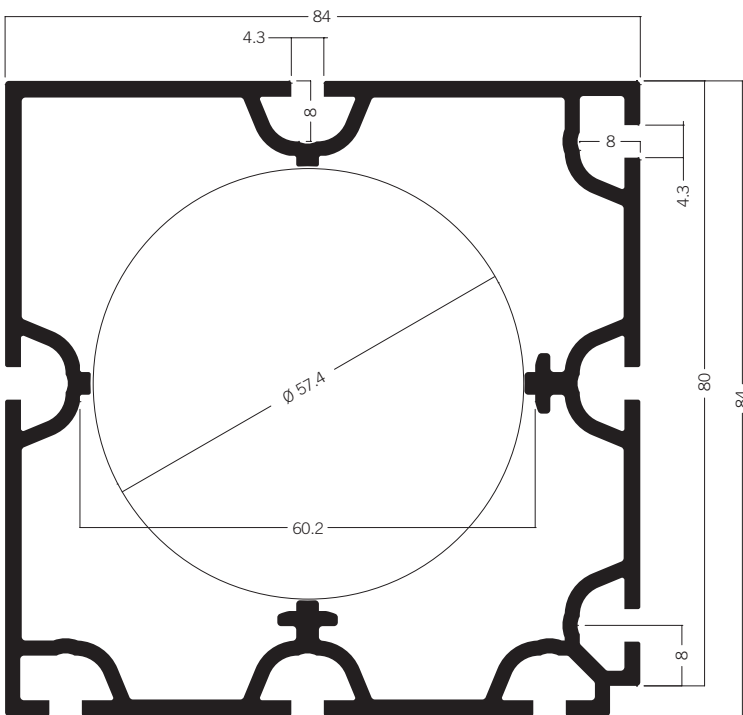

M 1017 Quadratprofil 84 mm
12.05 kg | 5000 mm

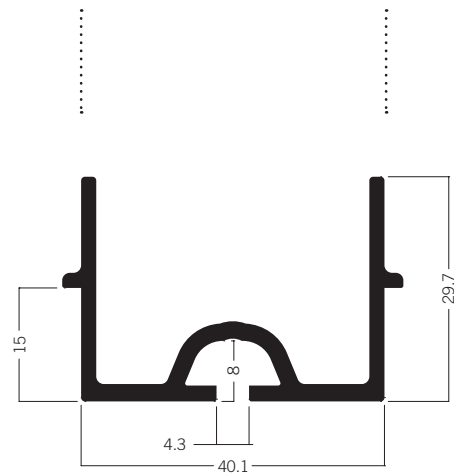

M 1155 Abdeckprofil für M 1059
3.46 kg | 5000 mm

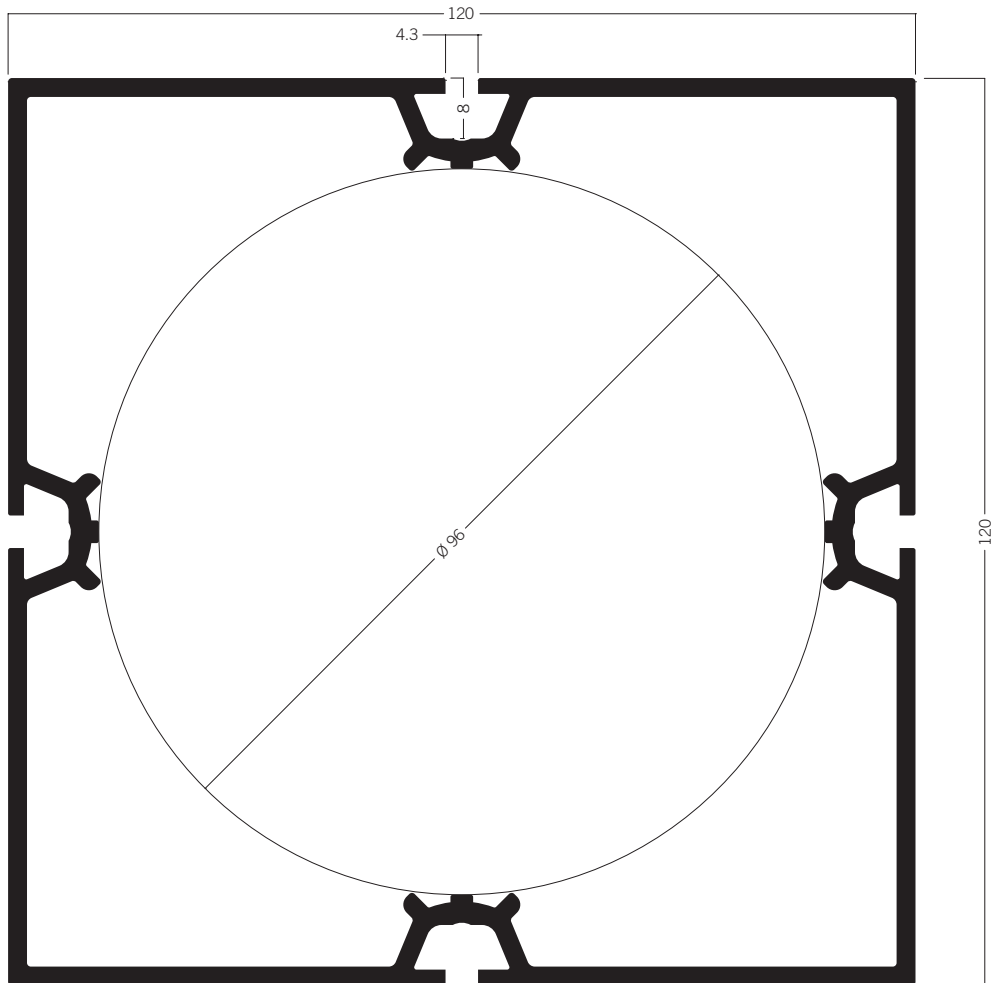

M 225 Quadratprofil 120 mm
19.81 kg | 5000 mm

M 226 Quadratprofil 120 mm
22.71 kg | 6000 mm

STÜTZEN UND ZARGEN

Quadratprofile

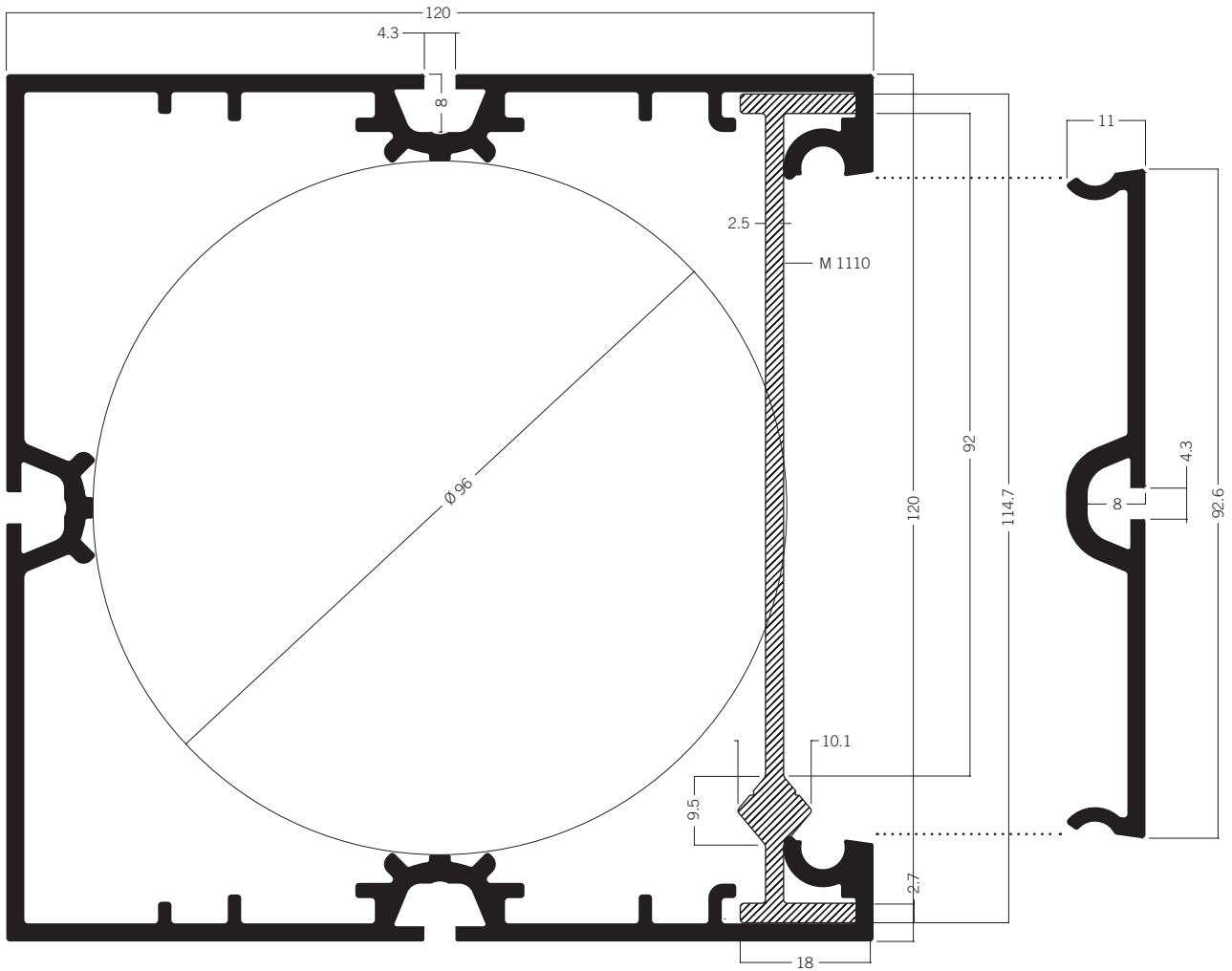

M 1041 Quadratprofil offen 120 mm
21.85 kg | 6000 mm

M 1046 Abdeckprofil
5.30 kg | 6000 mm

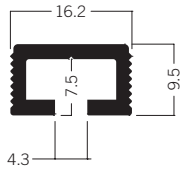

W 416 Einlassprofil
1.05 kg | 5000 mm

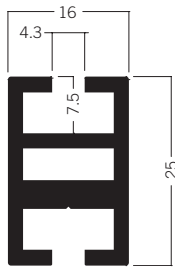

M 1602 Zargenprofil 25 mm
2.72 kg | 5000 mm

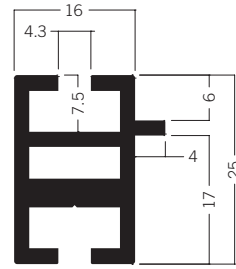

M 1603* Zargenprofil 25 mm
2.74 kg | 5000 mm

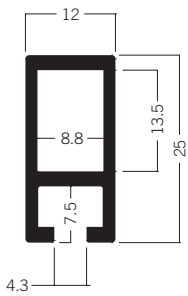

Z 305 Zargenprofil 25 mm
1.72 kg | 5000 mm

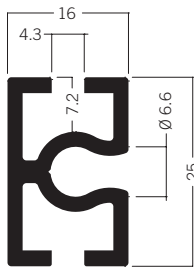

V 2040 Stützenprofil 25 mm
2.41 kg | 5000 mm

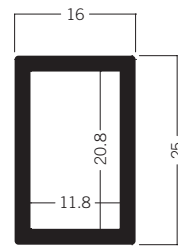

Z 300 Zargenprofil 25 mm
2.05 kg | 5000 mm

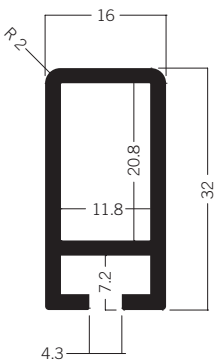

Z 303 Zargenprofil 32 mm
2.70 kg | 5000 mm

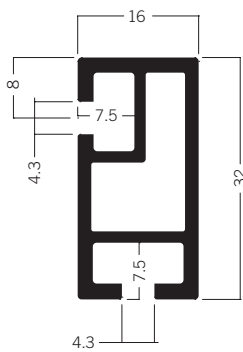

Z 307 Zargenprofil 32 mm
2.53 kg | 5000 mm

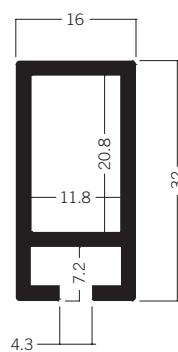

Z 308 Zargenprofil 32 mm
2.68 kg | 5000 mm

STÜTZEN UND ZARGEN

Rechteckprofile

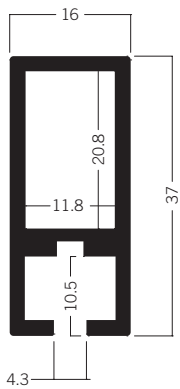

Z 310 Zargenprofil 37 mm
2.96 kg | 5000 mm

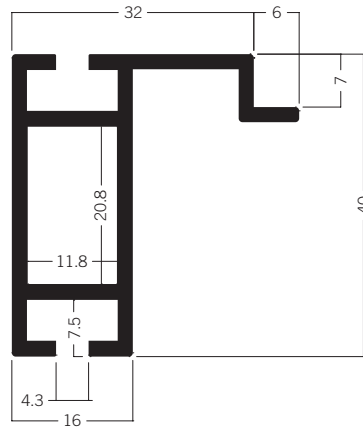

Z 4100 Zargenprofil 40 mm
4.14 kg | 5000 mm

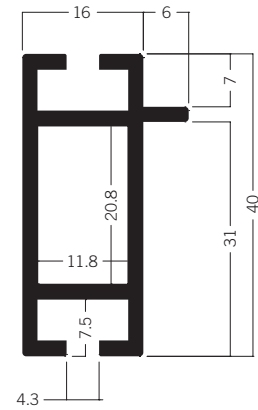

Z 4300 Zargenprofil 40 mm
3.54 kg | 5000 mm

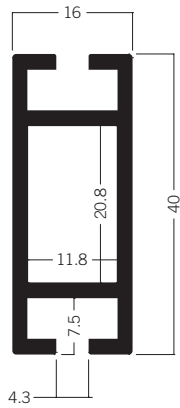

Z 4400 Zargenprofil 40 mm
3.20 kg | 5000 mm

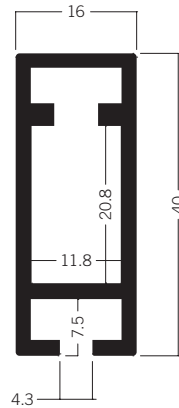

Z 4401 Zargenprofil 40 mm
3.38 kg | 5000 mm

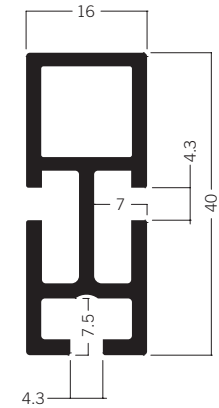

Z 4700 Rechteckprofil 40 mm
3.49 kg | 5000 mm



Z 100 Zargenprofil 43 mm
3.14 kg | 5000 mm

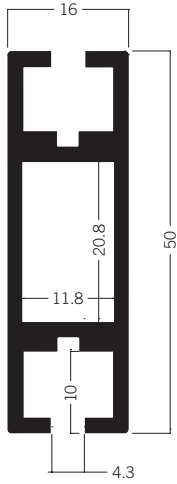

Z 400 Zargenprofil 50 mm
4.39 kg | 5000 mm

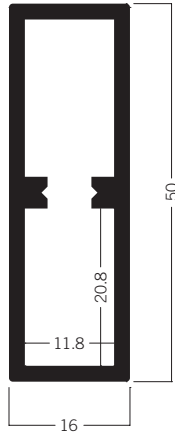

Z 402 Zargenprofil 50 mm
3.76 kg | 5000 mm

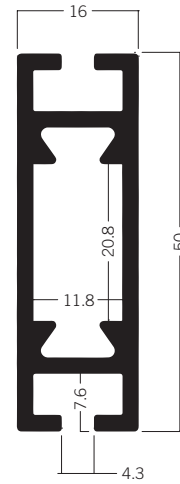

Z 408* Zargenprofil 50 mm
4.39 kg | 5000 mm

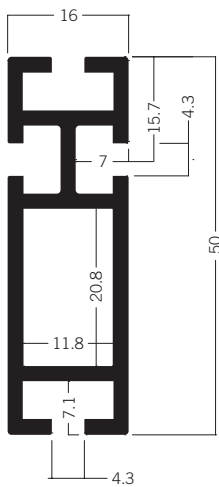

Z 460 Zargenprofil 50 mm
3.96 kg | 5000 mm

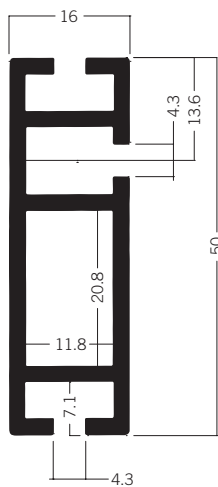

Z 464* Zargenprofil 50 mm
4.11 kg | 5000 mm

STÜTZEN UND ZARGEN

Rechteckprofile

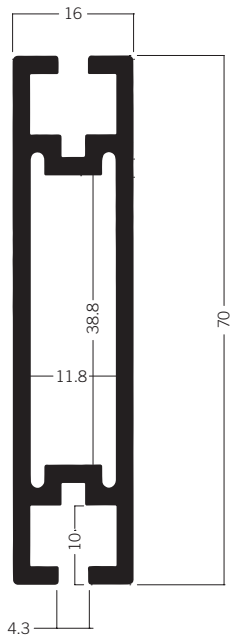

Z 110 Zargenprofil 70 mm
5.42 kg | 5000 mm

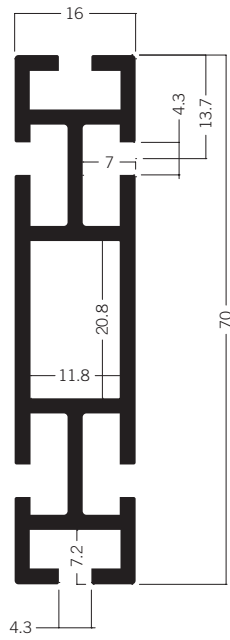

Z 160 Zargenprofil 70 mm
5.43 kg | 5000 mm

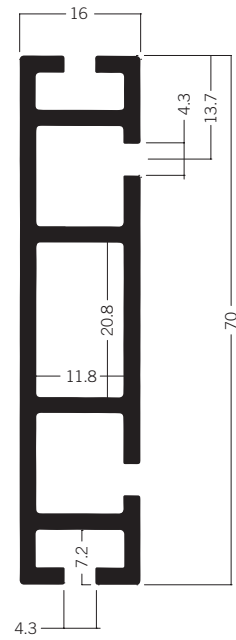

Z 164* Zargenprofil 70 mm
5.85 kg | 5000 mm

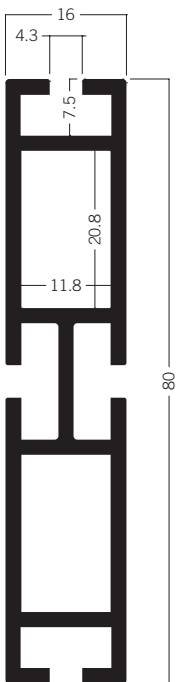

M 1320 Zargenprofil 80 mm
6.45 kg | 5000 mm

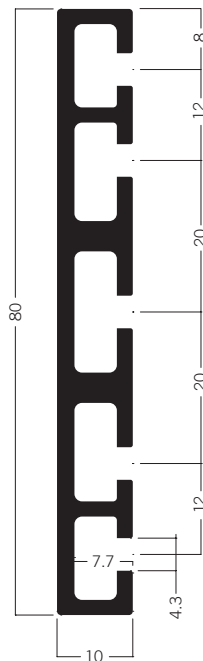

M 1063 Anschlussprofil 80 mm
5.46 kg | 5000 mm

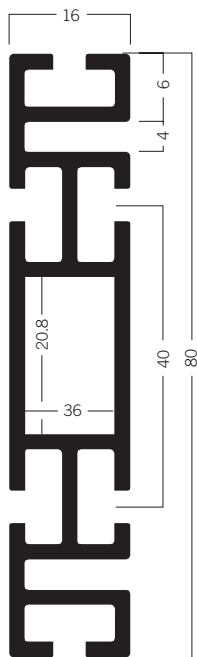

U 1066 Spannrahmendistanzprofil 80 × 16 mm
8.25 kg | 6000 mm



U 1030* Zargenprofil 120 mm
9.51 kg | 6000 mm

STÜTZEN UND ZARGEN

Rechteckprofile

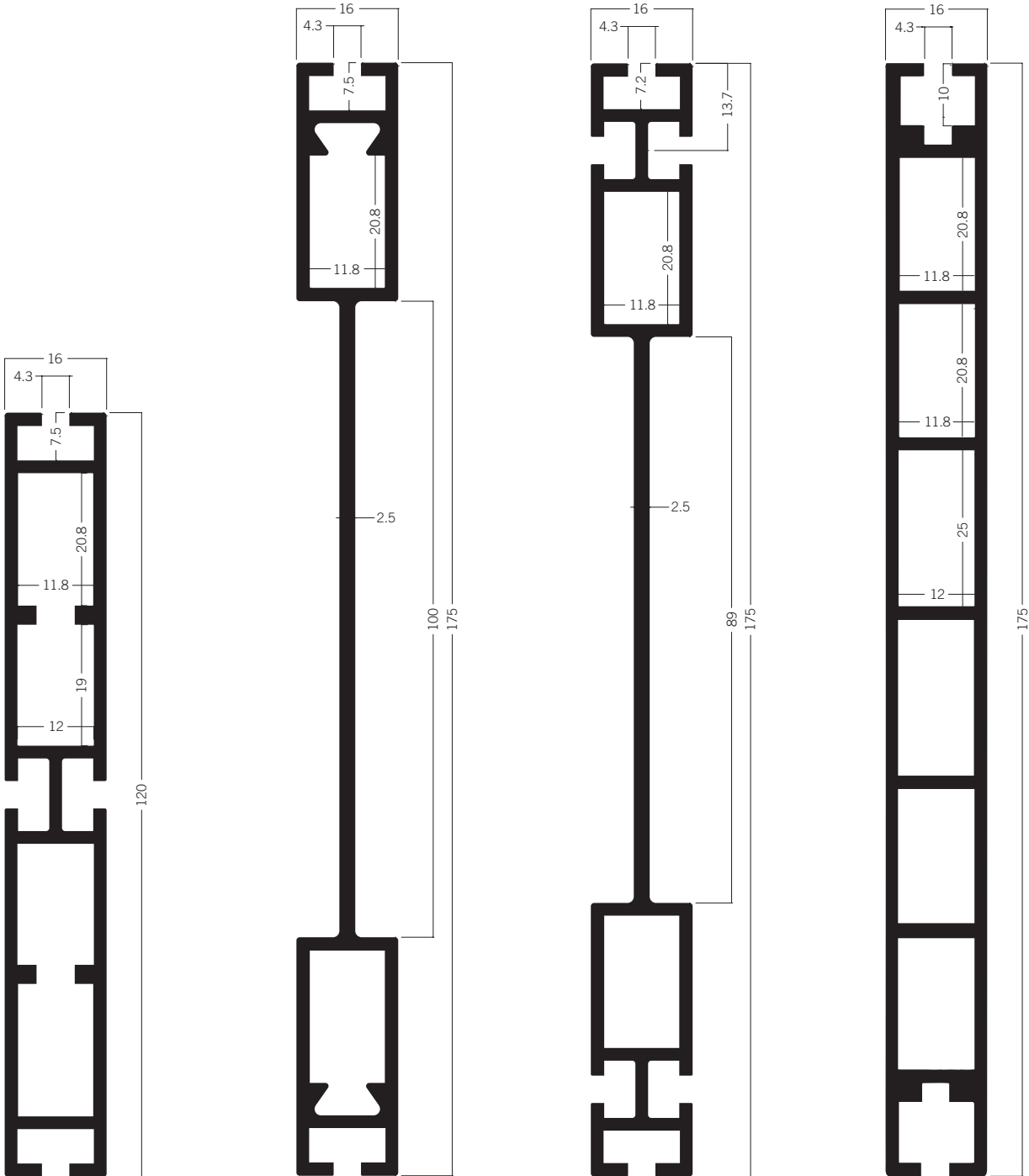

M 1340 Zargenprofil 120 mm
9.00 kg | 5000 mm

Z 508 Zargenprofil 175 mm
9.95 kg | 5000 mm

Z 560 Zargenprofil 175 mm
10.32 kg | 5000 mm

Z 600 Zargenprofil 175 mm
13.53 kg | 5000 mm

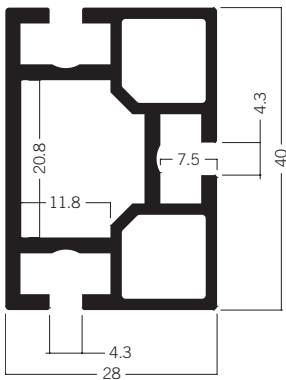

M 1069 Rechteckprofil 40 mm
5.71 kg | 6000 mm

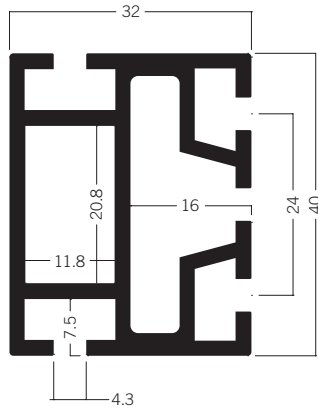

Z 2100 Zargenprofil 40 mm
5.99 kg | 5000 mm

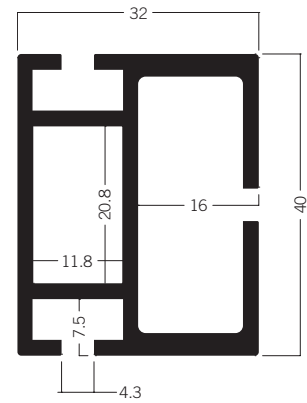

Z 2105 Zargenprofil 40 mm
5.56 kg | 5000 mm

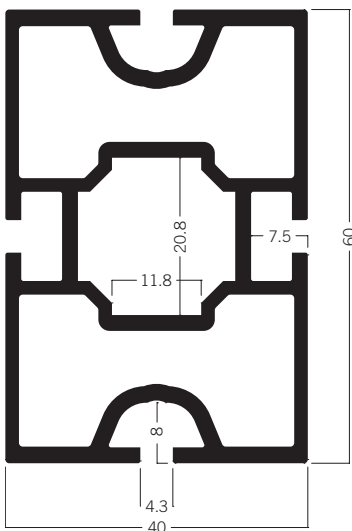

M 1081 Rechteckprofil 60 mm
8.94 kg | 5000 mm

M 1082 Rechteckprofil 60 mm
10.73 kg | 6000 mm

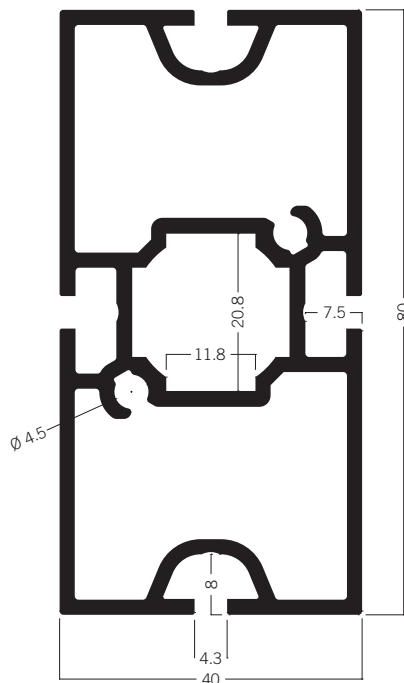

M 1025 Rechteckprofil 80 mm
10.22 kg | 5000 mm

M 1026 Rechteckprofil 80 mm
12.70 kg | 6000 mm

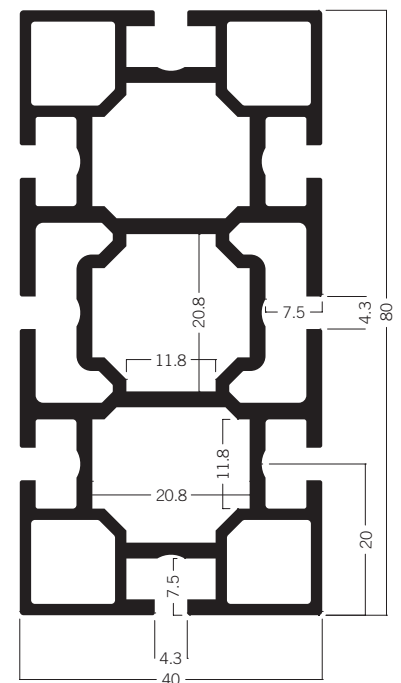

M 1092 Rechteckprofil 80 mm
14.60 kg | 6000 mm

Rechteckprofile

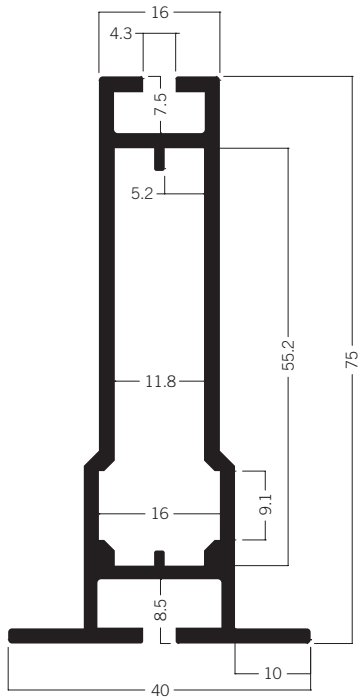

W 901* Rahmenprofil 40 mm Paneel
7.51 kg l 6000 mm

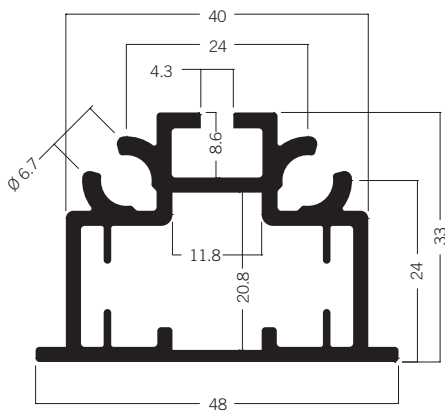

S 1610* Rahmenprofil 48 mm
6.48 kg l 6000 mm

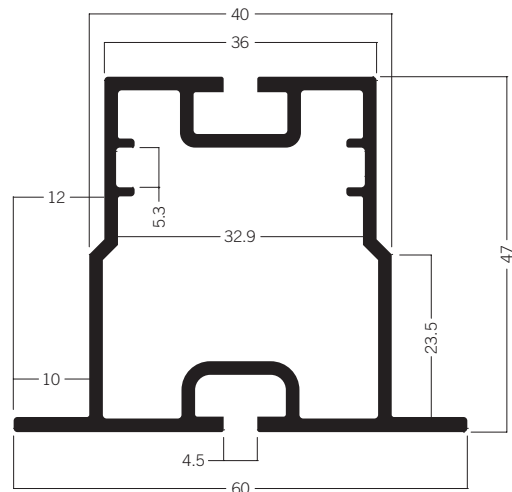

W 825* Rahmenprofil 60 mm Paneel (USA)
7.20 kg l 5000 mm

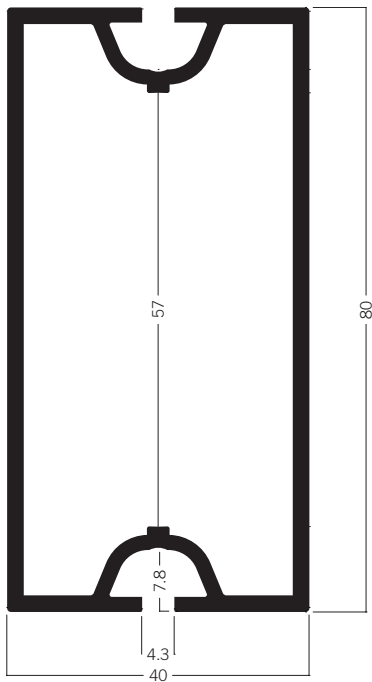

M 1043* Rechteckprofil 80 mm
5.61 kg | 5000 mm

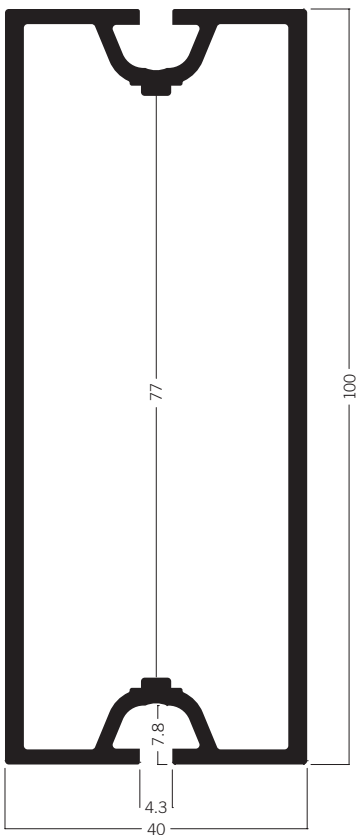

M 1029 Rechteckprofil 100 mm
11.88 kg | 6000 mm

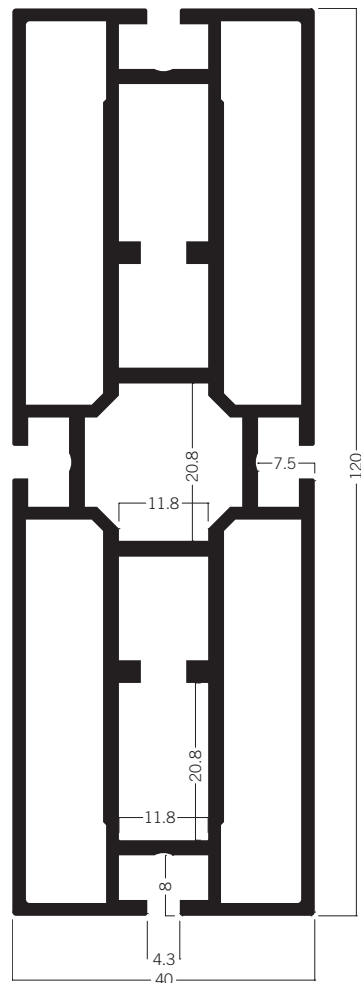

M 1031 Rechteckprofil 120 mm
18.07 kg | 6000 mm

STÜTZEN UND ZARGEN

Rechteckprofile

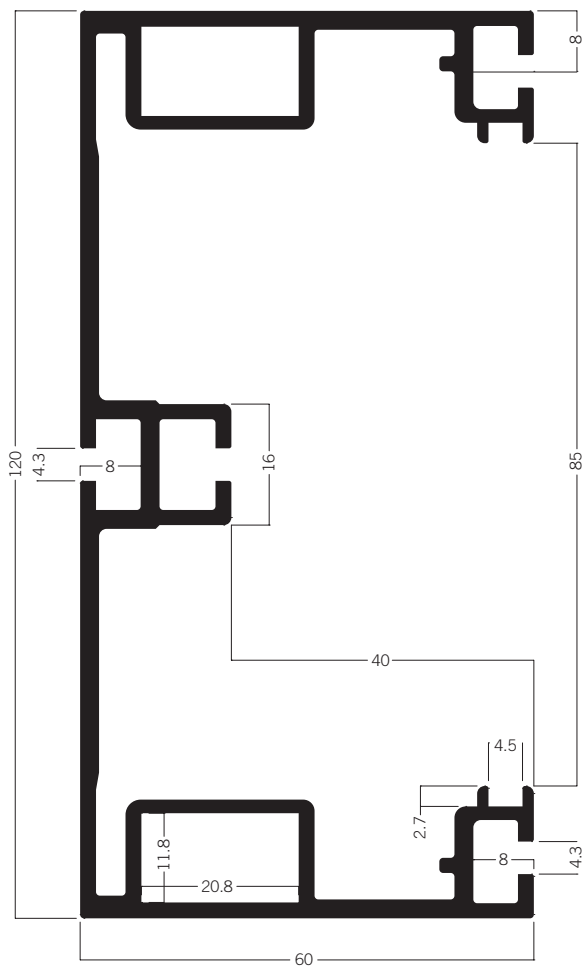

M 1060* Rechteckprofil offen 120 x 60 mm
5.61 kg | 5000 mm

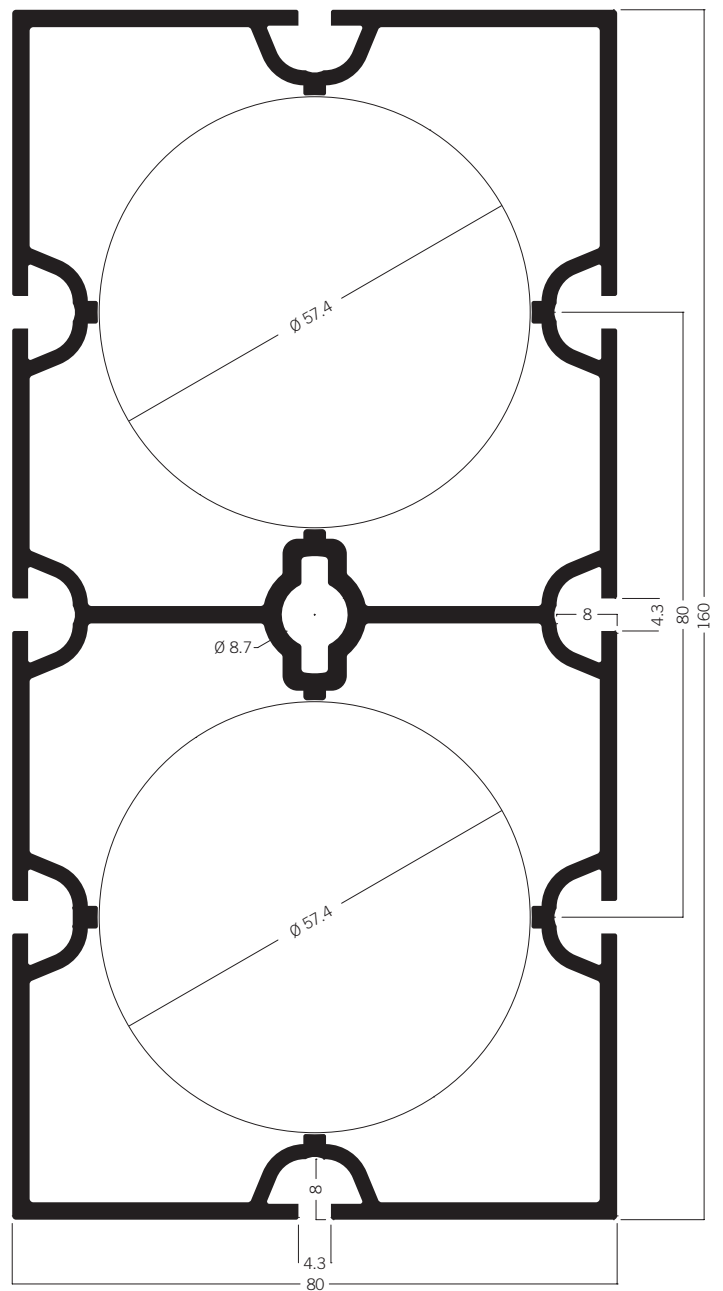

M 1052 Rechteckprofil 160 mm
28.35 kg | 6930 mm

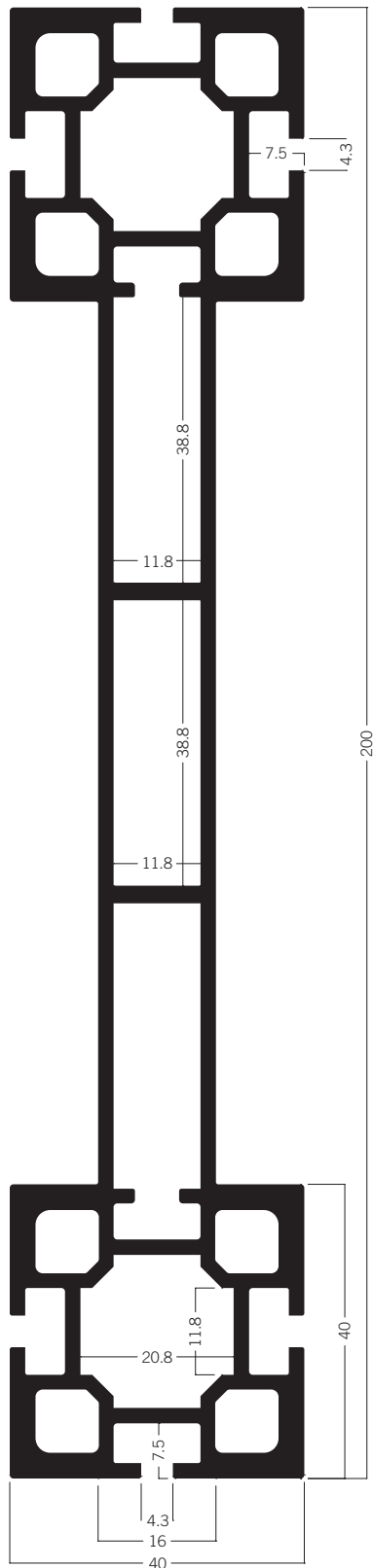

M 770 Trägerprofil 200 mm
35.53 kg | 7000 mm

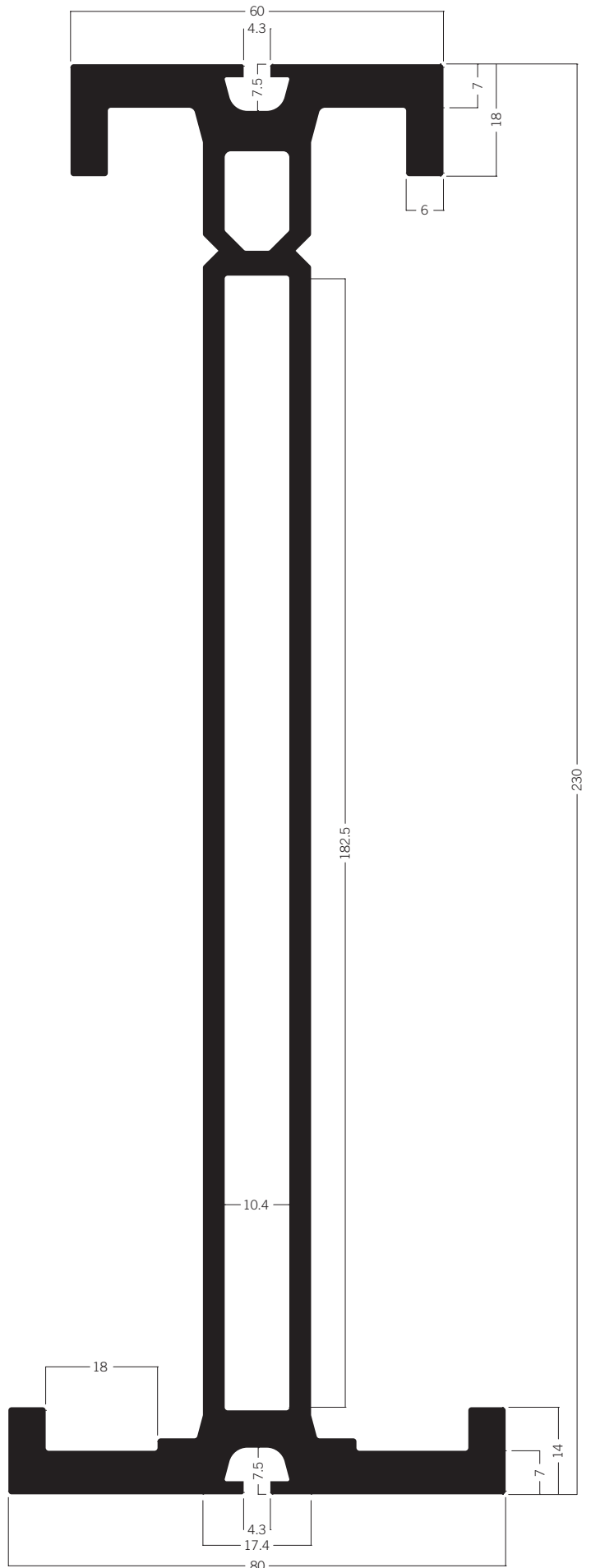

DFL 230 Trägerprofil 230 mm
53.24 kg | 7000 mm

Rechteckprofile

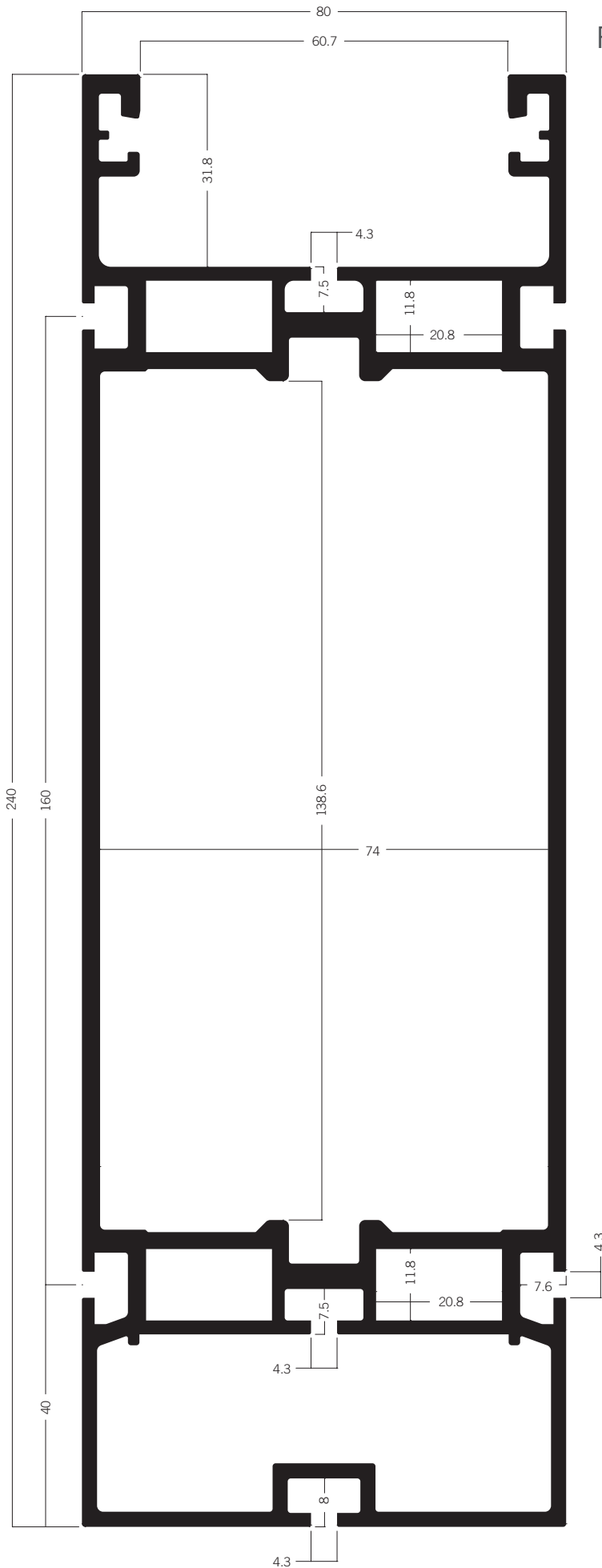

R 102 Rechteckträgerprofil 240 mm
53.23 kg | 6930 mm

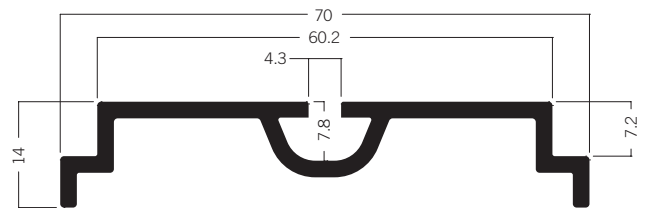

R 122 Abdeckprofil 70 mm für R 102
2.88 kg | 6930 mm

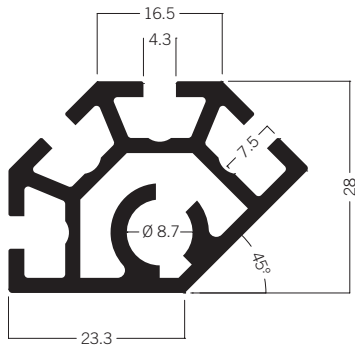

S 203 Stützenprofil 135°
4.87 kg | 5000 mm

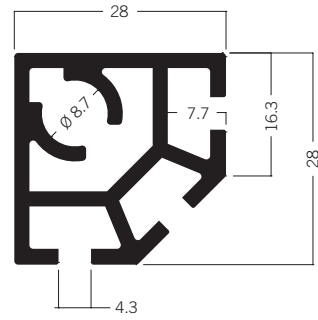

S 308 Stützenprofil 28 m
4.14 kg | 5000 mm

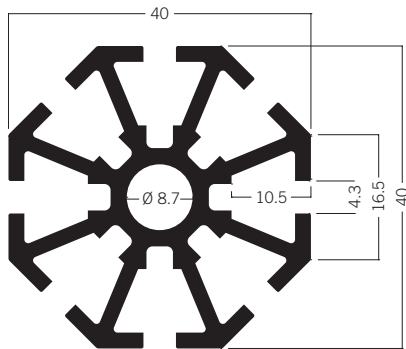

S 100 Stützenprofil 40 mm
6.80 kg | 5000 mm

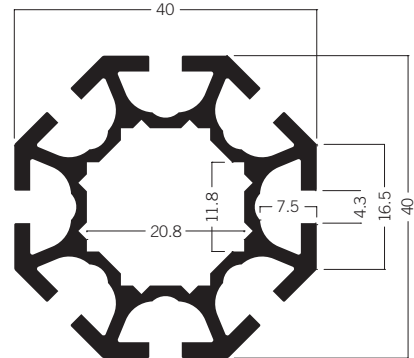

S 108 Stützenprofil 40 mm
5.35 kg | 5000 mm

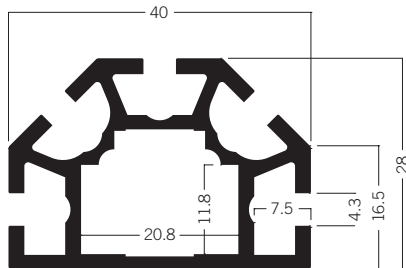

S 201 Stützenprofil 40 mm
4.25 kg | 5000 mm

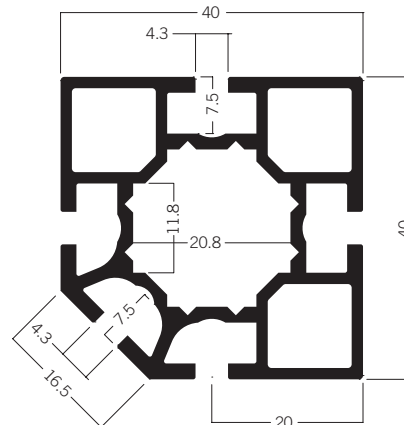

S 380 Stützenprofil 40 mm
5.97 kg | 5000 mm

Achteckprofile

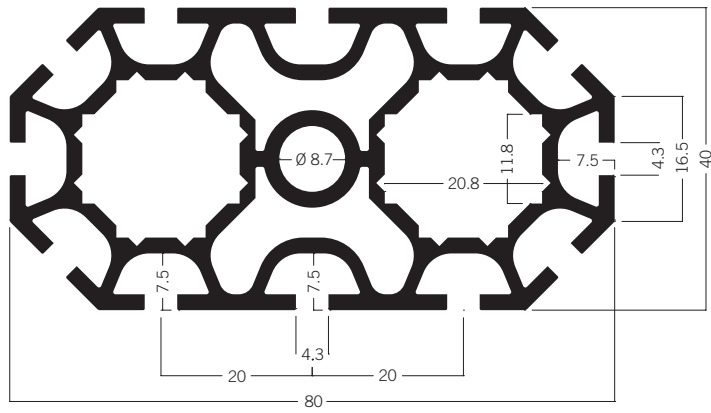

S 408 Stützenprofil 80 mm
12.64 kg | 5000 mm

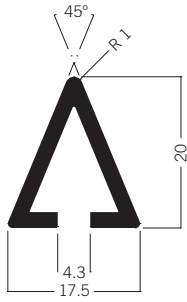

S 206 Inneneckprofil 45°
1.41 kg | 5000 mm

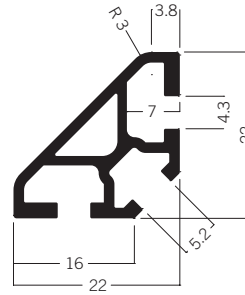

M 1622 Dreieckprofil 22 mm
1.77 kg | 5000 mm

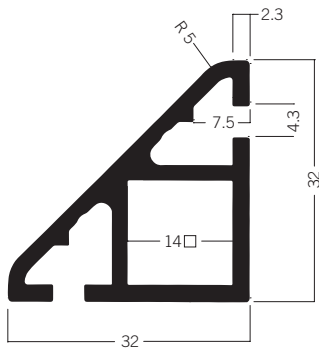

S 1302* Dreieckprofil 32 mm
3.20 kg | 5000 mm

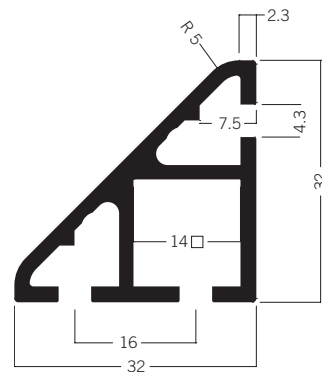

S 1303 Dreieckprofil 32 mm
3.19 kg | 5000 mm

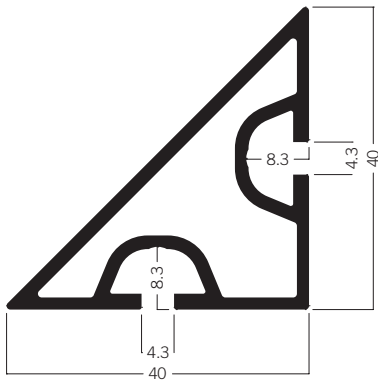

M 1072 Dreieckprofil 40 mm
4.85 kg | 6000 mm

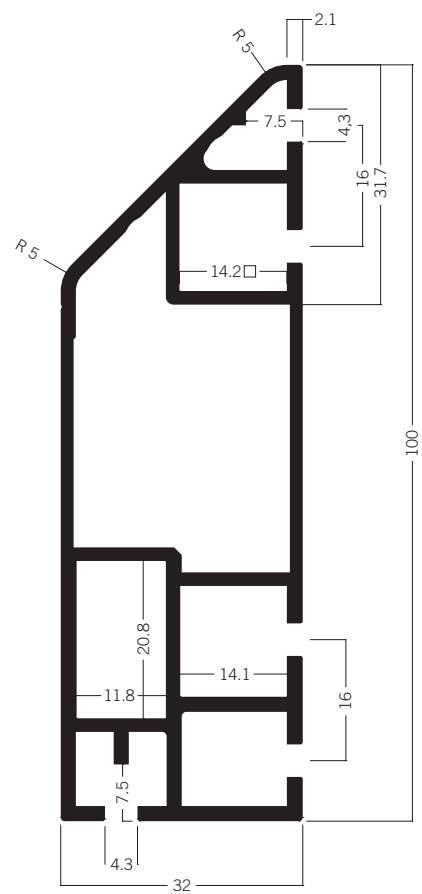

S 1310 Dreieckprofil 100 mm
9.28 kg | 5000 mm

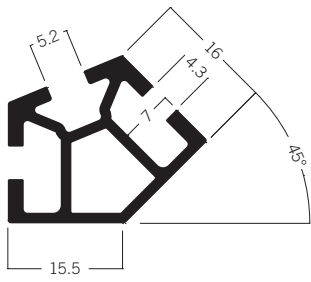

M 1629 Winkelprofil 135°
2.15 kg | 5000 mm

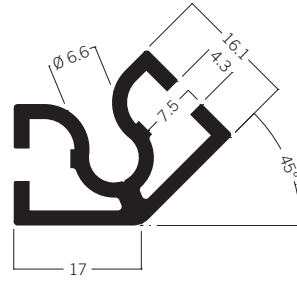

V 2020* Winkelprofil 135°
2.63 kg | 5000 mm

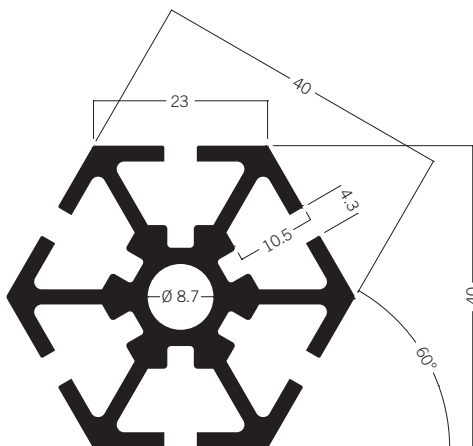

S 500 Stützenprofil 60°
6.98 kg | 5000 mm

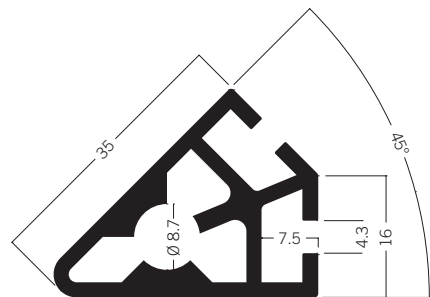

S 302 Stützenprofil 45°
4.03 kg | 5000 mm

Winkelprofile

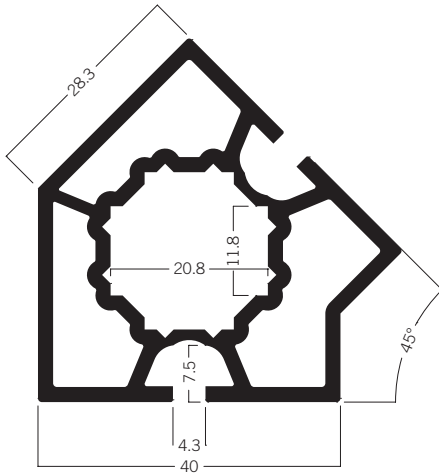

M 1009 Winkelprofil 135°
7.82 kg | 6000 mm

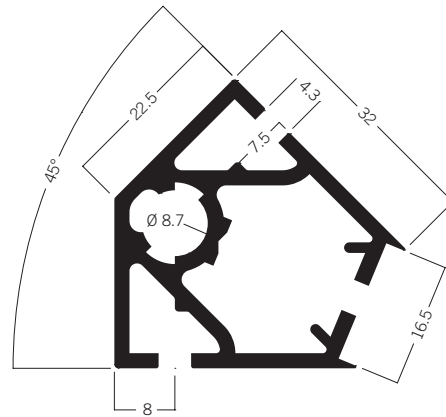

S 1129 Winkelprofil 135°
4.74 kg | 5000 mm

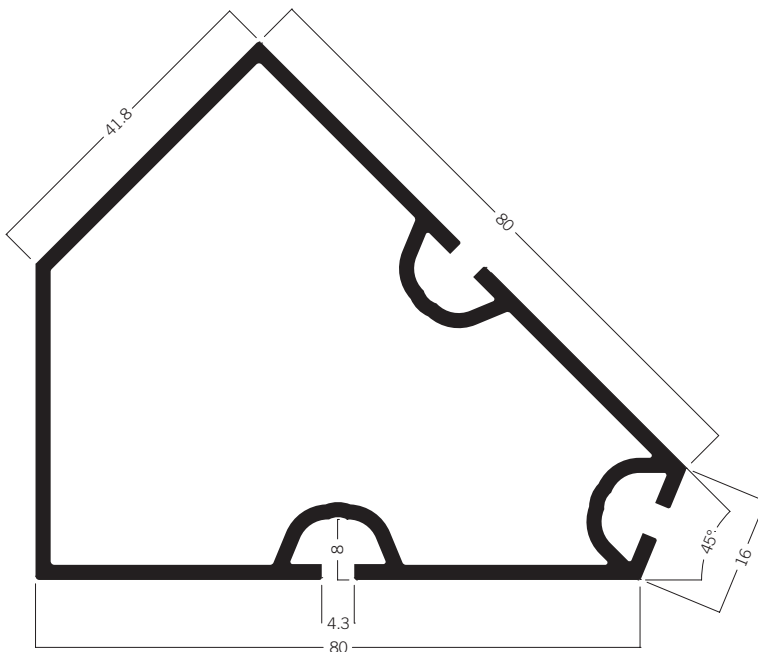

M 1070 Winkelprofil 135°
8.38 kg | 5000 mm

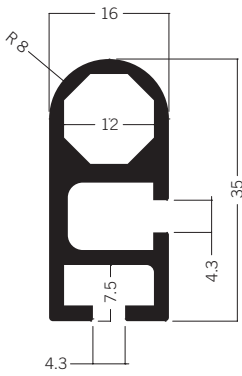

S 250 Gelenkprofil 35 mm
3.14 kg | 5000 mm

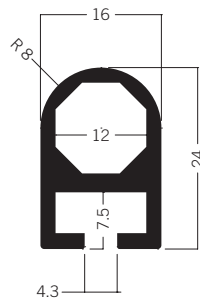

S 251 Gelenkprofil 24 mm
2.24 kg | 5000 mm

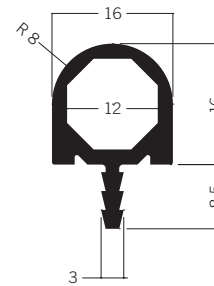

S 252 Gelenkprofil 16 mm
1.73 kg | 5000 mm

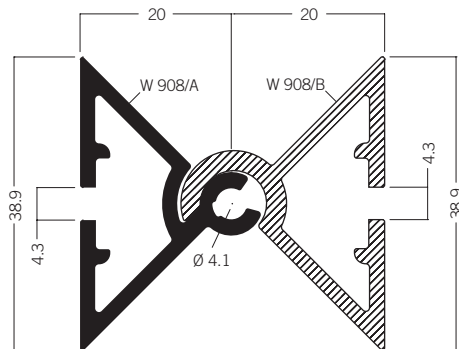

W 908 Scharnierprofil
5.60 kg | 5000 mm

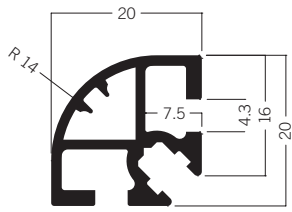

M 1600* Viertelkreisprofil 20 mm
2.00 kg | 5000 mm

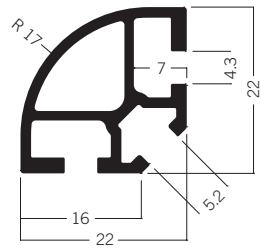

M 1620 Viertelkreisprofil 22 mm
1.80 kg | 5000 mm

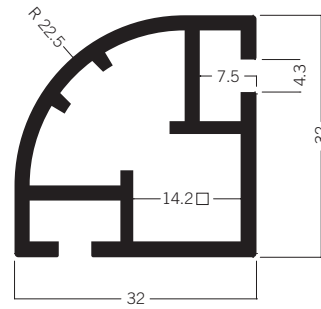

S 1100 Viertelkreisprofil 32 mm
4.06 kg | 5000 mm

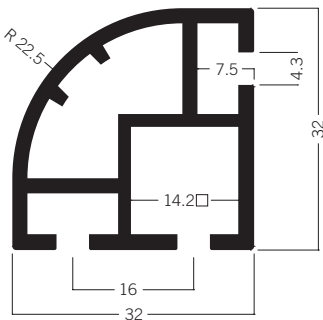

S 1105 Viertelkreisprofil 32 mm
4.02 kg | 5000 mm

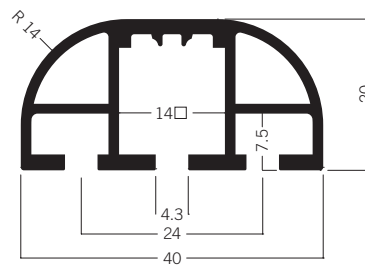

M 1606 Halbkreisprofil 40 mm
3.04 kg | 5000 mm

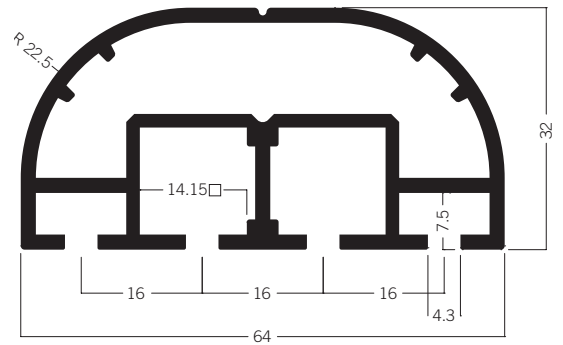

S 1106 Halbkreisprofil 64 mm
6.98 kg | 5000 mm

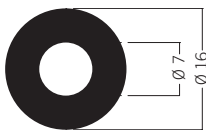

M 1460 Rundprofil 16 mm
2.57 kg | 6000 mm

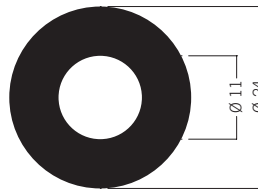

M 1140 Rundprofil 24 mm
4.69 kg | 5000 mm

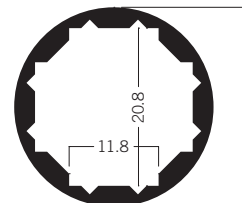

M 1208 Rundprofil 26.3 mm
2.17 kg | 5000 mm

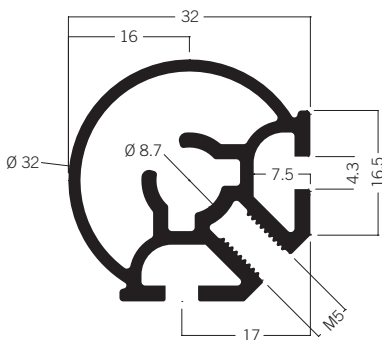

S 1200 Viertelkreisprofil 32 mm
3.78 kg | 5000 mm

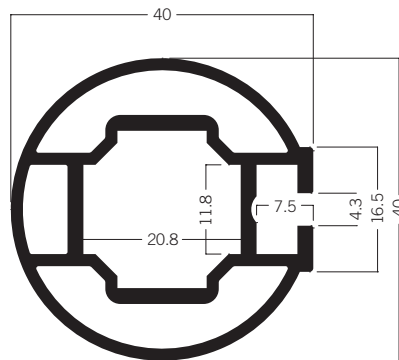

M 1201* Rundprofil 40 mm
5.25 kg | 5000 mm

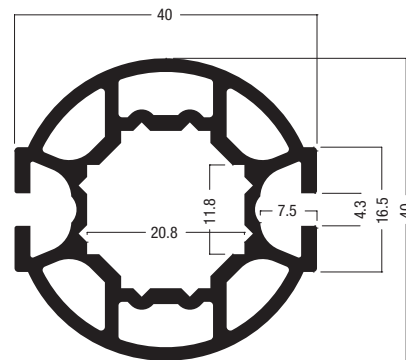

M 1202 Rundprofil 40 mm
6.10 kg | 5000 mm

STÜTZEN UND ZARGEN

Rundprofile

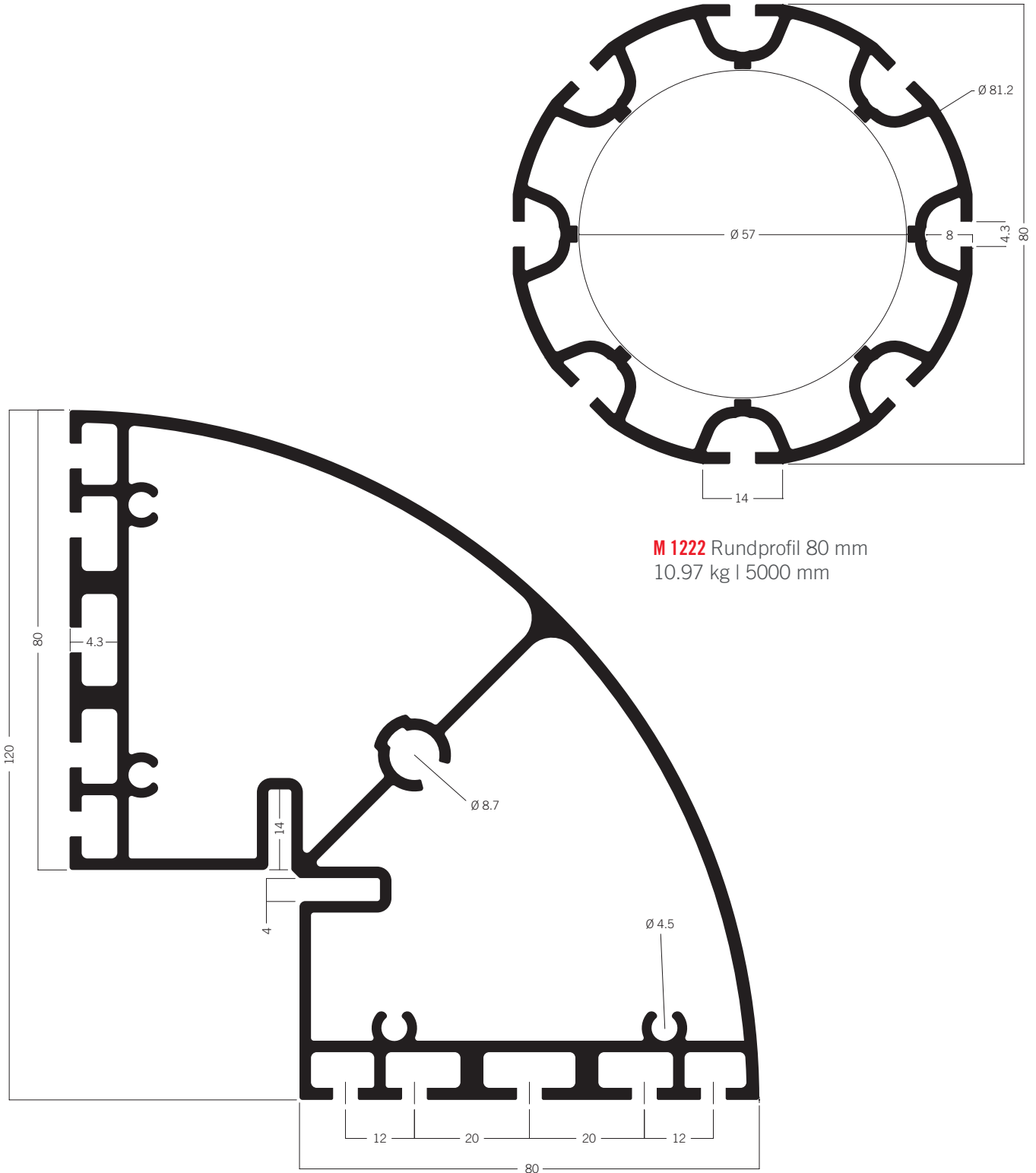

M 1222 Rundprofil 80 mm
10.97 kg | 5000 mm

M 260 Eckstützenprofil 90°
25.50 kg | 6060 mm

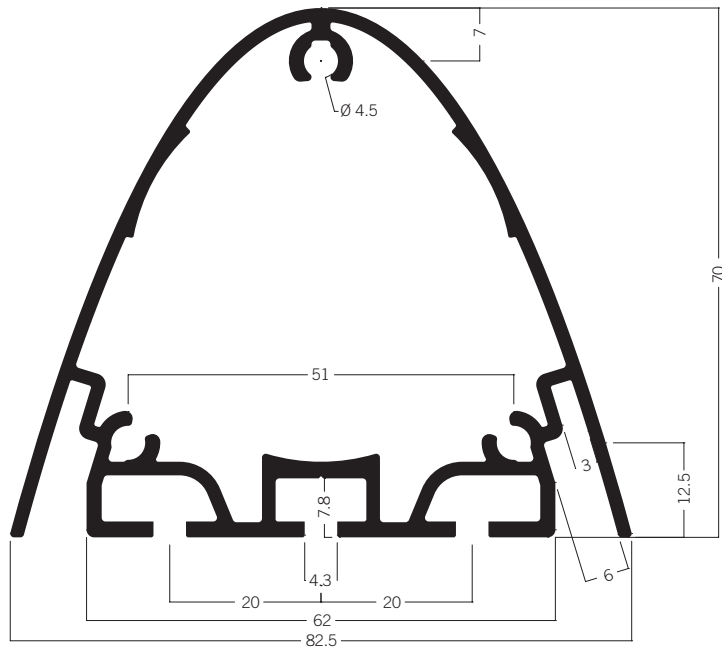

S 3050 Ovalprofil
11.34 kg l 6000 mm

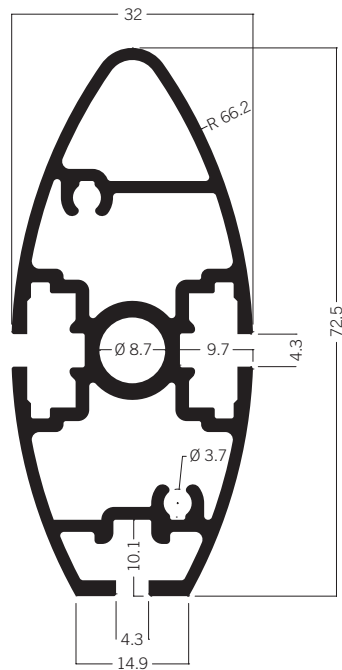

S 6105 Ovalprofil 32 x 72.5 mm
7.65 kg l 5000 mm

Ovalprofile

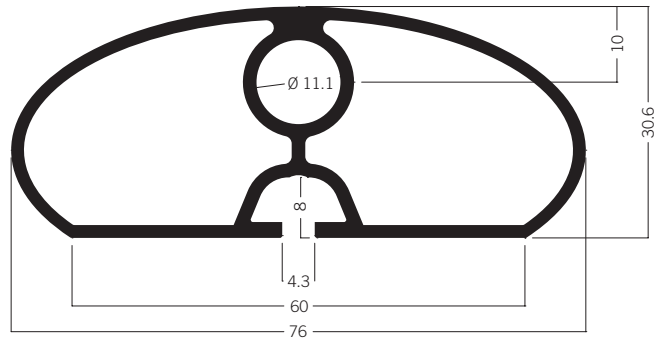

DFL 400 Handlaufprofil
6.96 kg | 6000 mm

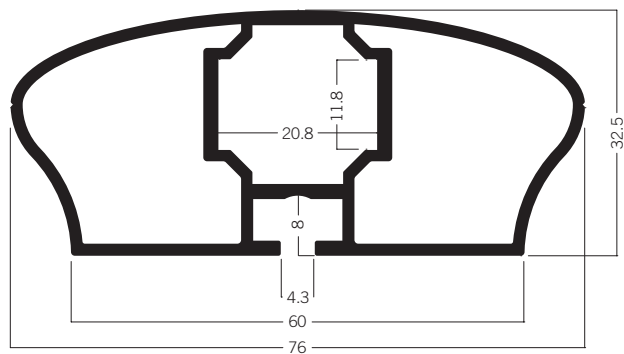

DFL 400A* Handlaufprofil
7.12 kg | 6000 mm

STOFF BEFES TIGUNG



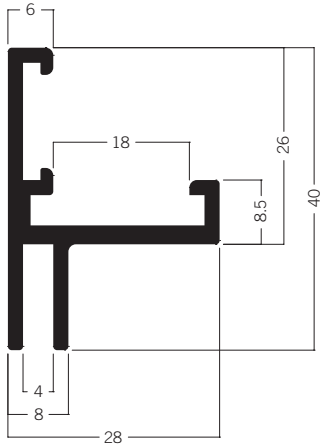

M 1302 Spannrahmenprofil 40 mm
3.49 kg | 6000 mm

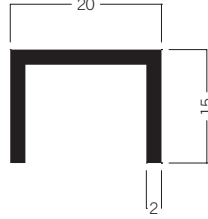

M 1312 U-Profil
1.56 kg | 6000 mm

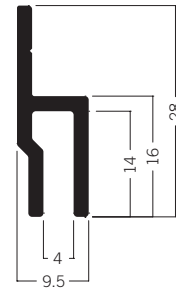

M 1614 Spannrahmenprofil 28 mm
1.54 kg | 6000 mm

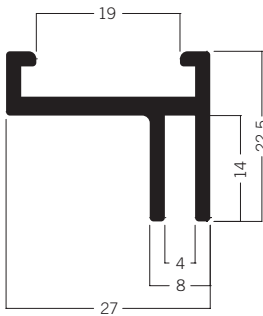

M 1309 Spannrahmenprofil 22.5 mm
2.53 kg | 6000 mm

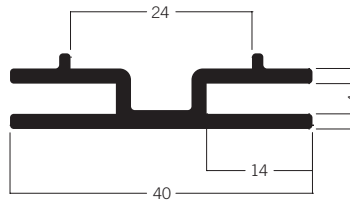

M 1310 Spannrahmenprofil 40 mm
2.69 kg | 6000 mm

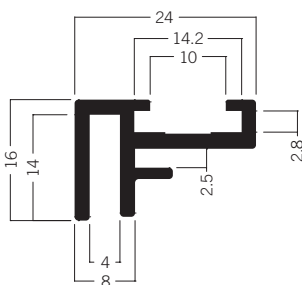

M 1607 Spannrahmenprofil 16 mm
1.91 kg | 6000 mm

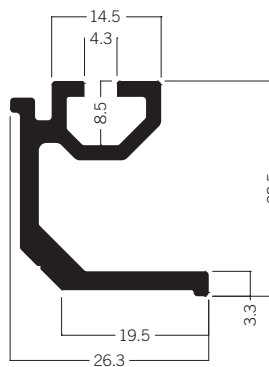

M 1326 Anschlussprofil Kubus
3.27 kg | 6000 mm

STOFFBEFESTIGUNG

Spannrahmenprofile

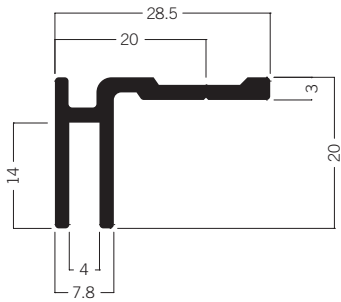

M 1322 Spannrahmenprofil 20 mm
2.03 kg | 6000 mm

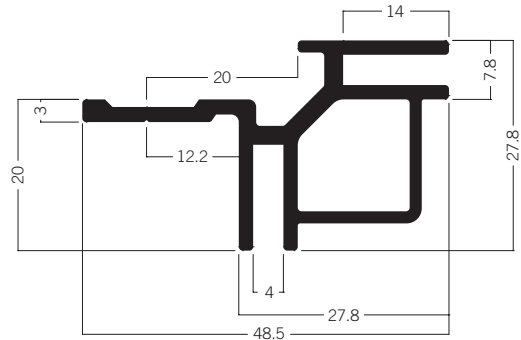

M 1322/E Spannrahmenprofil Außeneck
4.42 kg | 6000 mm

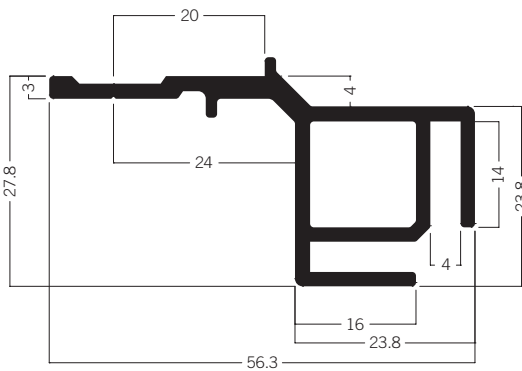

M 1322/I Spannrahmenprofil Inneneck
4.61 kg | 6000 mm

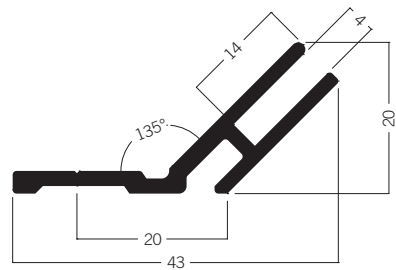

M 1321 Spannrahmenprofil 135°
2.29 kg | 6000 mm

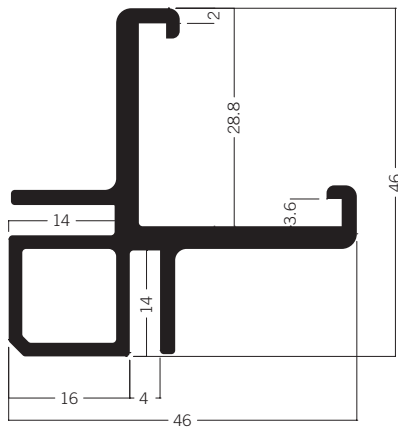

M 1332 Spannrahmenprofil Kubus
5.94 kg | 6000 mm

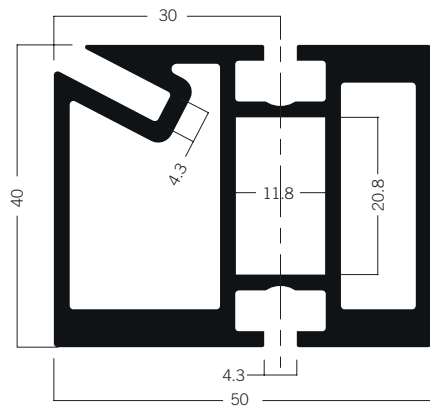

CO 730* Spannrahmenprofil
11.75 kg | 6100 mm

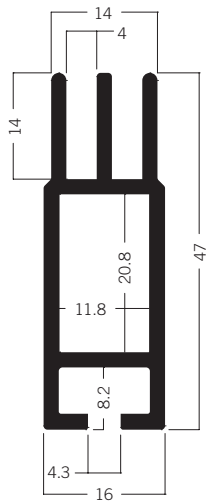

M 1504 Spannrahmenprofil Kubus
4.57 kg | 6000 mm

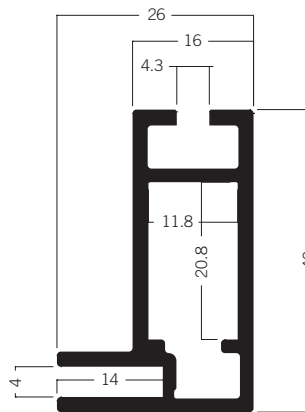

M 1306 Spannrahmenprofil 40 mm
4.55 kg | 6000 mm

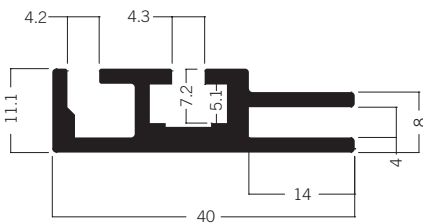

M 1930 Spannrahmenprofil für Leuchtrahmen 40 mm
3.41 kg | 6000 mm

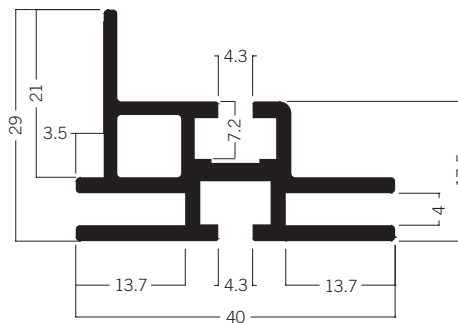

M 1970 Spannrahmenprofil für Leuchtrahmen 40 mm
4.34 kg | 6000 mm

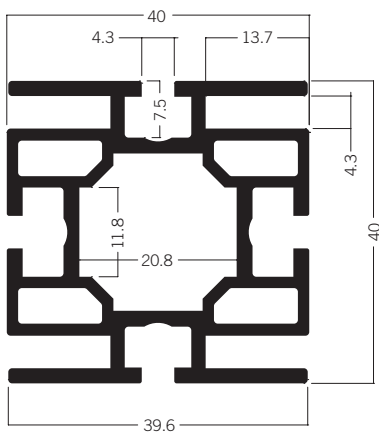

M 1305 Spannrahmenprofil 40 mm
8.23 kg | 6000 mm

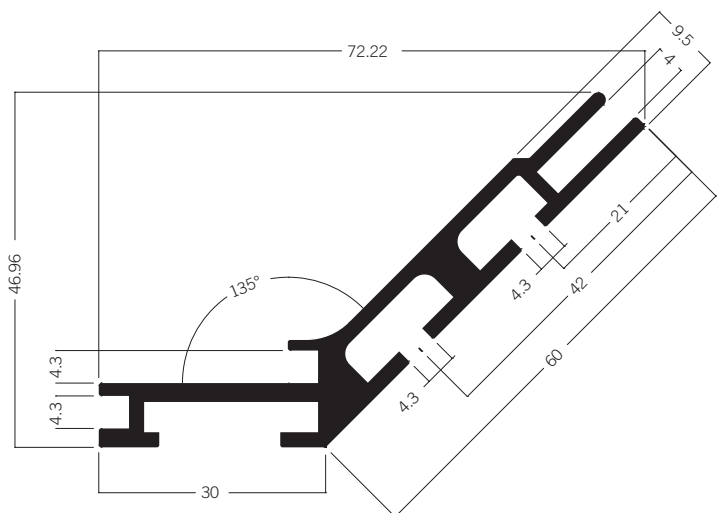

M 1301 Spannrahmenprofil 135°
6.55 kg | 6000 mm

STOFFBEFESTIGUNG

Spannrahmenprofile

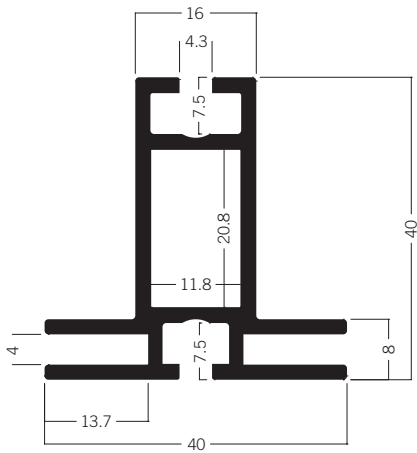

M 1307 Spannrahmenprofil 40 mm
5.39 kg | 6000 mm

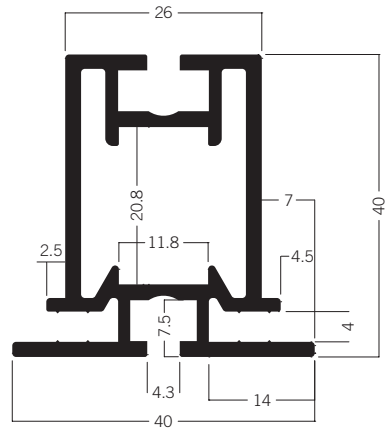

W 906 Spannrahmenprofil 40 mm
6.35 kg | 6000 mm

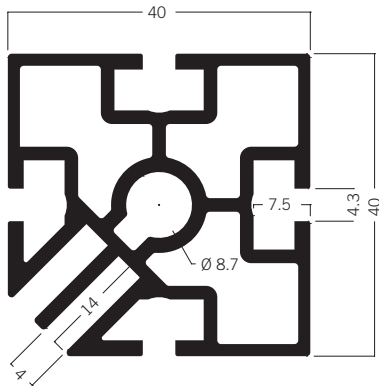

S 382 Stützenprofil 90° mit Kedernut
6.91 kg | 5000 mm

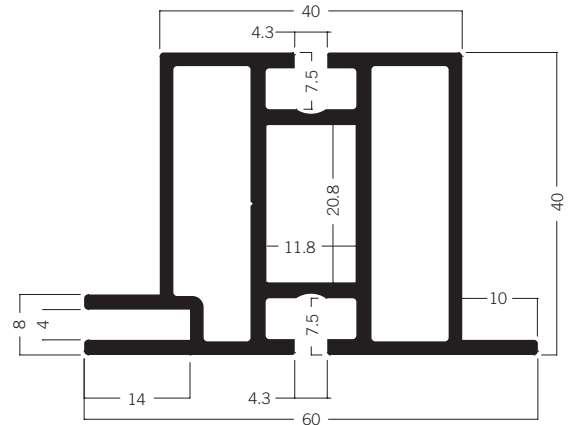

W 730 Spannrahmenprofil 60 mm
8.66 kg | 6000 mm

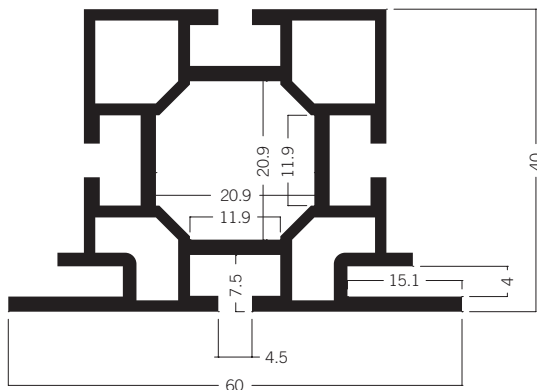

W 735R* Rahmenprofil 60 mm universal (USA)
9.20 kg | 6150 mm

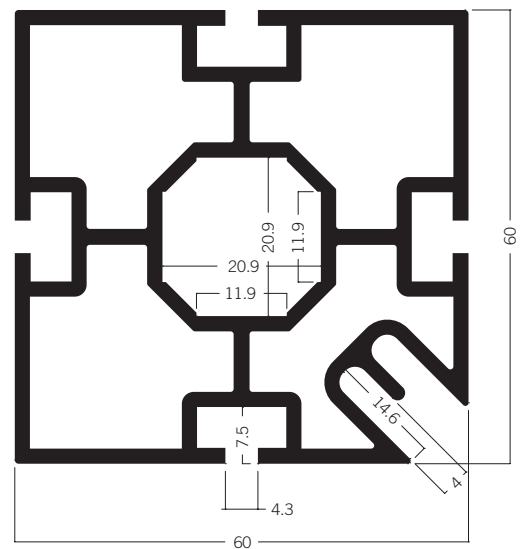

S 385R* Stützenprofil mit Kedernut (USA)
14.01 kg | 6150 mm

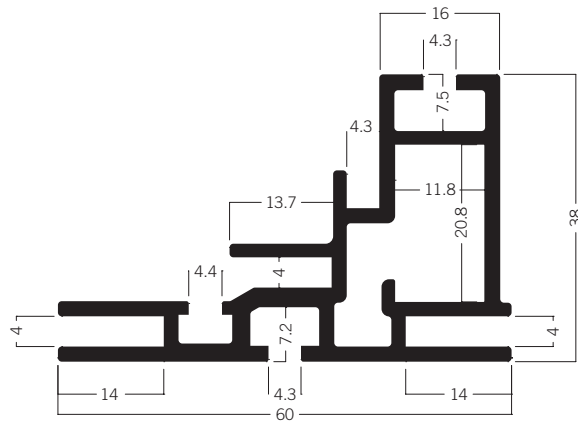

M 1910 Spannrahmenprofil für Leuchtrahmen 60 mm
7.62 kg | 6000 mm

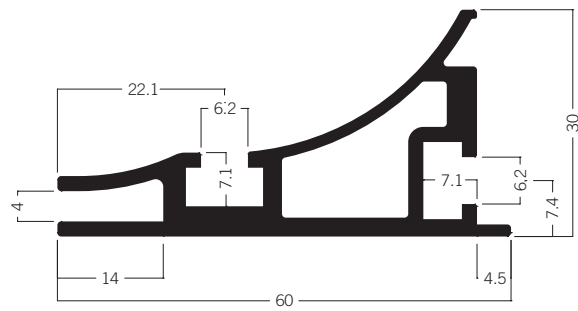

M 1920 Spannrahmenprofil für Leuchtrahmen 60 mm
6.07 kg | 6000 mm

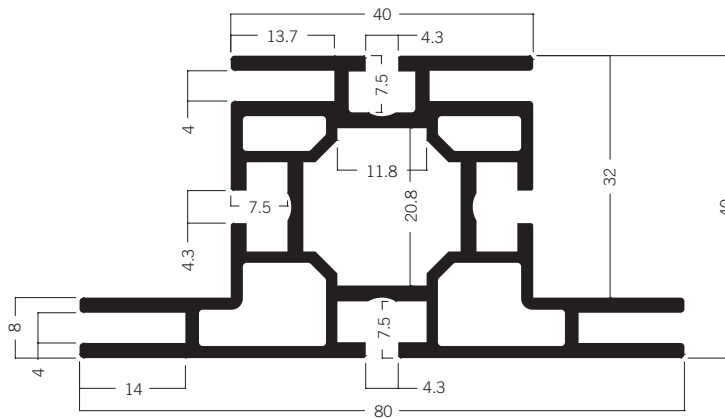

M 1304 Spannrahmenprofil 80 mm
10.15 kg | 6000 mm

Spannrahmenprofile

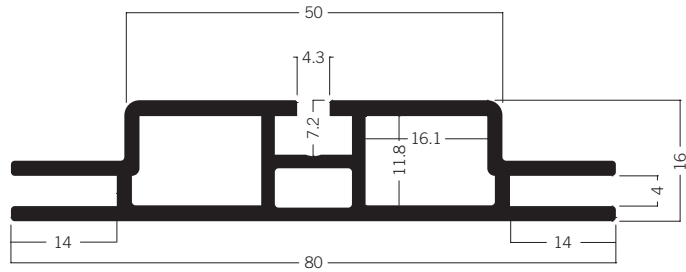

M 1925 Spannrahmenprofil für Leuchtrahmen 80 mm
6.55 kg l 6000 mm

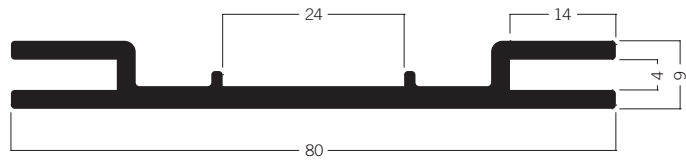

M 1325 Spannrahmenprofil 80 mm
5.33 kg l 6000 mm

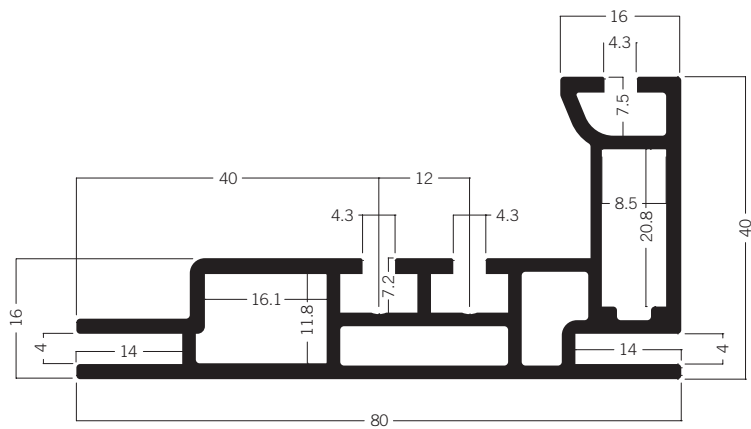

M 1935 Spannrahmenprofil für Leuchtrahmen 80 mm
9.58 kg l 6000 mm

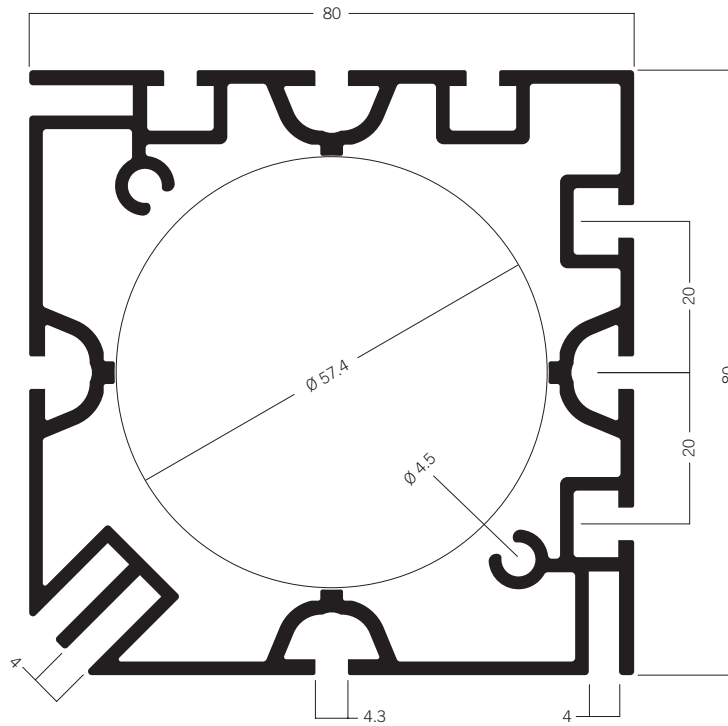

WP 850 Eckstützenprofil 90° mit Kedernut
16.48 kg | 6000 mm

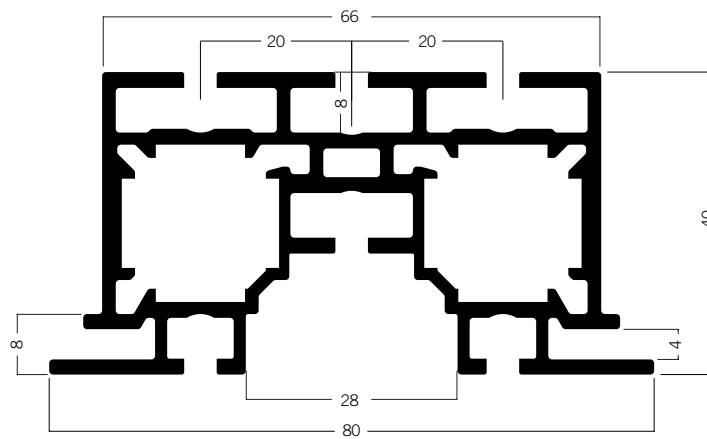

WP 860 Spannrahmenprofil 80 mm
12.99 kg | 6060 mm

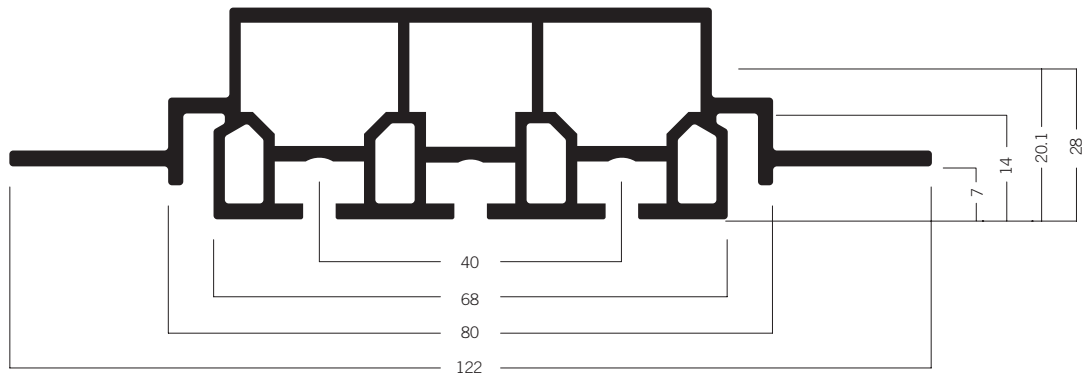

WP 820 T-Anschlussprofil
11.70 kg | 6060 mm

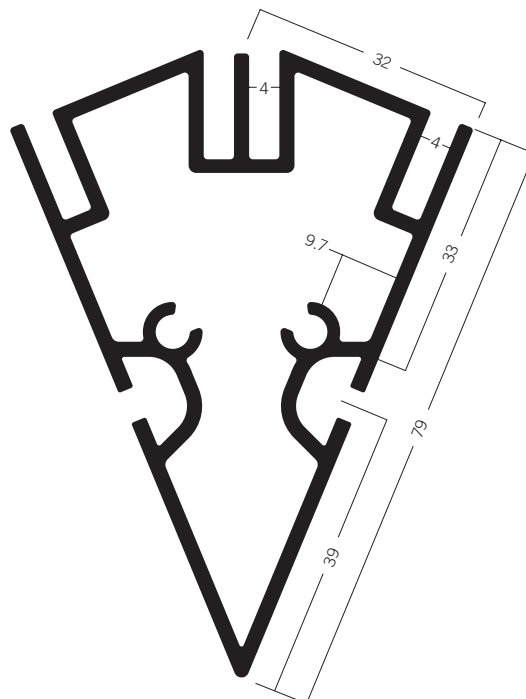

WP 840 Eckstützenprofil 135° mit Kedernut
11.28 kg | 6060 mm

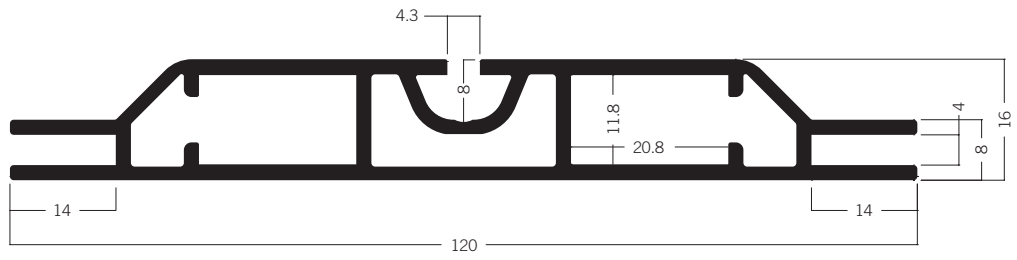

M 1901 Spannrahmenprofil für Leuchtrahmen 120 mm
9.77 kg | 6000 mm

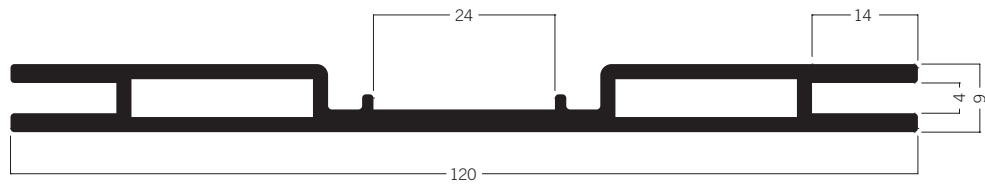

M 1330 Spannrahmenprofil 120 mm
8.28 kg | 6000 mm

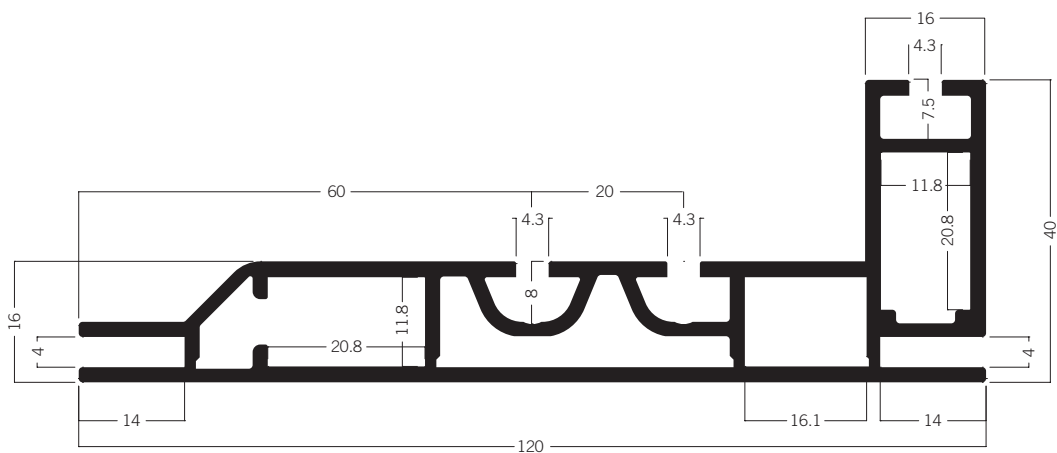

M 1915 Spannrahmenprofil für Leuchtrahmen 120 mm
11.90 kg | 6000 mm

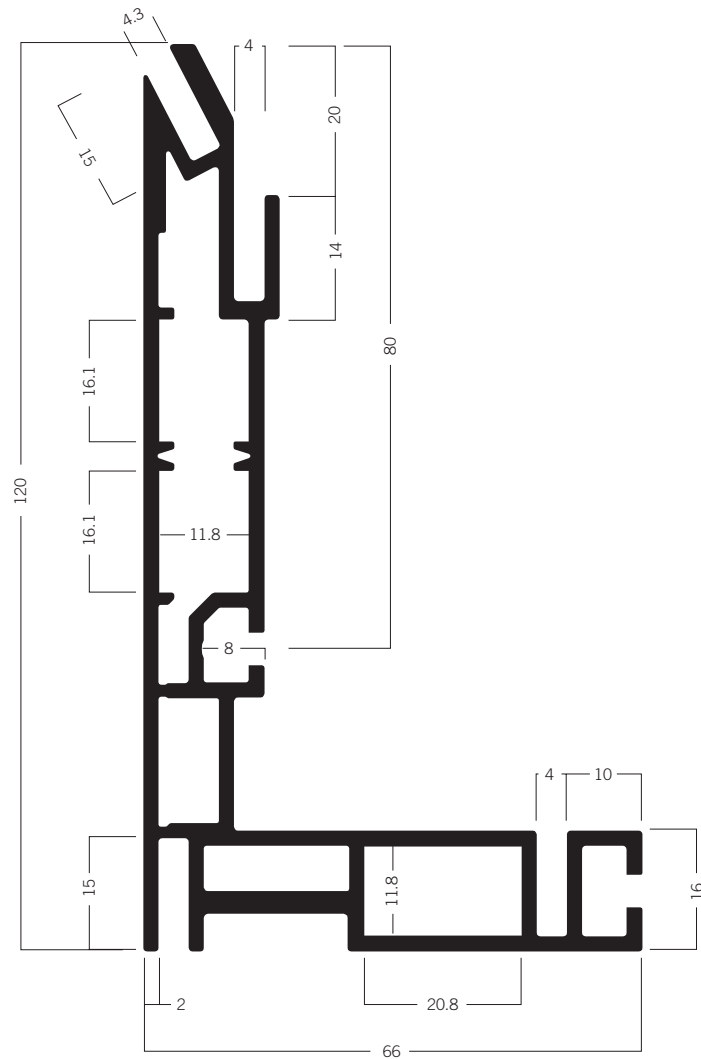

U 1060 Spannrahmenprofil 120 mm
16.20 kg | 6000 mm

Spannrahmenprofile

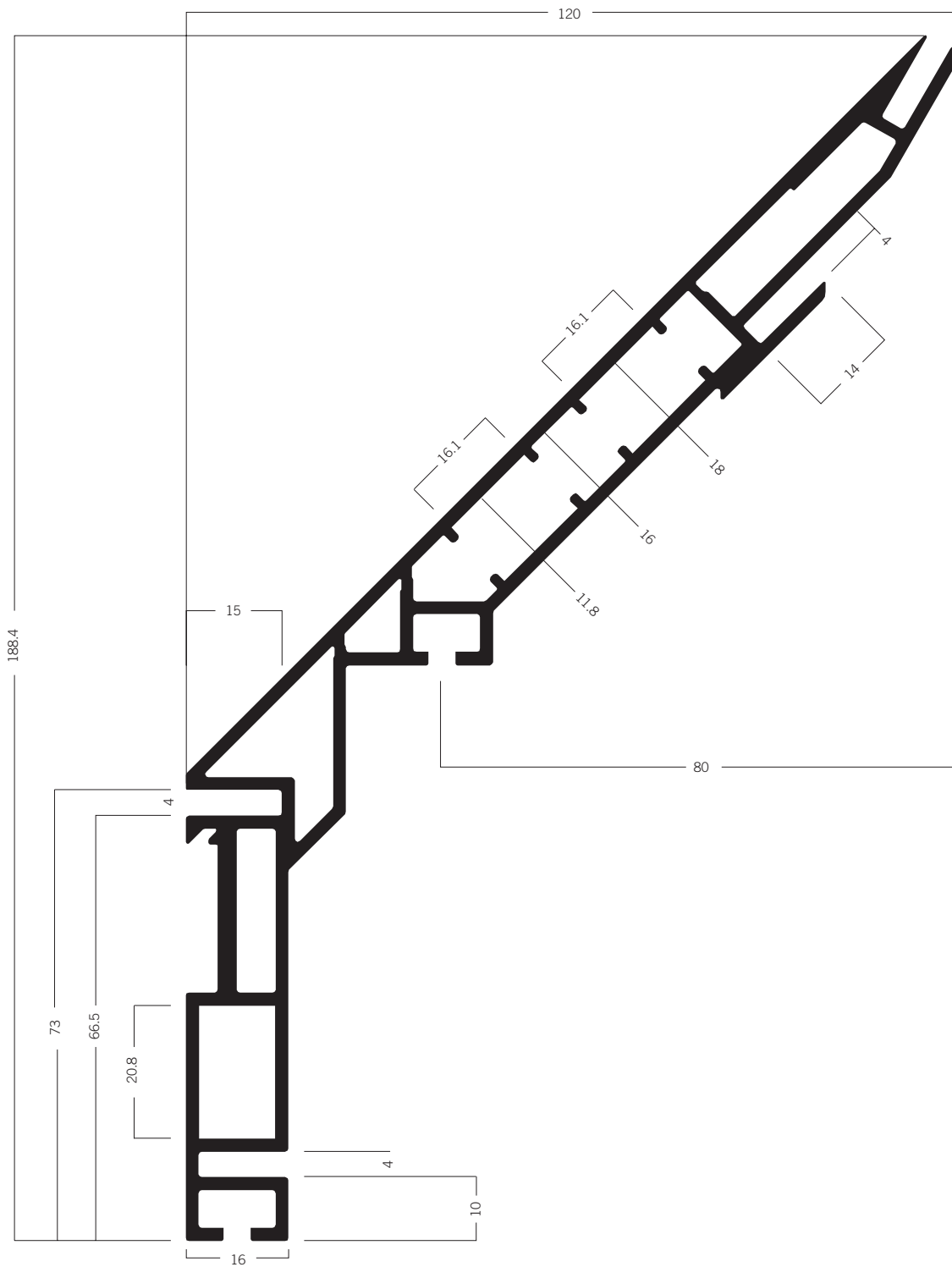

U 1063 Spannrahmenprofil 120 mm
21.51 kg | 6000 mm



STOFFBEFESTIGUNG

Stoffhalteprofile

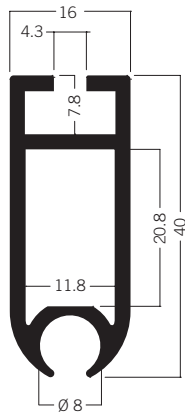

M 1354 Stoffhalteprofil 40 mm
3.18 kg | 5000 mm

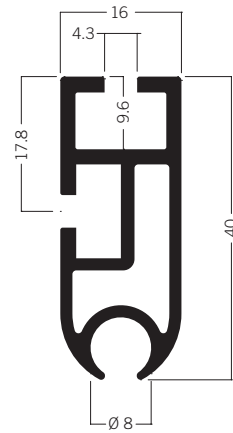

M 1356 Stoffhalteprofil 40 mm
3.20 kg | 5000 mm

PROFIL SONDER FORMEN





Abdeckprofile

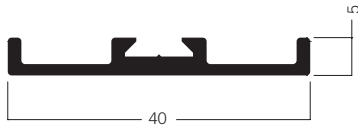

W 910 Abdeckprofil für Profile 40 mm
1.36 kg | 5000 mm

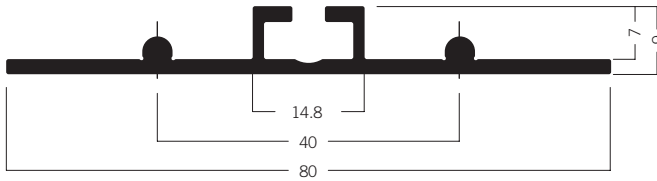

WP 830 Abdeckprofil für Profil WP 860
3.58 kg | 6060 mm

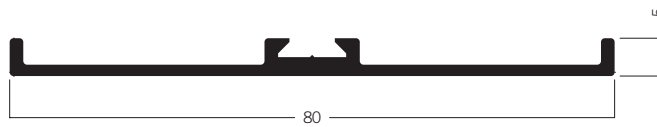

M 1044 Abdeckprofil für Profile 80 mm
2.14 kg | 5000 mm



M 1367 Abdeckprofil für Profile 80 mm
2.12 kg | 5000 mm



M 1368 Abdeckprofil für Profile 120 mm
3.10 kg | 5000 mm

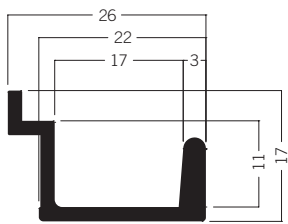

W 110* Adaptionprofil für vorgehängte Wand
1.47 kg | 5000 mm

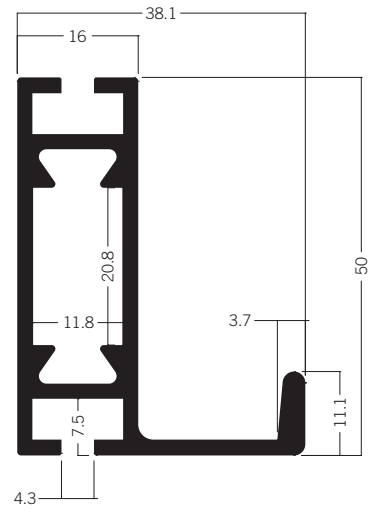

W 101 Zargenprofil 50 mm
5.56 kg | 5000 mm

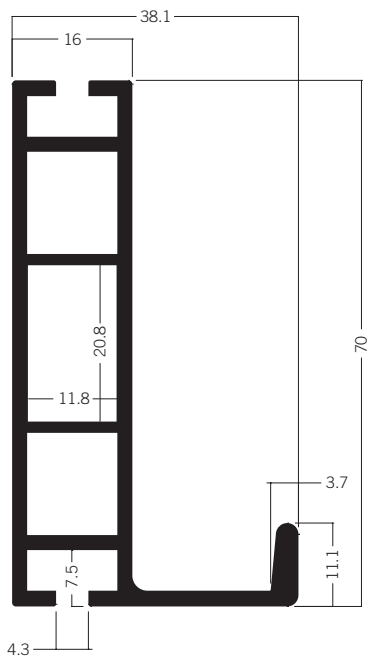

W 103 Zargenprofil 70 mm
6.51 kg | 5000 mm

PROFILSONDERFORMEN

Wandaufnahmeprofle

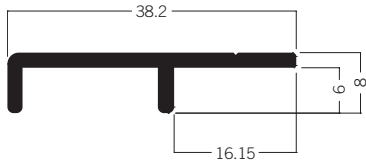

M 1562 Wandaufnahmeprofil oben
1.37 kg | 5000 mm

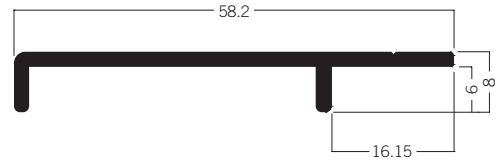

M 1572 Wandaufnahmeprofil oben
1.77 kg | 5000 mm

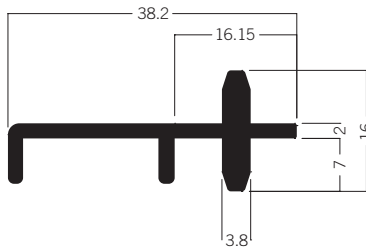

M 1567 Wandaufnahmeprofil Mitte
2.04 kg | 5000 mm

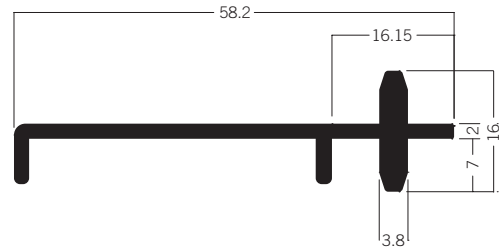

M 1577 Wandaufnahmeprofil Mitte
2.45 kg | 5000 mm

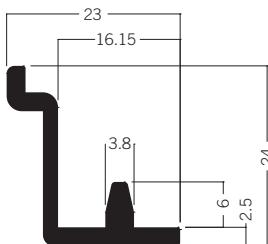

M 1571 Wandaufnahmeprofil unten
1.62 kg | 5000 mm

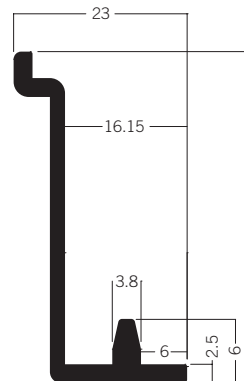

M 1581 Wandaufnahmeprofil unten
2.02 kg | 5000 mm

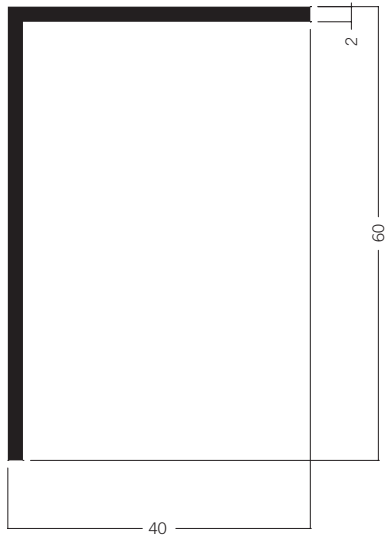

SO 500 Sockelwinkel
2.52 kg | 5000 mm

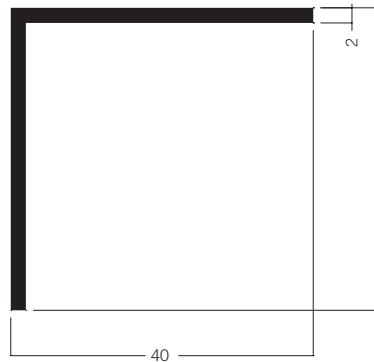

SO 400 Sockelwinkel OCTAeco floor
2.16 kg | 5000 mm

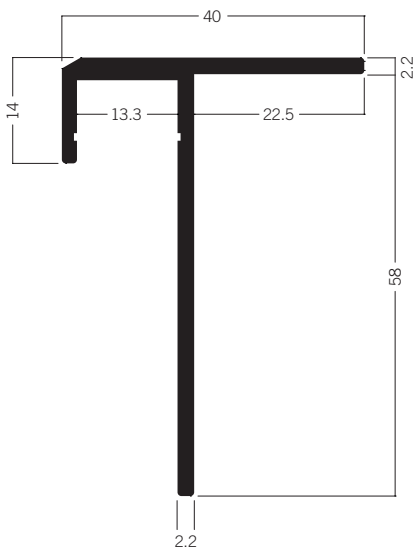

SO 600 Sockelwinkel für LED Modul
3.31 kg | 5000 mm

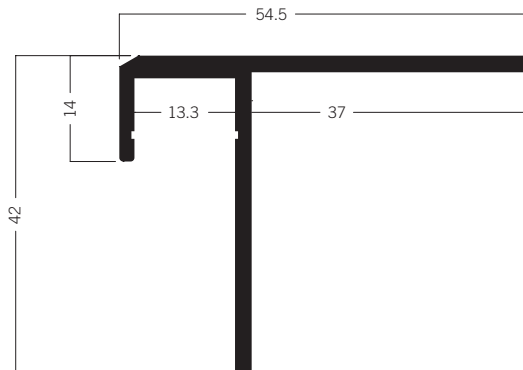

SO 630 Sockelwinkel für LED Modul
3.20 kg | 5000 mm

Sockelwinkel

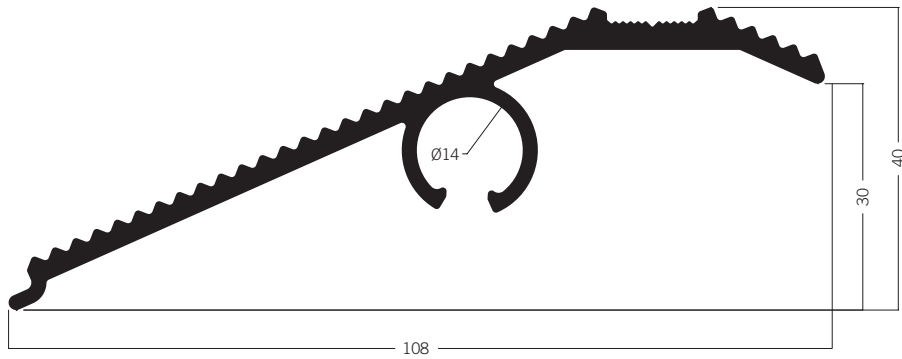

SO 620 Antrittsleiste
6.12 kg | 5000 mm

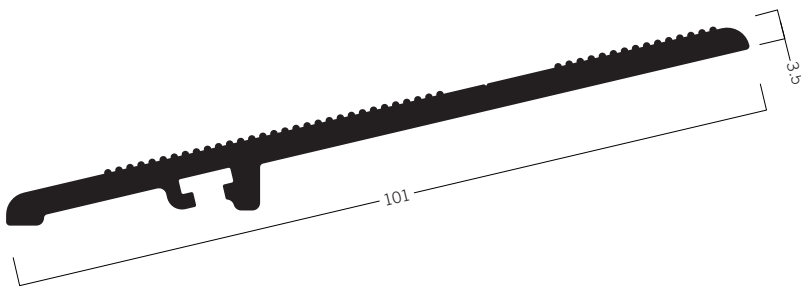

SO 640 Teppichleiste
5.48 kg | 5100 mm



SO 642 Laminatleiste
2.40 kg | 5100 mm

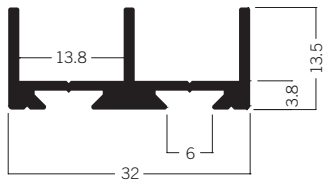

E 470/N Schiebetür-Gleitbeschlag
1.74 kg | 5000 mm

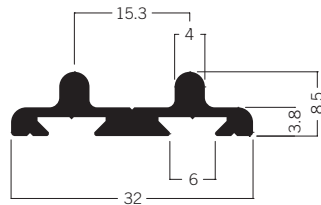

E 471/N Schiebetür-Gleitbeschlag
1.61 kg | 5000 mm

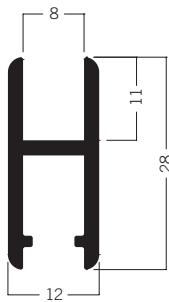

E 472 Schiebetür-Laufschuhprofil
1.74 kg | 5000 mm

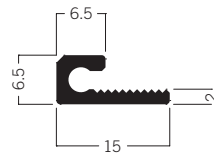

A 200 Kantenschutzprofil
0.61 kg | 5000 mm

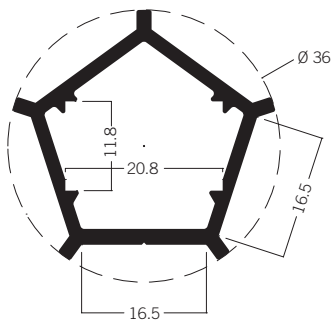

M 1980 Leuchtelementprofil
2.65 kg | 5000 mm

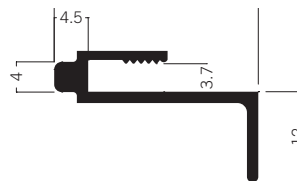

E 410/AL Schiebetür-Griffleistenprofil
1.20 kg | 5000 mm

Sonstige Profile

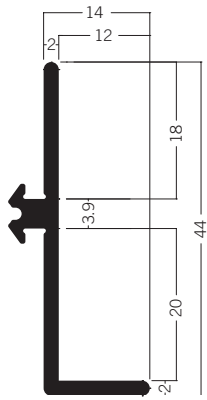

E 850* Einschubprofil
1.86 kg | 5200 mm

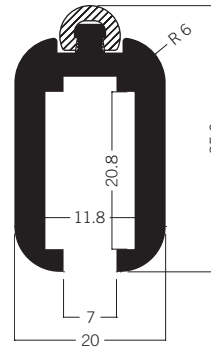

E 800 Garderobenstangenprofil
4.30 kg | 5000 mm

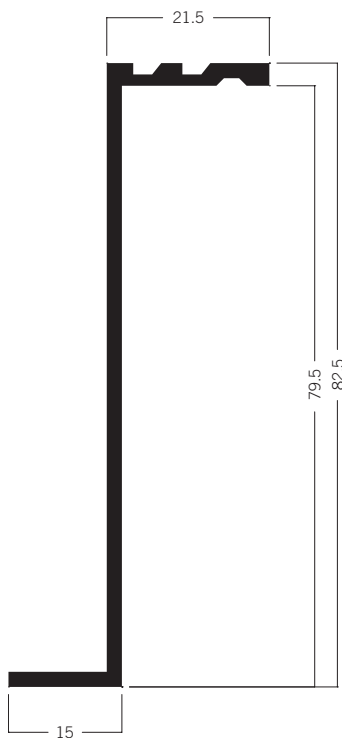

M 1520* Paneelhalteprofil für 80 mm System
3.85 kg | 6000 mm

REIN RAUM PROFILE



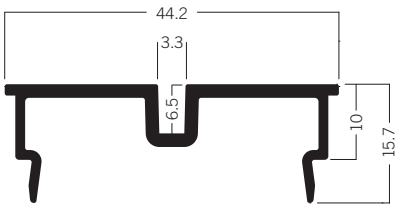

C 151 Distanzprofil 44 × 16 mm
2.28 kg | 6000 mm

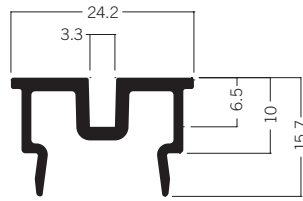

C 153 Distanzprofil 24 × 16 mm
1.69 kg | 6000 mm

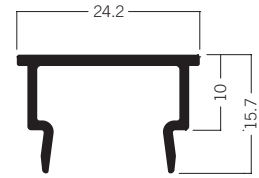

C 155* Distanzprofil 24 × 16 mm
1.24 kg | 6000 mm

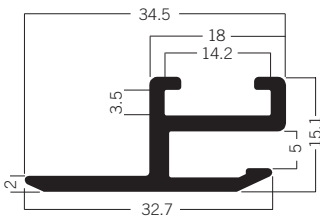

C 875 Rahmenprofil 34.5 × 15 mm
2.22 kg | 6000 mm



C 157 Anschlagprofil 37 × 7 mm
1.33 kg | 6000 mm

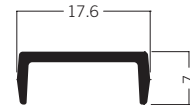

C 158 Anschlagprofil 18 × 7 mm
0.79 kg | 6000 mm



C 161 Halteprofil 2 × 20 mm
0.75 kg | 6000 mm



C 162 Halteprofil 2 × 20 mm
0.75 kg | 6000 mm



C 163 Halteprofil 2 × 22 mm
0.81 kg | 6000 mm

REINRAUMPROFILE

Wandprofile

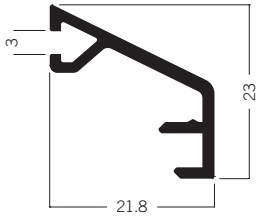

C 154 Glashalteprofil 22 × 23 mm
1.42 kg | 6000 mm

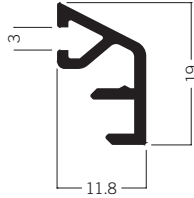

C 165 Glashalteprofil 12 × 19 mm
1.08 kg | 6000 mm

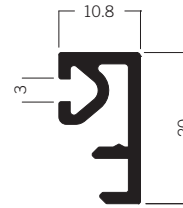

C 169 Glashalteprofil 11 × 20 mm
1.24 kg | 6000 mm

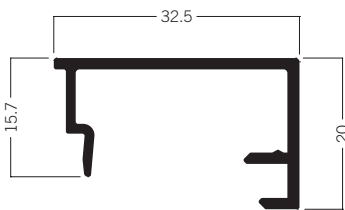

C 170 Vertikales Halteprofil 33 × 20 mm
1.38 kg | 6000 mm

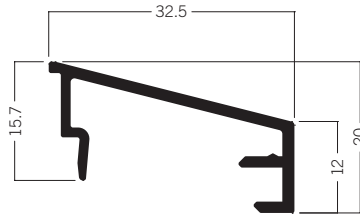

C 171 Horizontales Halteprofil 33 × 12 mm
1.64 kg | 6000 mm

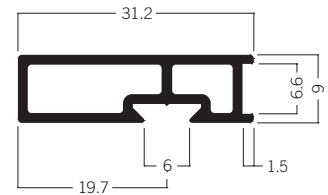

C 722 Halteprofil 31 × 9 mm
1.83 kg | 6000 mm

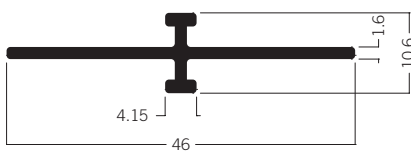

C 1415 Adaptionprofil Verglasung
1.58 kg | 6000 mm

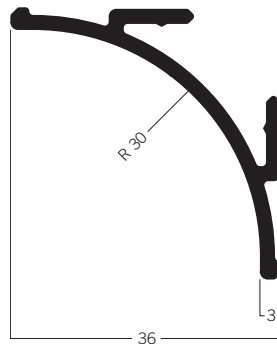

C 1301 Hohlkehlenprofil 36 × 36 mm
2.62 kg | 6000 mm

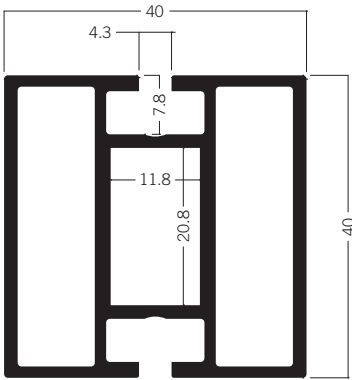

C 120 Zargenprofil 40 × 40 mm
7.09 kg | 6000 mm

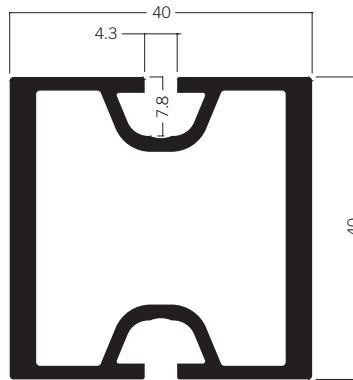

C 124 Stützenprofil 40 × 40 mm
5.82 kg | 4500 mm

C 125 Stützenprofil 40 × 40 mm
7.57 kg | 6000 mm

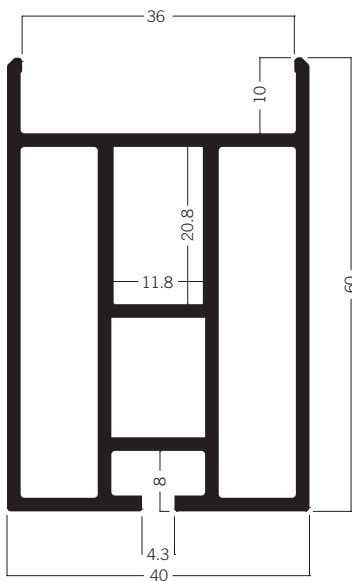

C 105 Zargenprofil 40 × 60 mm
9.26 kg | 6000 mm

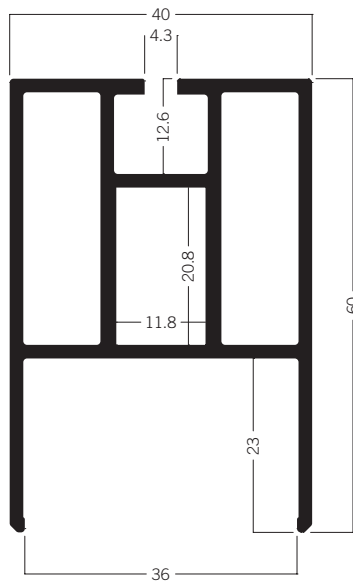

C 110 Zargenprofil 40 × 60 mm
7.57 kg | 6000 mm

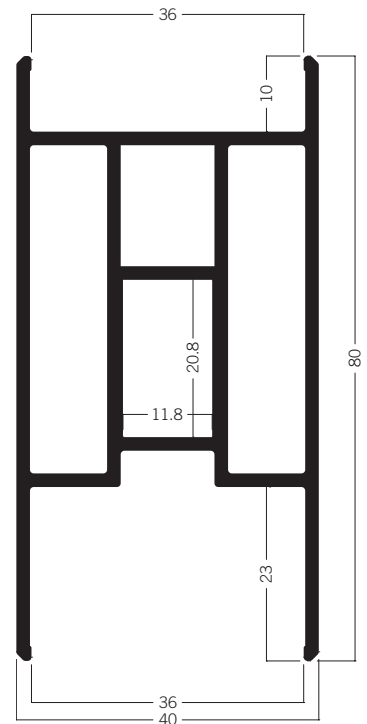

C 100 Zargenprofil 40 × 80 mm
9.98 kg | 6000 mm

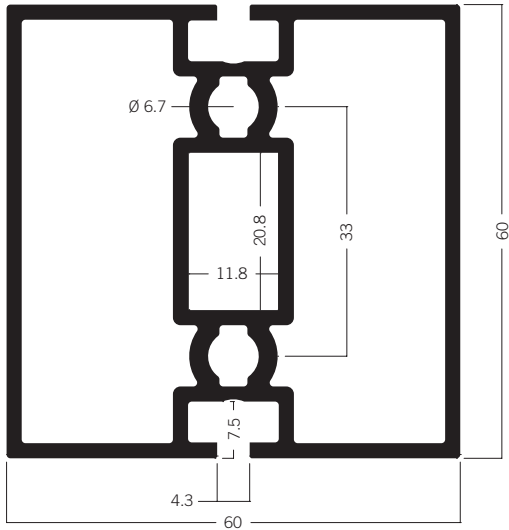

C 122 Zargenprofil 60 × 60 mm
13.03 kg | 6000 mm

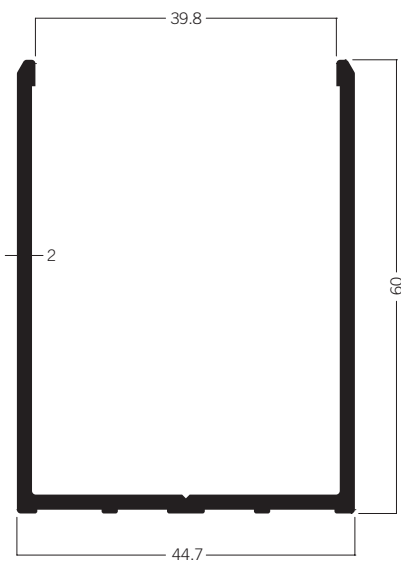

C 130 Boden U-Profil 45 × 60 mm
5.33 kg | 6000 mm

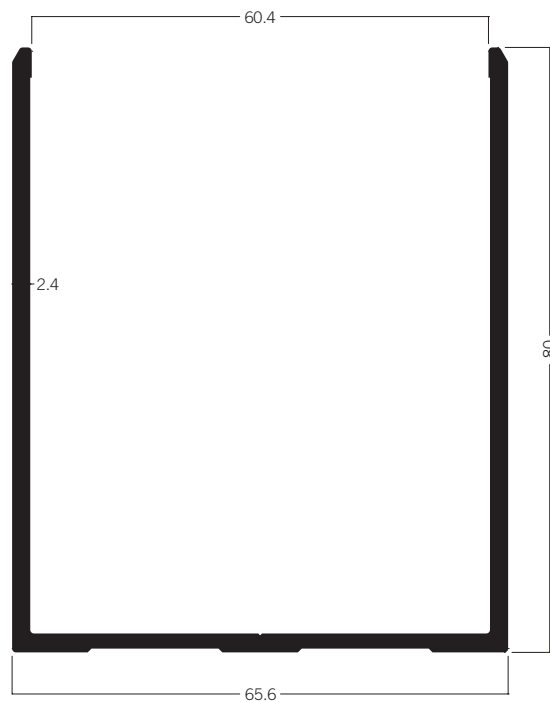

C 1005* Boden und Decken U-Profil 66 × 80 mm
8.47 kg | 6000 mm

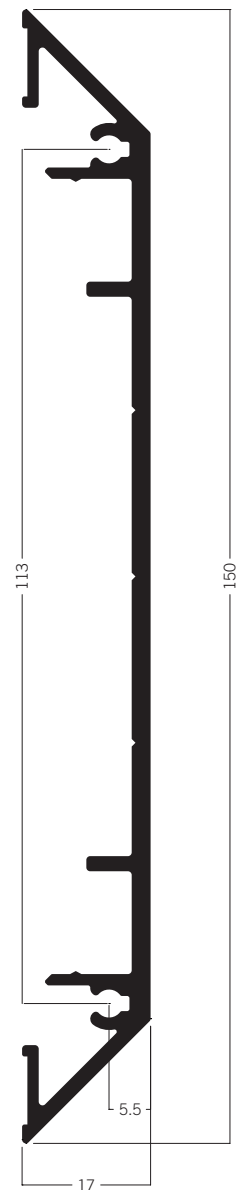

C 1327 Kabelkanalprofil
7.23 kg | 6000 mm

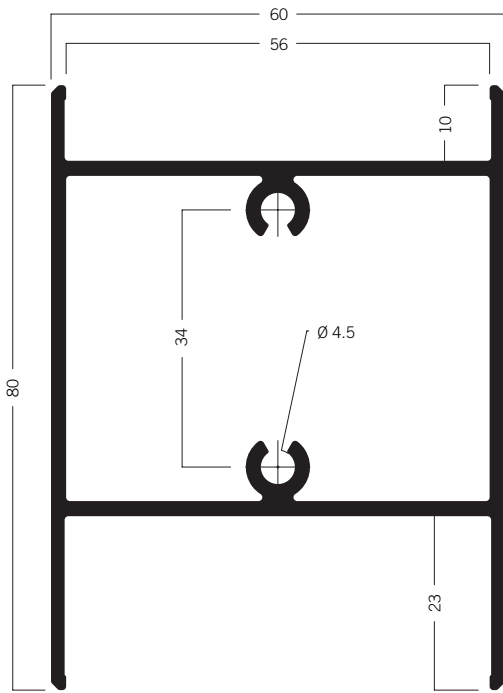

C 60-100 Zargenprofil 60 × 80 mm
9.88 kg | 6000 mm

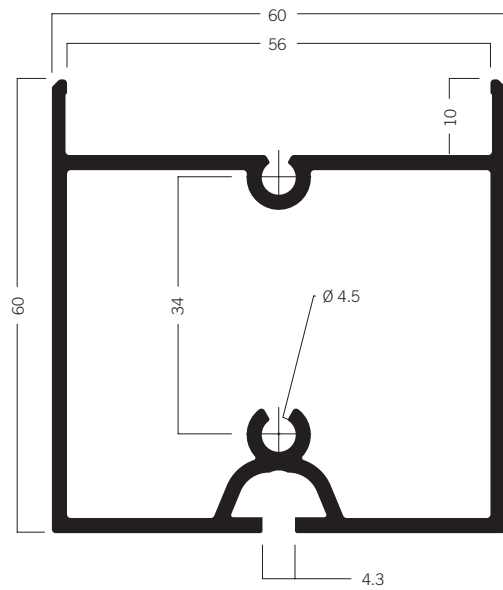

C 60-105 Zargenprofil 60 × 60 mm
8.95 kg | 6000 mm

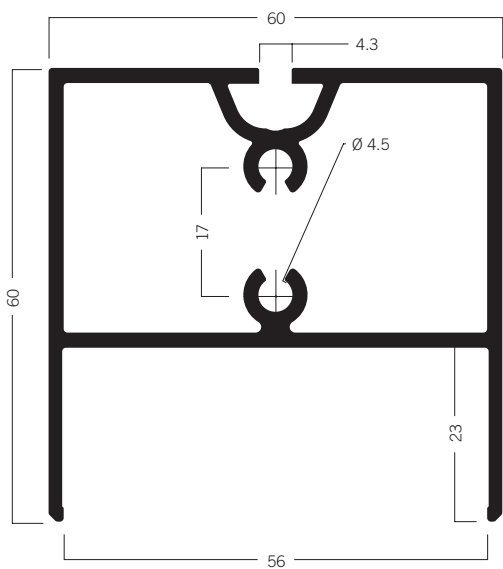

C 60-110 Zargenprofil 60 × 60 mm
9.18 kg | 6000 mm

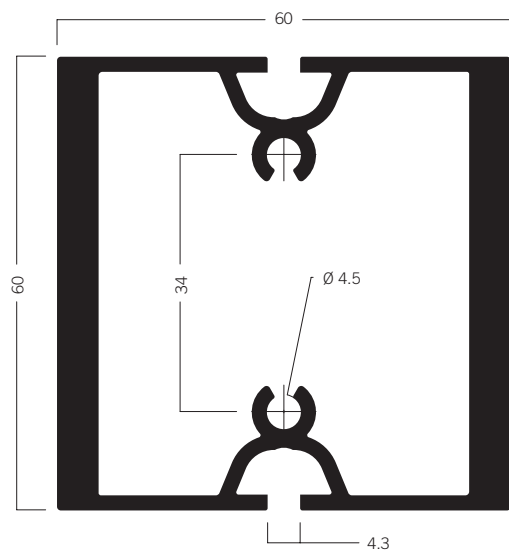

C 60-125 Stützenprofil 60 × 60 mm
16.25 kg | 6000 mm

REINRAUMPROFILE

Wandprofile

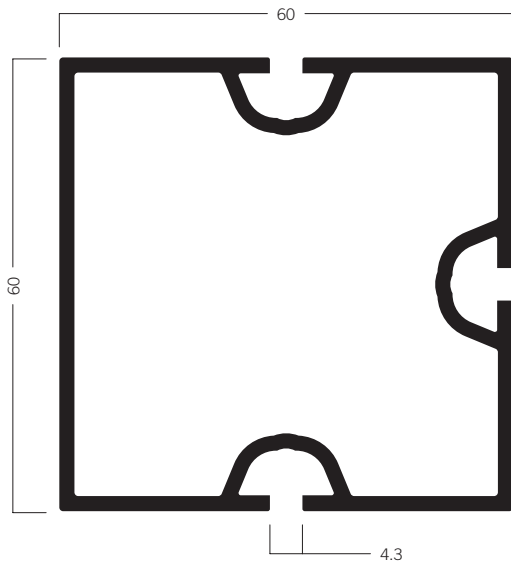

C 60-1005 Zargenprofil 60 × 60 mm
9.51 kg | 6000 mm

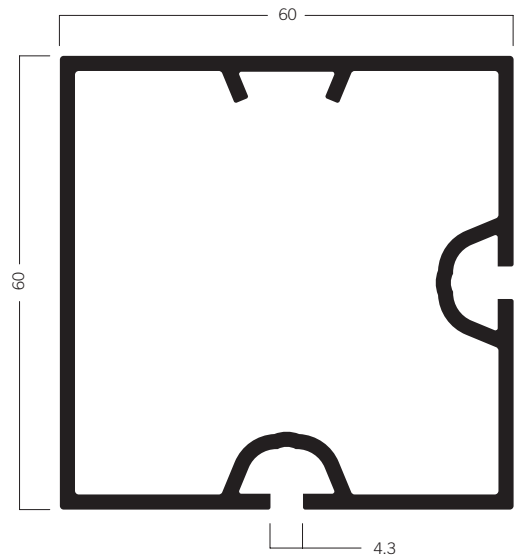

C 60-1007 Eckstützenprofil 60 × 60 mm
9.18 kg | 6000 mm

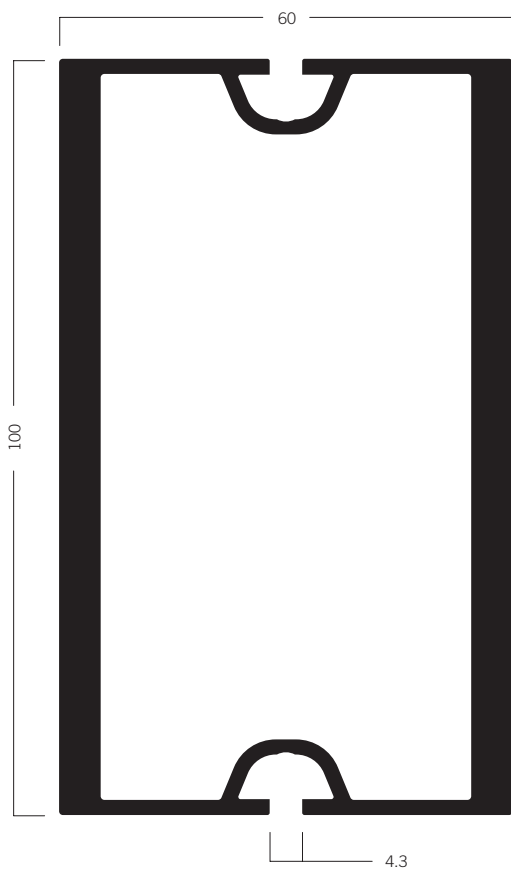

C 60-1029 Stützenprofil 60 × 100 mm
27.00 kg | 6000 mm

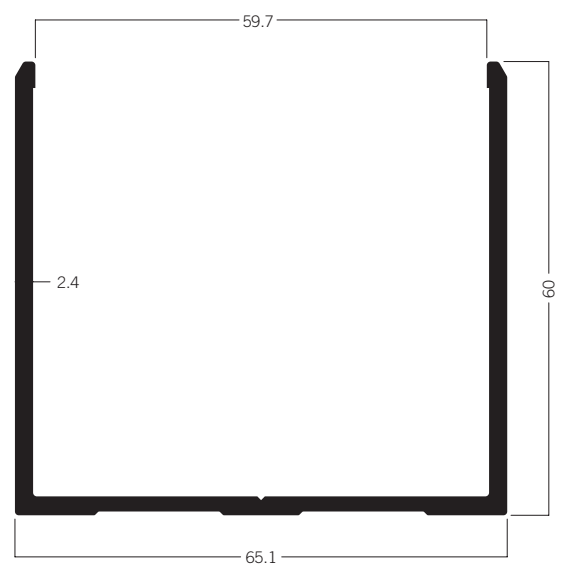

C 60-130 U-Profil 65 × 60 mm
6.90 kg | 6000 mm

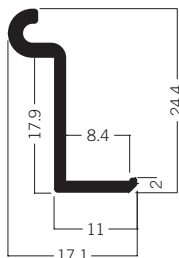

C 612 Auflageprofil 17 × 24 mm
1.11 kg | 6000 mm

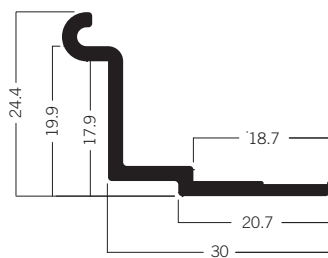

C 613 Auflageprofil 30 × 24 mm
1.82 kg | 6000 mm

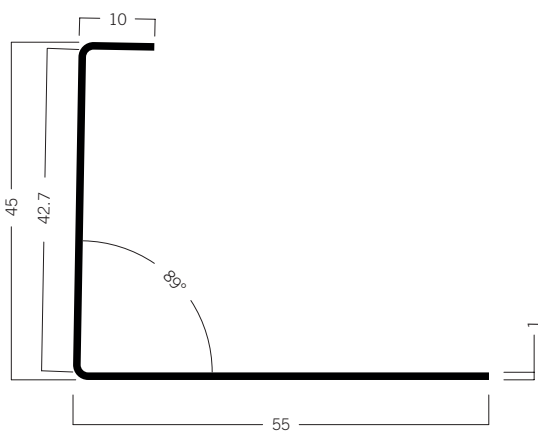

C 670 Deckenprofil
0.56 kg | 2400 mm

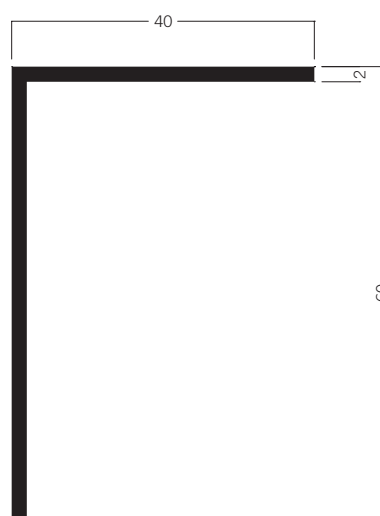

C 680 L-Profil 40 × 60 mm
2.96 kg | 6000 mm

REINRAUMPROFILE

Deckenprofile

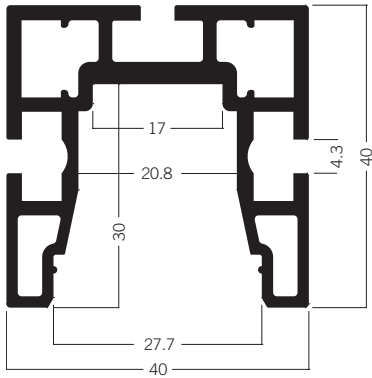

C 404* Deckenprofil LED (USA)
8.05 kg | 6000 mm

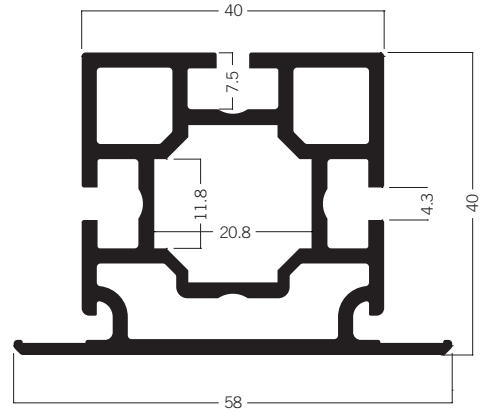

C 601 Profil 58 × 40 mm
8.69 kg | 6000 mm

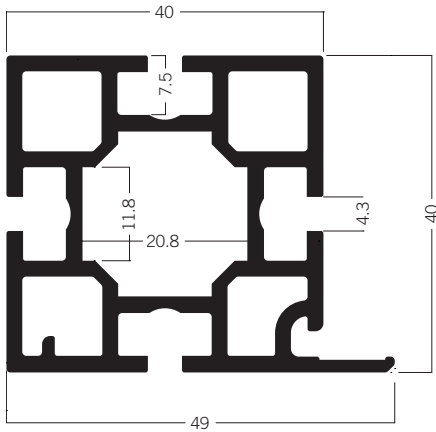

C 604 Profil 49 × 40 mm
9.15 kg | 6000 mm

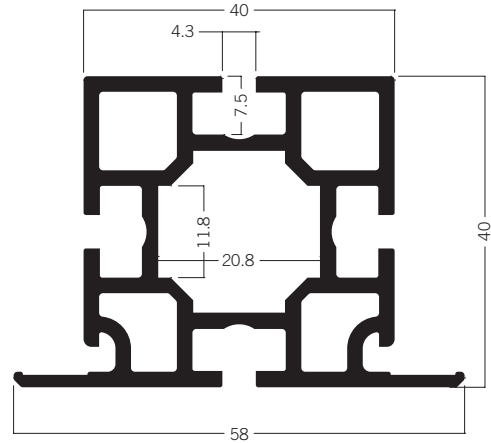

C 606 Profil 58 × 40 mm
9.50 kg | 6000 mm

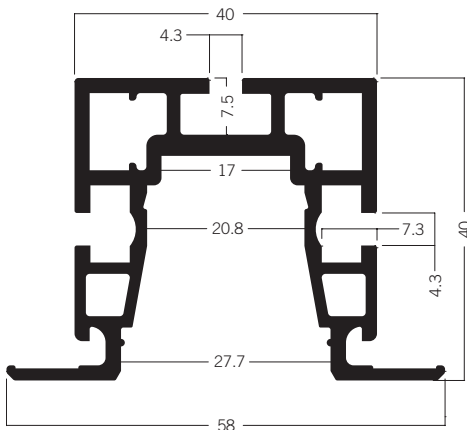

C 608 Deckenprofil LED
7.32 kg | 6000 mm

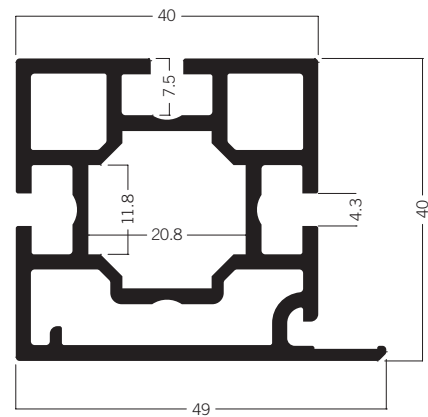

C 701 Profil 49 × 40 mm
8.88 kg | 6000 mm

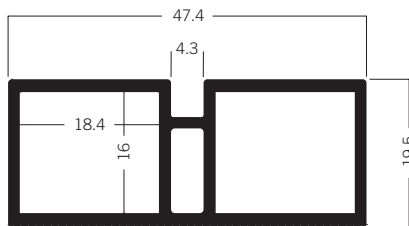

C 1210 Rahmenprofil für Türverglasung
4.33 kg | 6000 mm

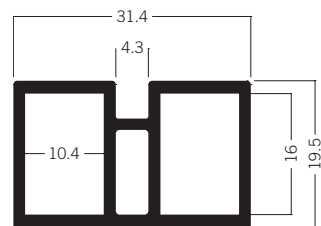

C 1220 Rahmenprofil 20 × 31 mm
3.42 kg | 6000 mm

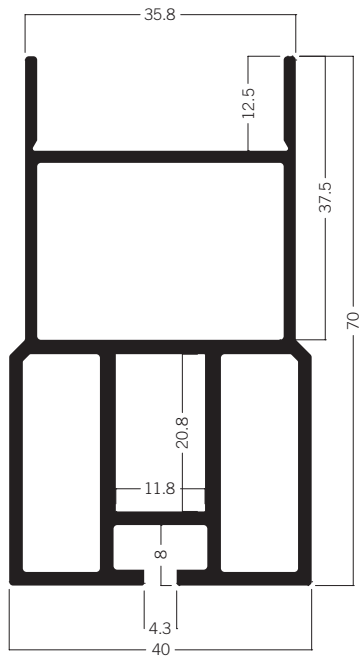

C 115 Zargenprofil 40 × 70 mm
9.03 kg | 6000 mm

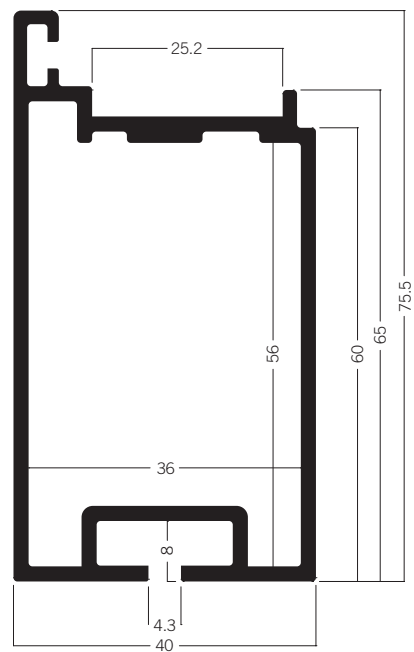

C 305 Fensterflügelprofil 40 × 75.5 mm
8.62 kg | 6000 mm

REINRAUMPROFILE

Türprofile

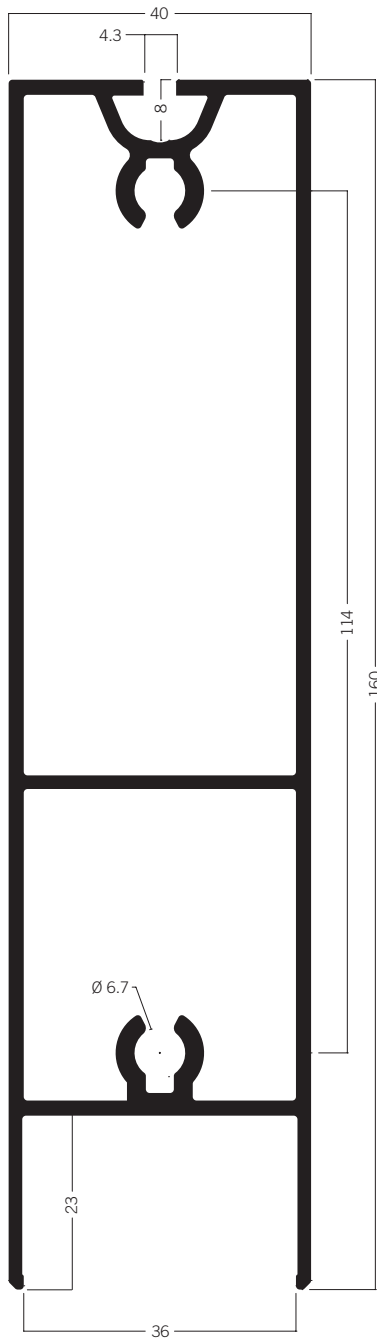

C 315 Türzargenprofil 40 × 160 mm
16.36 kg | 6000 mm

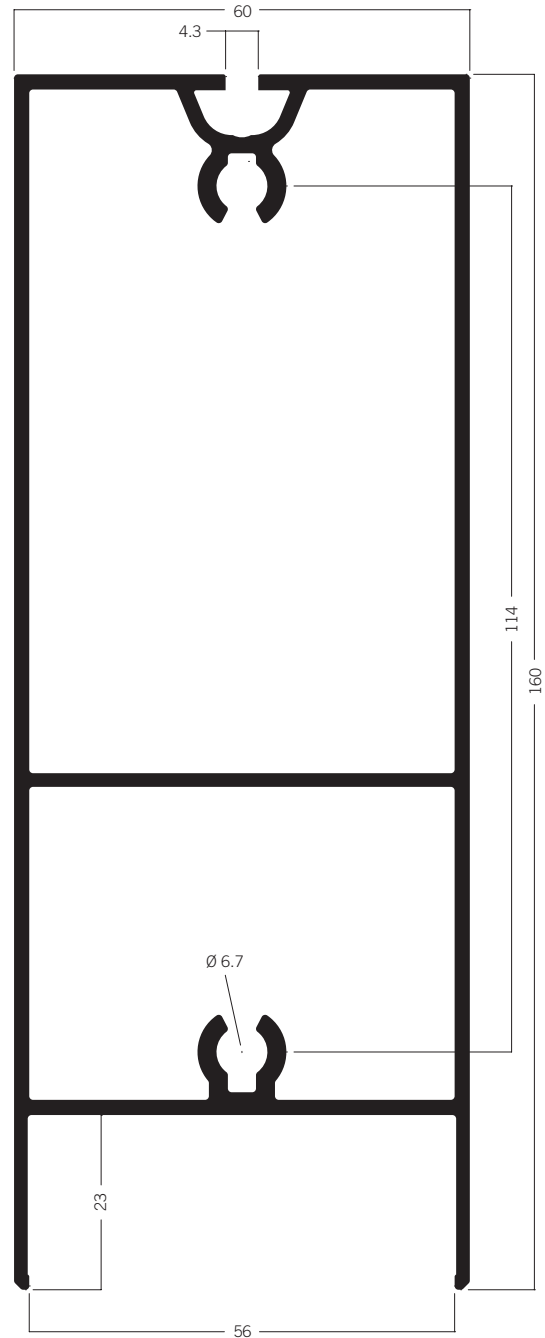

C 316 Türzargenprofil 60 × 160 mm
18.12 kg | 6000 mm

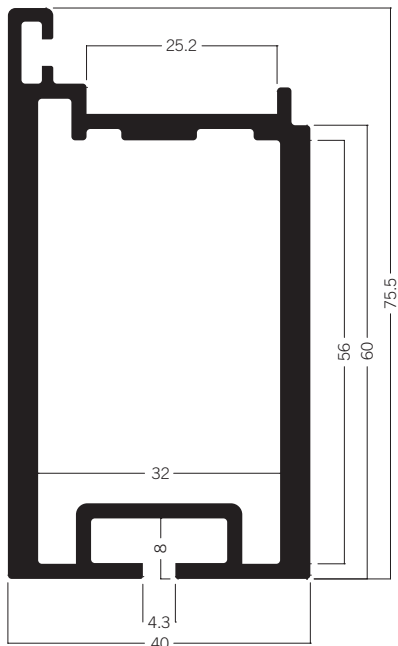

C 308 Türflügelprofil 40 × 75.5 mm
11.45 kg | 5500 mm

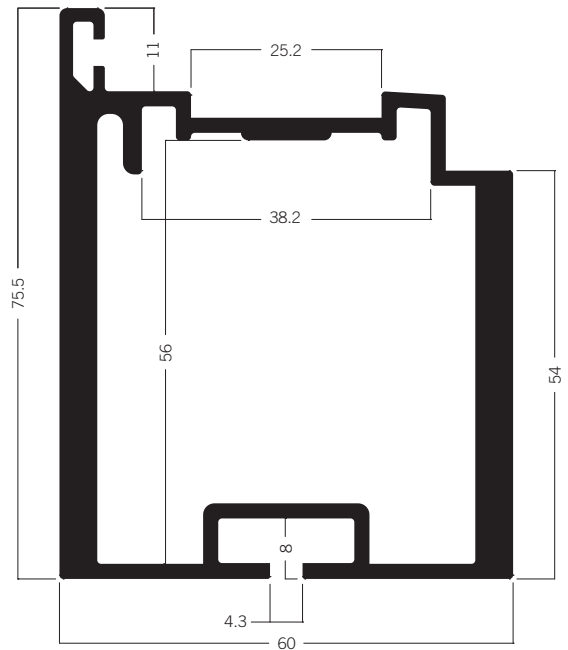

C 309 Türflügelprofil 60 × 75.5 mm
14.46 kg | 5500 mm

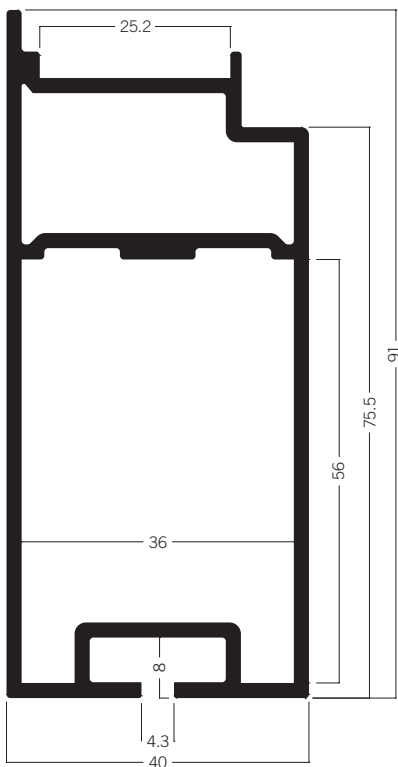

C 310 Doppeltürflügelprofil 40 × 91 mm
10.80 kg | 6000 mm

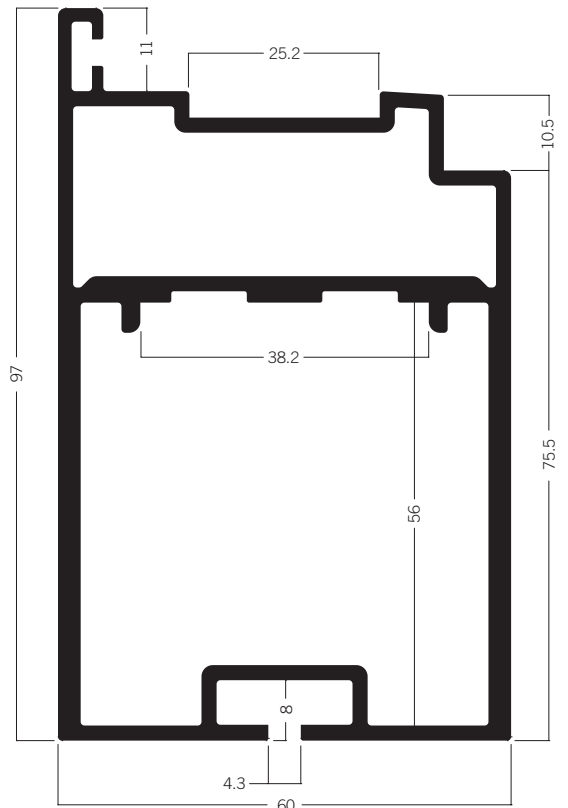

C 311 Doppeltürflügelprofil 60 × 97 mm
9.09 kg | 6000 mm

REINRAUMPROFILE

Türprofile

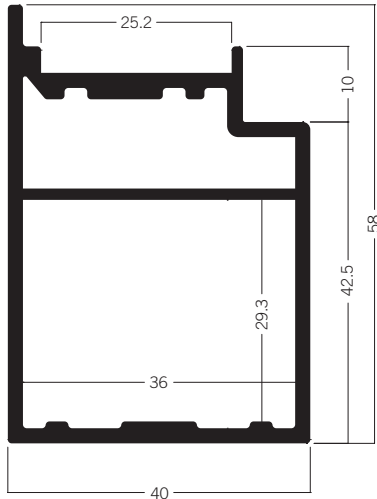

C 301 Türrahmenprofil 40 × 58 mm
7.54 kg | 6000 mm

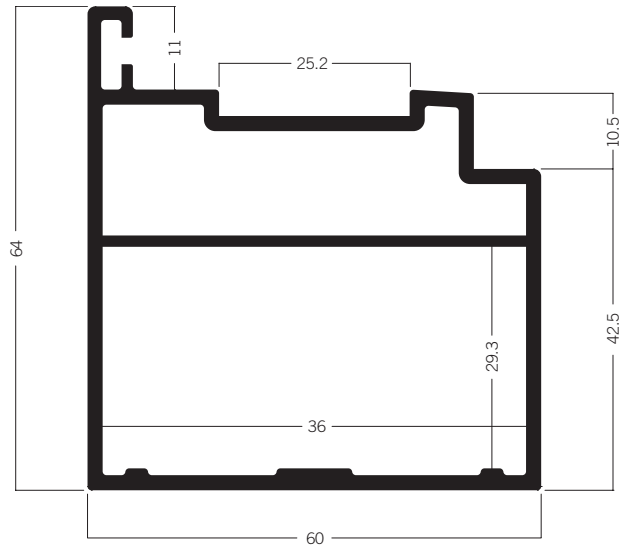

C 302 Türrahmenprofil 60 × 64 mm
9.51 kg | 6000 mm

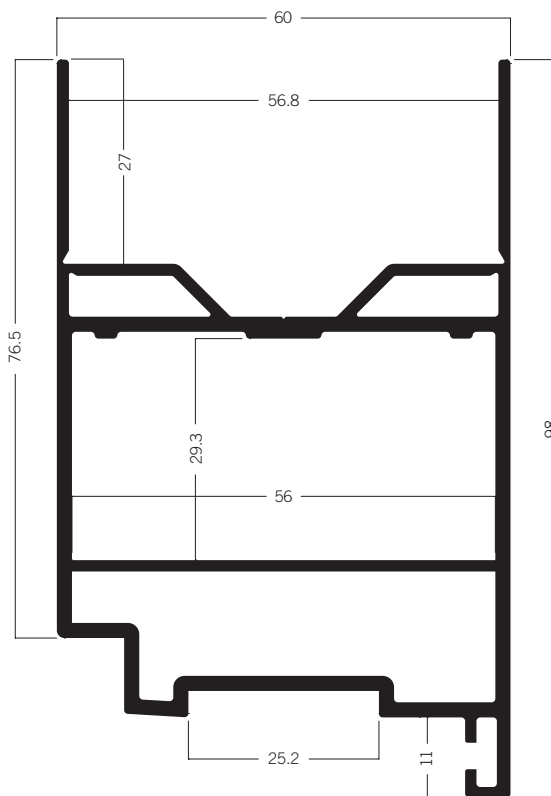

C 304 Türrahmenprofil oben 60 mm
12.12 kg | 6000 mm



KUNSTSTOFF

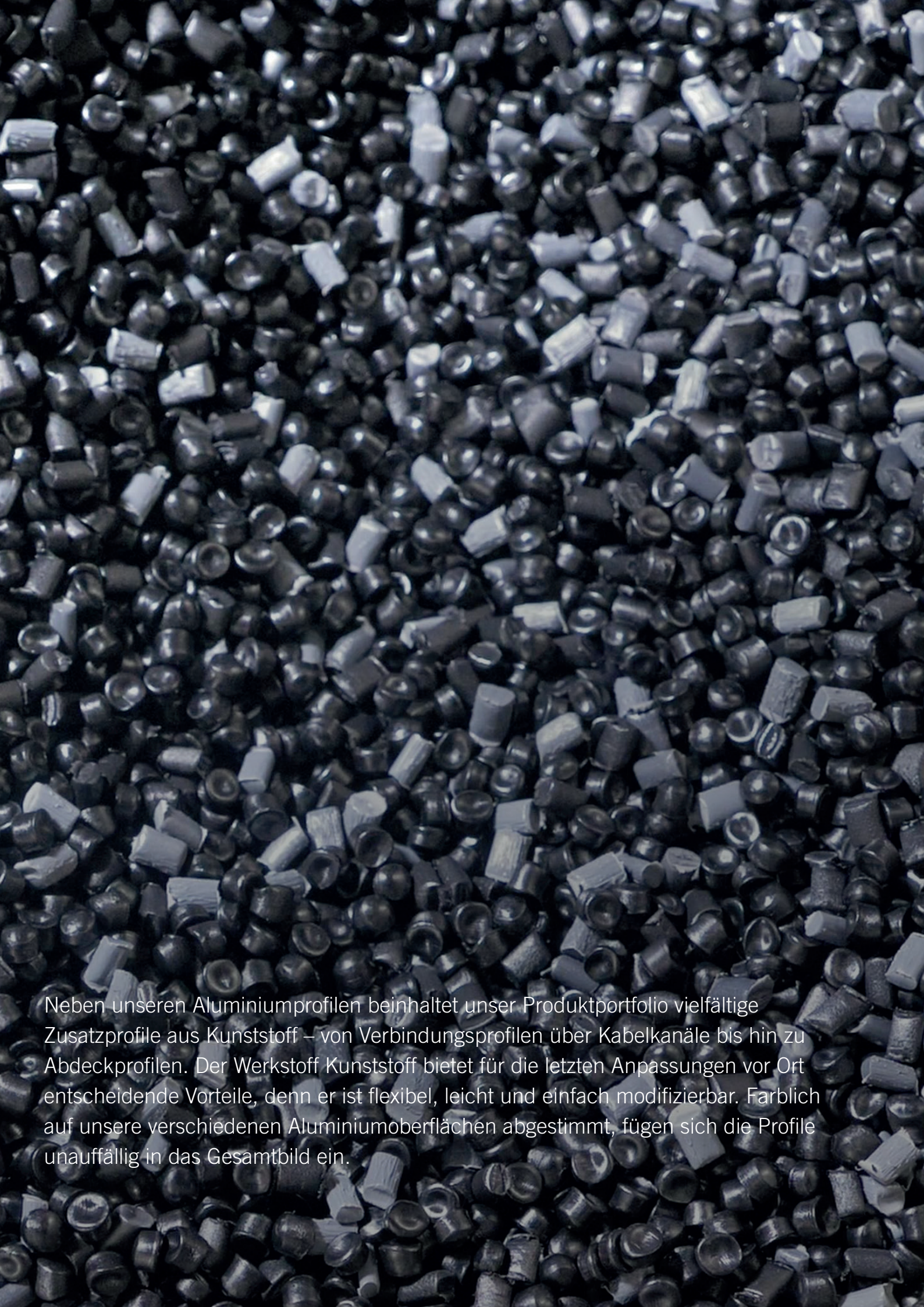

Neben unseren Aluminiumprofilen beinhaltet unser Produktportfolio vielfältige Zusatzprofile aus Kunststoff – von Verbindungsprofilen über Kabelkanäle bis hin zu Abdeckprofilen. Der Werkstoff Kunststoff bietet für die letzten Anpassungen vor Ort entscheidende Vorteile, denn er ist flexibel, leicht und einfach modifizierbar. Farblich auf unsere verschiedenen Aluminiumoberflächen abgestimmt, fügen sich die Profile unauffällig in das Gesamtbild ein.



KUNST STOFF PROFILE

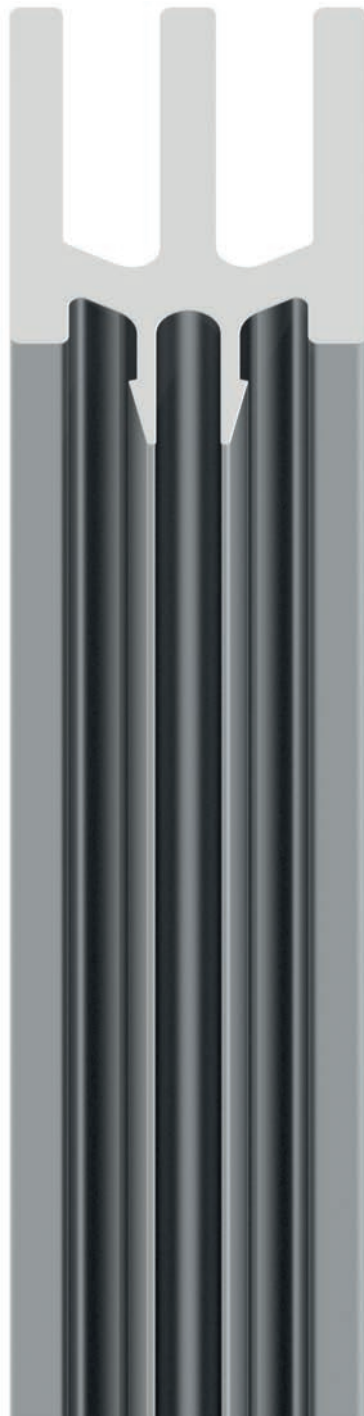

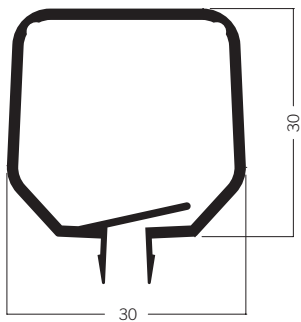

E 463 Kabelhalteprofil
1.20 kg | 5000 mm

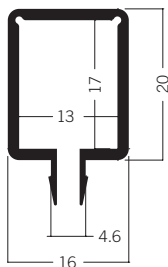

E 460 Kabelhalteprofil
0.73 kg | 5000 mm

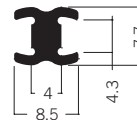

E 438 Verbindungsprofil
0.28 kg | 5000 mm

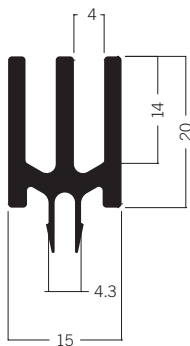

M 1319 Spannrahmenprofil 20 mm
1.46 kg | 6000 mm

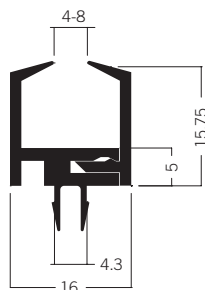

E 420 Glashalteprofil
0.83 kg | 5000 mm

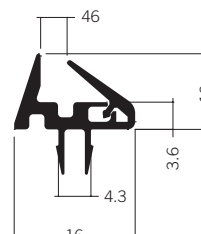

E 424 Glashalteprofil
0.45 kg | 5000 mm

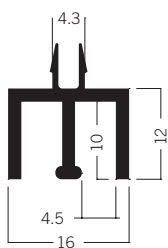

E 400 Schiebetürprofil oben
0.60 kg | 5000 mm

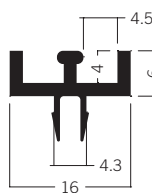

E 401 Schiebetürprofil unten
0.45 kg | 5000 mm

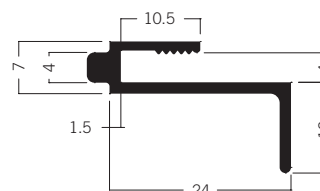

E 410 Schiebetür-Griffleistenprofil
0.50 kg | 5000 mm

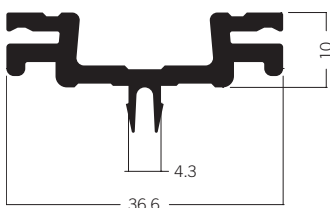

C 160 Adapterprofil 10 × 37 mm
1.61 kg | 6000 mm

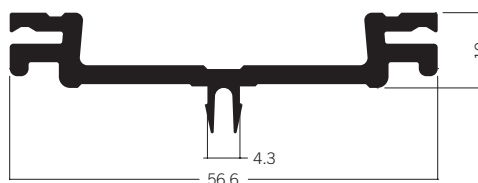

C 159 Adapterprofil 10 × 57 mm
2.04 kg | 6000 mm

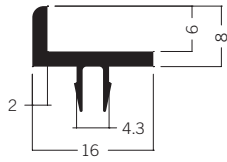

E 442 Auflageprofil
0.40 kg | 5000 mm

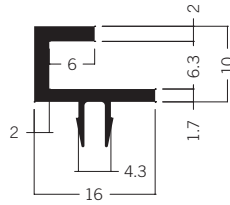

E 440 Glashalteprofil
0.47 kg | 5000 mm

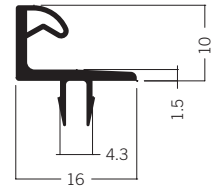

E 430 Türanschlagprofil
0.37 kg | 5000 mm

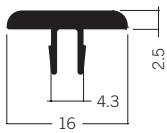

E 458 Abdeckprofil
0.38 kg | 5000 mm

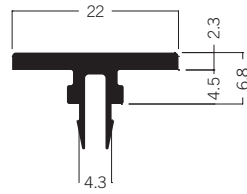

M 1844 Abdeckprofil
0.42 kg | 6000 mm

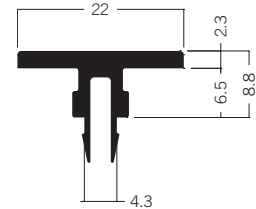

M 1846 Abdeckprofil
0.51 kg | 6000 mm

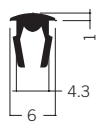

E 455 Nutendichtprofil
0.12 kg | 5000 mm

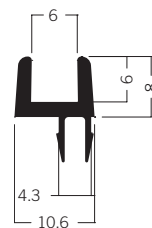

E 421 Glashalteprofil
0.41 kg | 5000 mm



E 441 Moosgummiprofil
1.00 kg | 50000 mm

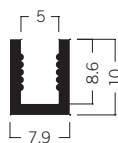

E 476 Klemmprofil
0.19 kg | 5000 mm

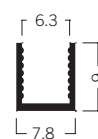

E 477 Klemmprofil
0.17 kg | 5000 mm

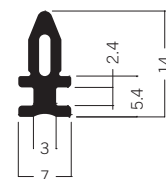

C 725 Verbindungsprofil
0.26 kg | 5950 mm

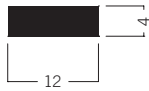

E 480 Gummi-Flachprofil
0.07 kg | 10000 mm

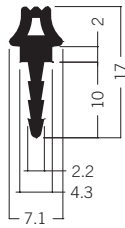

E 451 Verbindungsprofil
0.35 kg | 5000 mm

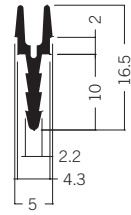

E 452 Verbindungsprofil
0.23 kg | 5000 mm

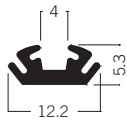

E 444 Klapperschutz
2.02 kg | 50000 mm

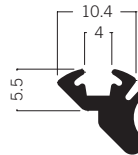

E 445 Klapperschutz
3.50 kg | 50000 mm

A

A 200 62

C

C 60-100 70

C 60-105 70

C 60-110 70

C 60-125 70

C 60-130 71

C 60-1005 71

C 60-1007 71

C 60-1029 71

C 100 68

C 105 68

C 110 68

C 115 74

C 120 68

C 122 69

C 124 68

C 125 68

C 130 69

C 151 66

C 153 66

C 154 67

C 155* 66

C 157 66

C 158 66

C 159 82

C 160 82

C 161 66

C 162 66

C 163 66

C 165 67

C 169 67

C 170 67

C 171 67

C 301 77

C 302 77

C 304 77

C 305 74

C 308 76

C 309 76

C 310 76

C 311 76

C 315 75

C 316 75

C 404* 73

C 601 73

C 604 73

C 606 73

C 608 73

C 612 72

C 613 72

C 670 72

C 680 72

C 701 73

C 722 67

C 725 83

C 875 66

C 1005* 69

C 1210 74

C 1220 74

C 1301 67

C 1327 69

C 1415 67

CO 730* 41

D

DFL 230 24

DFL 400 37

DFL 400A* 37

DFS 84 11

DFS 84/6000 11

E

E 400 82

E 401 82

E 410 82

E 410/AL 62

E 420 82

E 421 83

E 424 82

E 430 83

E 438	82
E 440	83
E 441	83
E 442	83
E 444	84
E 445	84
E 451	84
E 452	84
E 455	83
E 458	83
E 460	82
E 463	82
E 470/N	62
E 471/N	62
E 472	62
E 476	83
E 477	83
E 480	84
E 800	63
E 850*	63

M

M 225	12
M 226	12
M 260	35
M 770	24
M 1000	9
M 1001	9
M 1002	9
M 1003	9
M 1005	9
M 1007	9
M 1009	31
M 1010	9
M 1017	11
M 1018	10
M 1019	10
M 1020	10
M 1021	10
M 1022*	10
M 1023	10

M 1025	20
M 1026	20
M 1029	22
M 1031	22
M 1043*	22
M 1044	57
M 1046	13
M 1052	23
M 1059	11
M 1060*	23
M 1063	17
M 1069	20
M 1070	31
M 1072	29
M 1081	20
M 1082	20
M 1092	20
M 1140	34
M 1155	11
M 1201*	34
M 1202	34
M 1208	34
M 1222	35
M 1301	42
M 1302	40
M 1304	44
M 1305	42
M 1306	42
M 1307	43
M 1309	40
M 1310	40
M 1312	40
M 1319	82
M 1320	17
M 1321	41
M 1322	41
M 1322/E	41
M 1322/I	41
M 1325	45
M 1326	40
M 1330	48

M 1332	41
M 1340	19
M 1354	53
M 1356	53
M 1367	57
M 1368	57
M 1400	8
M 1460	34
M 1504	42
M 1520*	63
M 1562	59
M 1567	59
M 1571	59
M 1572	59
M 1577	59
M 1581	59
M 1600*	34
M 1602	14
M 1603*	14
M 1606	34
M 1607	40
M 1614	40
M 1618	8
M 1620	34
M 1622	28
M 1625	8
M 1629	30
M 1844	83
M 1846	83
M 1901	48
M 1910	44
M 1915	48
M 1920	44
M 1925	45
M 1930	42
M 1935	45
M 1970	42
M 1980	62

R

R 102	25
R 122	25

S

S 10*	8
S 100	26
S 108	26
S 201	26
S 203	26
S 206	28
S 209	9
S 250	32
S 251	32
S 252	32
S 302	30
S 308	26
S 380	26
S 382	43
S 385R*	43
S 408	27
S 500	30
S 1100	34
S 1105	34
S 1106	34
S 1123	8
S 1125	8
S 1129	31
S 1200	34
S 1302*	28
S 1303	28
S 1310	29
S 1610*	21
S 3050	36
S 6105	36
SO 400	60
SO 500	60
SO 600	60
SO 620	61

SO 630	60
SO 640	61
SO 642	61

U

U 1020	10
U 1030*	18
U 1060	49
U 1063	50
U 1066	18

V

V 2000	8
V 2020*	30
V 2040	14

W

W 101	58
W 103	58
W 110*	58
W 416	14
W 730	43
W 735R*	43
W 825*	21
W 901*	21
W 906	43
W 908	33
W 910	57
WP 820	47
WP 830	57
WP 840	47
WP 850	46
WP 860	46

Z

Z 100	15
Z 110	17
Z 160	17
Z 164*	17
Z 300	14
Z 303	14

Z 305	14
Z 307	14
Z 308	14
Z 310	15
Z 400	16
Z 402	16
Z 408*	16
Z 460	16
Z 464*	16
Z 508	19
Z 560	19
Z 600	19
Z 2100	20
Z 2105	20
Z 4100	15
Z 4300	15
Z 4400	15
Z 4401	15
Z 4700	15



EXHIBITION SYSTEMS
PROJECT SOLUTIONS
PRESENTATION
INTERIOR DESIGN
CLEANROOM SYSTEMS

OCTANORM®-Vertriebs-GmbH
für Bauelemente
Raiffeisenstraße 39
70794 Filderstadt
T. +49 711 77003-0
F. +49 711 77003-53
info@octanorm.de
www.octanorm.com