

# Spot on Lights

Lights with a system.

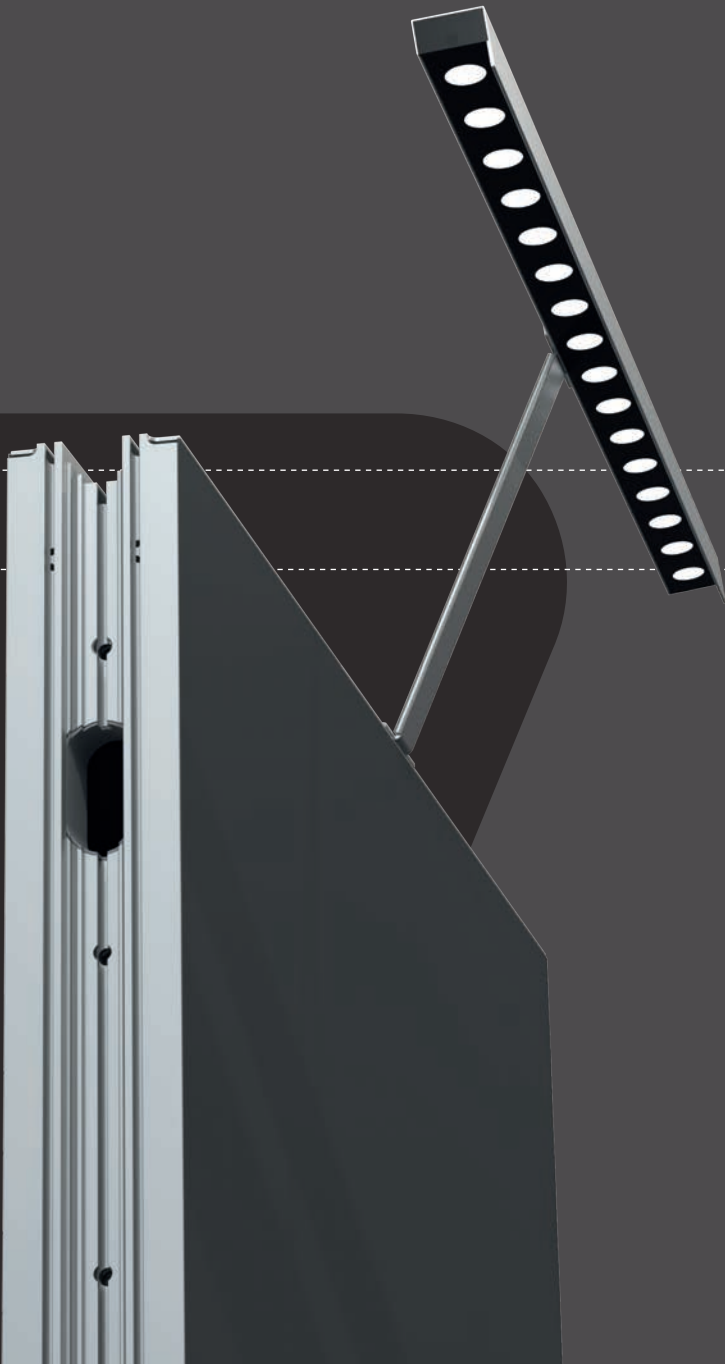



**steal  
the spot  
light.**

➤ Lights

➤ Wallwasher	04
➤ Hanging Lamp	04
➤ Pendant Light	08
➤ Circular Lamp	12
➤ Illuminated Cube	16
➤ In Action	20



### **An elegant solution: M 1497 and M 1497-H**

Whether as a wallwasher with a delicate holding arm or as a ceiling light suspended from thin steel cables – this luminaire takes a back seat and draws attention to your product.

The design is as impressive as the technical values: 16 or 32 high-power LEDs provide shadow-free illumination and 5700 K for a neutral light color. The brightness can be adjusted with an optional dimmer.



### **No more hotspots!**

Our wallwasher illuminates an area of 1000 mm wide and 2500 mm high with 3600 lm light output evenly and without shadows. Up to five lights can be connected to one power supply. During installation, the holding arm simply swivels into the system groove and can later be removed from the luminaire head without tools for space-saving storage of the wallwasher.

## ↗ Wallwasher/Hanging Lamp

### Technical Features



#### **Simple design – high performance!**

The hanging lamp blends in seamlessly with the overall picture. This is made possible by the clean design and delicate suspension.

With its simple plug-and-play solution, uniform illumination and high-quality materials, the M 1497-H is the perfect package.



## Wallwasher/Hanging Lamp

elegant aluminium finish / for system groove or suspended from ceiling / high-quality LEDs / neutral light color

### Wallwasher LED / 28 W / 230 V



available in  
silver .31,  
black .33

#### M 1497.33

**Aluminium, black** | for uniform illumination of 1000 mm width and 2500 mm height (5700 Kelvin > Cri 90, 3600 lm, 28 W, 125 lm/W), for 230 V power source, for system groove 4.3 mm, space-saving and securely packed, with 16 high-power LEDs, PSU incl. cable (500 mm to lamp and 2500 mm from power supply)

2.041 kg | L 812 × W 166 × H 263 mm

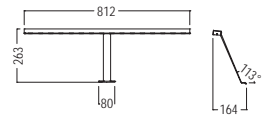

### Hanging lamp LED / 56 W / 230 V



#### M 1497-H.33

**Aluminium, black** | for a homogenous illumination in 5700K > Cri 90, with 32 highpower LEDs, 7200 lm, 56 W, 128 lm/W, for 230 V, incl. 3.5 m wire rope with 2 × Reutlinger wire rope holders to adjust height, 2 × plastic end caps black, 1 × power supply unit incl. DC distributor, 3 m extension cable with DC connector

2.49 kg | L 812 × W 150 × H 35 mm

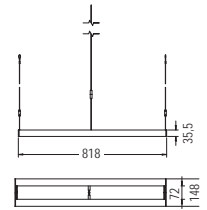

### Long-arm Floodlight LED / 25W



available in  
silver .31,  
black .33

without  
connecting  
cable  
M 1494-xxxx

#### M 1494.33

**Aluminium, black** | for swivel mounting in system groove, incl. adapter plate and connection cable 3 m, 25 W, 2500 lm, 4000 K, voltage input: 100-240 VAC, voltage output: 27-35 VDC, color rendering index: 80+ CRI, beam angle: 120°, up to 10 floodlights can be connected in series

0.76 kg | L 490 × W 232 × H 40 mm

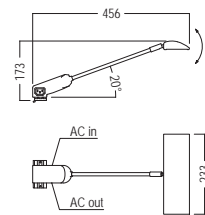

# ↗ Wallwasher/Hanging Lamp

## Product Details





**High-quality COB LEDs  
provide outstanding brightness  
and long life.**

## ➤ Pendant Light

### Technical Features

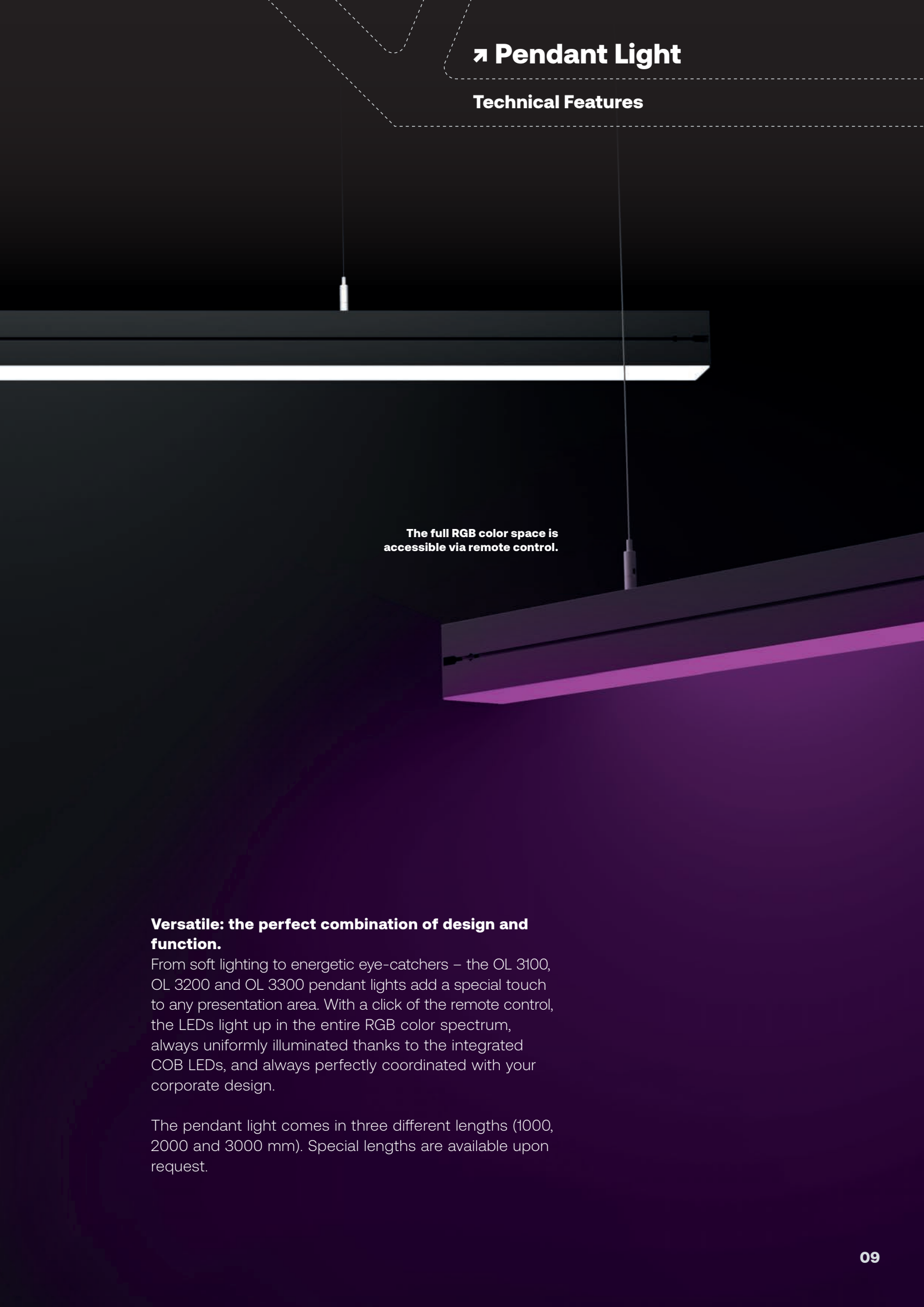

The full RGB color space is accessible via remote control.

#### **Versatile: the perfect combination of design and function.**

From soft lighting to energetic eye-catchers – the OL 3100, OL 3200 and OL 3300 pendant lights add a special touch to any presentation area. With a click of the remote control, the LEDs light up in the entire RGB color spectrum, always uniformly illuminated thanks to the integrated COB LEDs, and always perfectly coordinated with your corporate design.

The pendant light comes in three different lengths (1000, 2000 and 3000 mm). Special lengths are available upon request.



## Pendant Light

elegant aluminium finish / suspended from ceiling / RGB-capable, dimmable LEDs / coated in RAL colors on request

### Pendant light 1000 mm long



available in  
silver .01,  
black .03  
or .28  
satin gloss  
RAL (Gg 70-80)

#### OL 3100

**Aluminium, black** | Set consisting of: 1 × upright L 1022-1000B, 1 × power cable L 204, 1 × RGB remote control L 182-2, 2 × steel rope 1,5 × 3.500 mm OL 466, 2 × wire rope retainer set L 222

4.10 kg | L 1000 × W 80 × H 80 mm

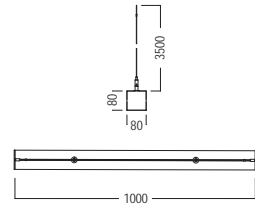

### Pendant light 2000 mm long



available in  
silver .01,  
black .03  
or .28  
satin gloss  
RAL (Gg 70-80)

#### OL 3200

**Aluminium, black** | Set consisting of: 1 × upright L 1022-2000B, 1 × power cable L 204, 1 × RGB remote control L 182-2, 2 × steel rope 1,5 × 3.500 mm OL 466, 2 × wire rope retainer set L 222

6.93 kg | L 2000 × W 80 × H 80 mm

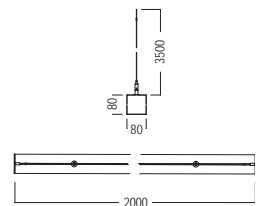

### Pendant light 3000 mm long



available in  
silver .01,  
black .03  
or .28  
satin gloss  
RAL (Gg 70-80)

#### OL 3300

**Aluminium, black** | Set consisting of: 1 × upright L 1022-3000B, 1 × power cable L 204, 1 × RGB remote control L 182-2, 2 × steel rope 1,5 × 3.500 mm OL 466, 2 × wire rope retainer set L 222

9.88 kg | L 3000 × W 80 × H 80 mm

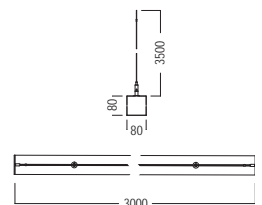

# ↗ Pendant Light

## Product Details

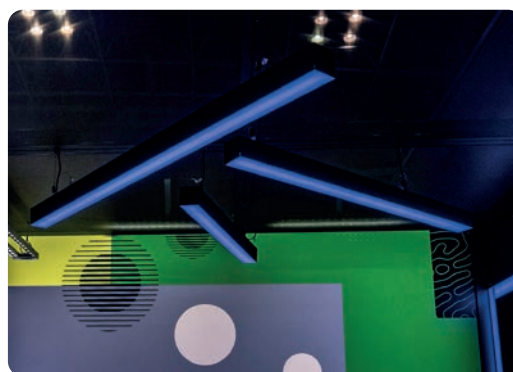

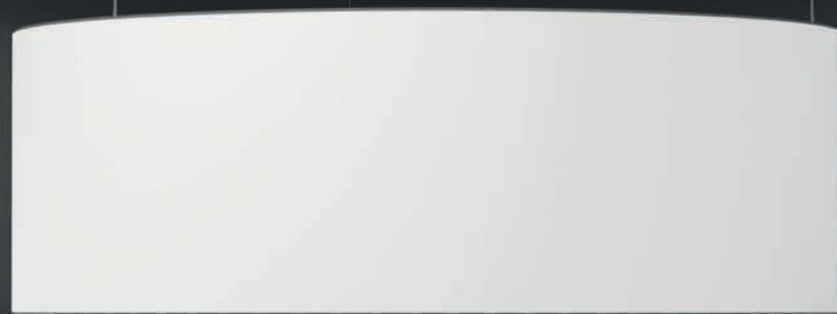
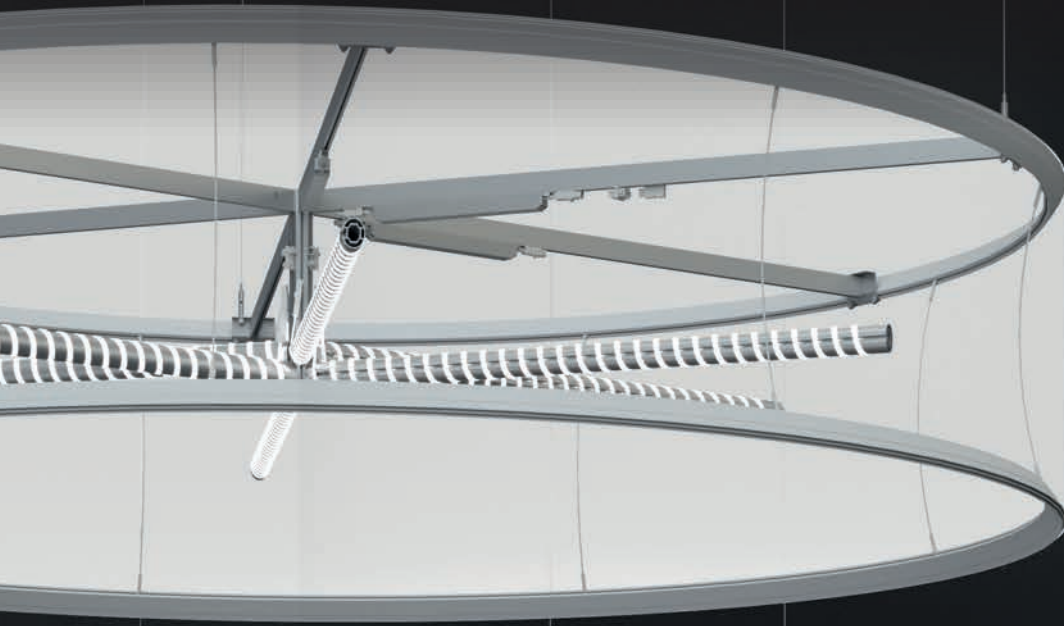

**Atmosphere combined with maximum advertising space.**

The circular lamps (OL 440, OL 450, OL 460) suspended from the ceiling not only create a pleasant atmosphere, but also provide additional space for fabric graphics all around. The graphics are seamlessly mounted, with only a fine 2 mm extrusion edge visible at the top and bottom. The bright LEDs (6500 K) ensure optimal color rendering of the fabric graphics.

The circular lamp comes in three different diameters (1000, 2000 and 3000 mm) and a height of 500 mm. Special dimensions are available on request.

## ↗ Circular Lamp

### Technical Features

Cabling runs invisibly up through the suspension.



#### **Full power in minimum space!**

With an extrusion depth of only 40 mm, the OL 480 circular lamp has an impressive light output of 9000 lm. Thanks to the full-surface LED backlighting, the luminous flux is focused on the surface of the fabric. The result: maximum luminous efficiency, uniform illumination and a neutral light color of 6500 K.



## Circular Lamp

elegant aluminium finish / suspended or ceiling-mounted / high-quality LEDs / for seamless fabric graphics

### Circular lamp Ø 1000 mm for seamless graphics



#### OL 440.01

**Aluminium** | 1 × ceiling lamp, for seamless graphics, LED modules and LED power supply unit mounted (6500 K, 9860 lm, 140 W), incl. cable with Schuko plug

without fabric/graphics

11 kg | L 1000 × W 1000 × H 500 mm

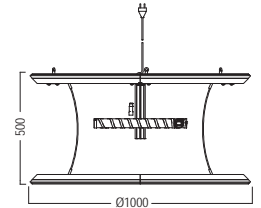

### Circular lamp Ø 2000 mm for seamless graphics

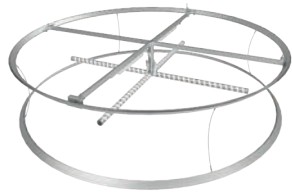

#### OL 450.01

**Aluminium** | 1 × ceiling lamp, for seamless graphics, LED modules and LED power supply unit mounted (6500 K, 16320 lm, 230 W), incl. cable with Schuko plug

without fabric/graphics

21 kg | L 2000 × W 2000 × H 500 mm

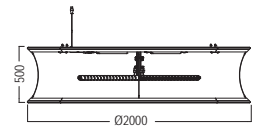

### Circular lamp Ø 3000 mm for seamless graphics

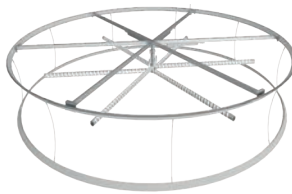

#### OL 460.01

**Aluminium** | 1 × ceiling lamp, for seamless graphics, LED modules and LED power supply unit mounted (6500 K, 40800 lm, 576 W), incl. cable with Schuko plug

without fabric/graphics

37 kg | L 3000 × W 3000 × H 500 mm

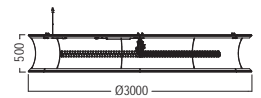

### Circular lamp Ø 800 mm ceiling-mounted



#### OL 480.23

**Aluminium, black** | 1 × round ceiling lamp of M 1930 black with suspension, minimalistic extrusion edges for maximum usable area, aluminium composite panel with LEDs for backlighting, LED module and PSU preinstalled, luminous color: 6500, electric power: 99,5 W, luminous intensity: 900 lm, incl. 1 × cable with Schuko plug and 1 × white fabric without graphic

without graphics

9.8 kg | L 800 × W 800 × H 40 mm

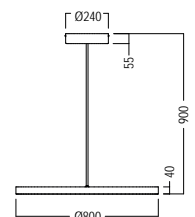

# ↗ Circular Lamp

## Product Details



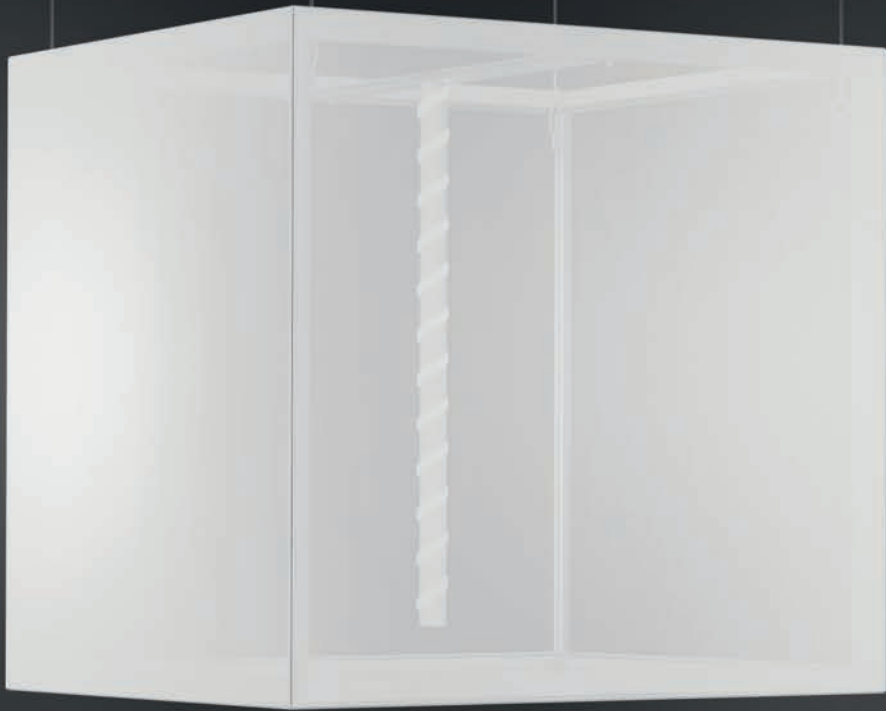

**Effective from a distance and from all sides.**

With up to five illuminated sides and a maximum edge length of 2500 mm, the illuminated cubes create a highly impressive long-distance effect. The specially arranged fabric grooves make the extrusion edge almost invisible, giving the impression that the fabric motif runs continuously around the entire illuminated cube. And there is more: The underside can be used for advertising or as an illuminated ceiling.

Thanks to their light weight, even large cubes can be suspended from the ceiling without any problems. Since each cube is custom made, any edge length can be selected up to a maximum of 2500 mm.

## ➤ Illuminated Cube

### Technical Features

#### **Any size perfectly illuminated.**

The use of multiple light sources ensures uniform illumination and high luminosity regardless of size. The high quality LEDs are specially adapted to the illuminated cubes and are extremely durable and bright.

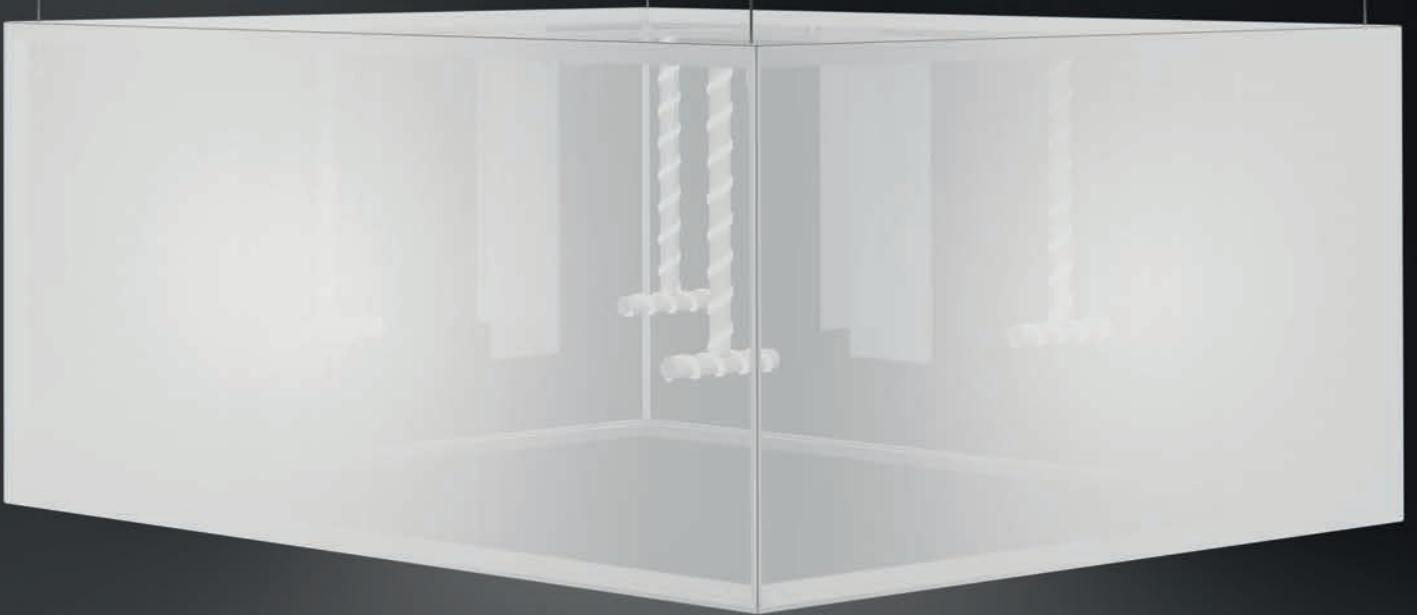



## Illuminated Cube

elegant aluminium finish / suspended from ceiling / high-quality LEDs / can be fully covered with fabric graphics

### Cube custom size



Maximum edge length for cubes is 2500 mm.

### OL 690.01

**Aluminium** | cube solution for ceiling suspension (depending on size), optional with lighting element OL 675 (straight), OL 670 (T-shaped) or OL 680 (cone-shaped), up to 2500 mm edge length

without fabric/graphics

Custom size: please specify dimensions in your order

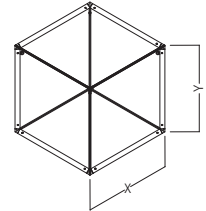

### Illumination element straight (3400 lm / 40 W) 4-sides illuminated



PSU and Z 460 extrusion not included

### OL 675.90

**Aluminium** | Straight illumination element, made of extrusion M 1201, for 4-sided illumination of cubes with 1000 mm height, 6500 K, incl. LED strips and cable connection

1 kg | L 40 × W 40 × H 850 mm

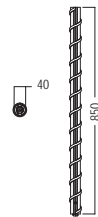

### Illumination element T-form (3400 lm / 40 W) 5-sides illuminated



PSU and Z 460 extrusion not included

### OL 670.90

**Aluminium** | T-shaped illumination element, made of extrusion M 1201, for 5-sided illumination of cubes with 1000 mm height, 6500 K, incl. LED strips and cable connection

1.1 kg | L 300 × W 50 × H 602 mm

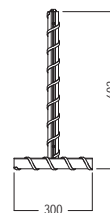

### Illumination element cone (19780 lm / 12 W) for cube > 150 cm



Only to be installed by expert staff

### OL 680.90

**Plastic** | for cubes with edge lengths bigger than 150 cm, complete with bulb fitting and connecting cable, voltage: 100-230 V AV, output: 120 W, IP64, 15600 lm, bulb fitting: E40

1.8 kg | L 135 × W 140 × H 280 mm

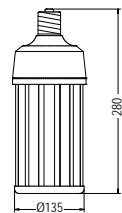

## ➤ Illuminated Cube

### Product Details

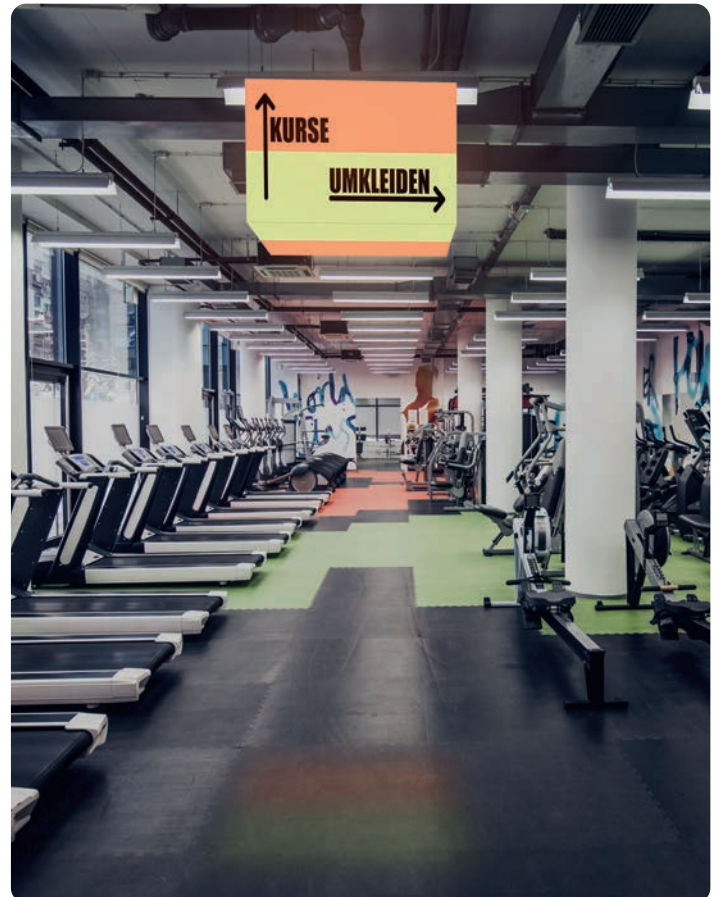



## ➤ In Action

Spot on



**exhibition systems**  
**project solutions**  
**cleanroom solutions**



**octanorm** 

**OCTANORM®-Vertriebs-GmbH**

für Bauelemente

Raiffeisenstraße 39

70794 Filderstadt, Germany

**T** +49 711 77003-0

**E** [info@octanorm.de](mailto:info@octanorm.de)

**Adria**

[octanormadria.com](http://octanormadria.com)

**Australia**

[octanorm.com.au](http://octanorm.com.au)

**Belgium**

[octanorm.be](http://octanorm.be)

**China**

[octanorm.cn](http://octanorm.cn)

**Emirates**

[octanormemirates.net](http://octanormemirates.net)

**España**

[octanorm.es](http://octanorm.es)

**France**

[octanorm.fr](http://octanorm.fr)

**Hellas**

[octanorm.gr](http://octanorm.gr)

**Italia**

[octanorm.it](http://octanorm.it)

**Japan**

[octanorm.co.jp](http://octanorm.co.jp)

**México**

[octanorm.com.mx](http://octanorm.com.mx)

**Nigeria**

[it-al.design](http://it-al.design)

**Nordic**

[octanorm.se](http://octanorm.se)

**North America**

[octanormna.com](http://octanormna.com)

**Polska**

[octanorm.pl](http://octanorm.pl)

**South Africa**

[octanorm.co.za](http://octanorm.co.za)

**UK**

[octanorm.co.uk](http://octanorm.co.uk)

[octanorm.com](http://octanorm.com)