

"VARIANTE 1"

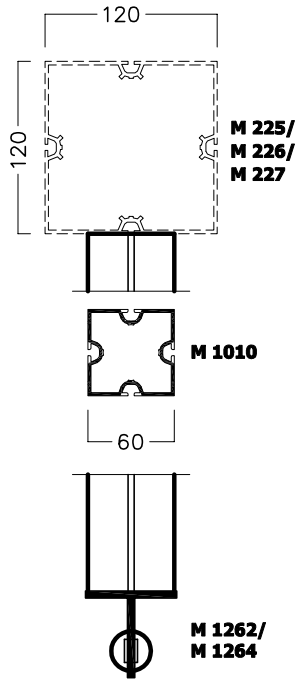

7 Achsen
8 Achsen
10 Achsen
12 Achsen
14 Achsen

"VARIANTE 2"

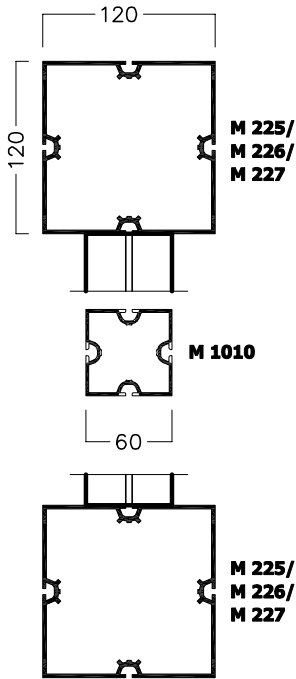

7 Achsen
8 Achsen
10 Achsen
12 Achsen
14 Achsen

"VARIANTE 3"

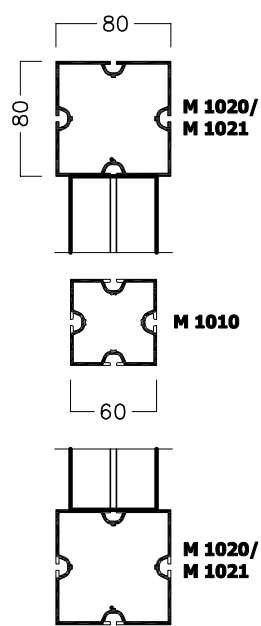

6 Achsen
7 Achsen
8 Achsen
10 Achsen

"VARIANTE 4"

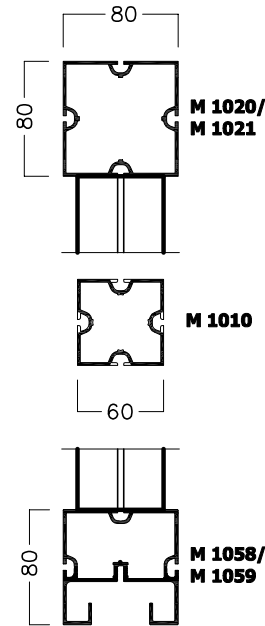

6 Achsen
7 Achsen
8 Achsen
10 Achsen

"VARIANTE 5"

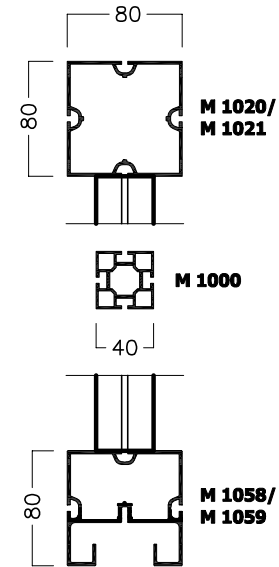

6 Achsen
7 Achsen
8 Achsen
10 Achsen

"VARIANTE 6"

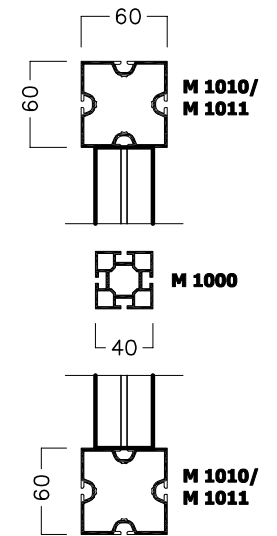

5 Achsen
6 Achsen
7 Achsen

WICHTIG!

Einzelträger neigt zur seitlichen Verdrehung.
Empfehlung: Parallelverbau inklusive seitlichen Verstreibungen.

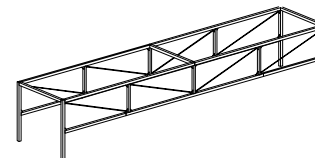

TIM-41.0 EW 2873-30 27.08.07/WG, geät: 28.01.08/HB 01/2008 shift