

Drilling jig for square and upright extrusions 80 mm BS 33

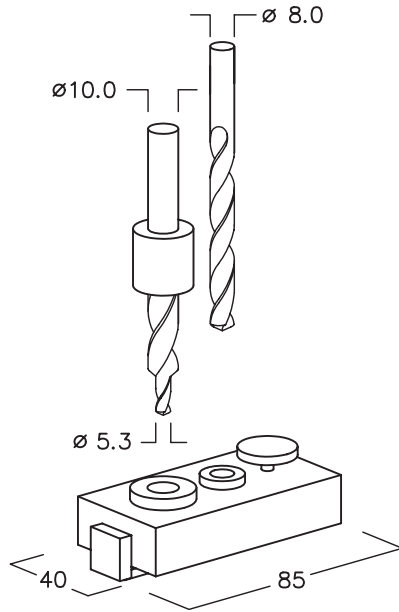

for profile :



*Important :
Adjustment
of ring*

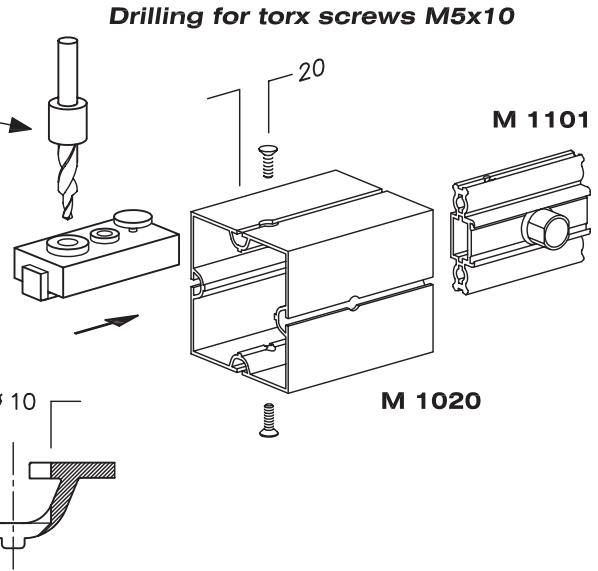

Drilling for operating the tension lock (adapter M 1101, M 1281)

plastic, steel, galvanized, incl. countersink drill $\varnothing 5.3 / \varnothing 10$ and drill $\varnothing 8$ for tension lock adapter M 1101, M 1291 and hinge adapter M 1281

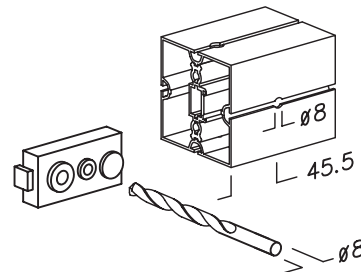

Drilling for operating the tension lock (adapter M 1291)

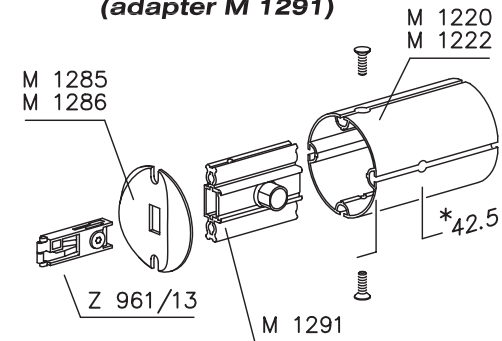

** Important :
Special drilling
Drilling jig to be moved
by "3mm"*