

# Connecting splines (alum.) with antislipping device

TI-MB-VW10.0

## technical information

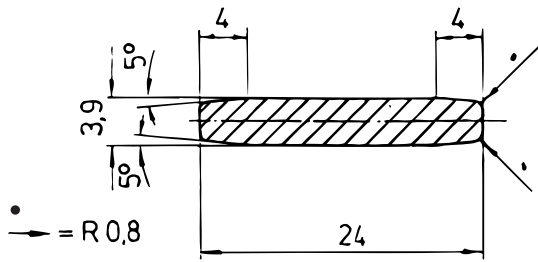

slightly countersunk

M 2:1

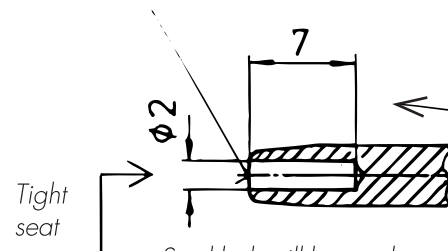

Steel bolt will be used as antislipping device during the mounting only (option)

Cylinder bolt, steel, dia. 2 mm, 14 mm long

(14)

blind hole on one side

Treatment of extrusions

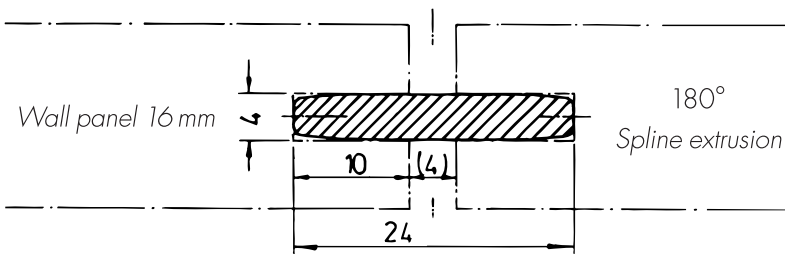

Mounting example

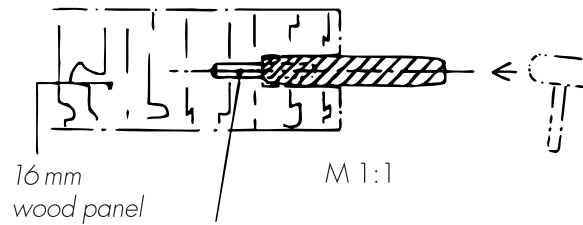

Steel bolt as antislipping device

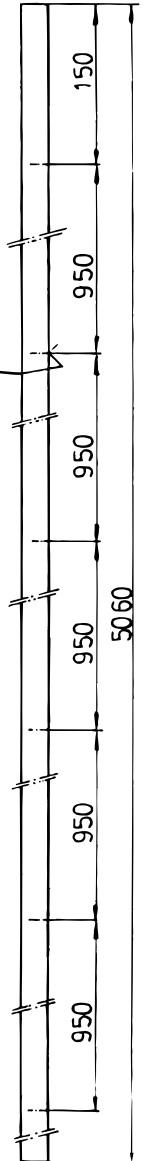

TI MB-VW 10.0 04.1990 10/05 SHIFT