

Maße für Einlege-Böden (Holz)

Zargenlänge + 22 = Plattenmaß (Breite x Tiefe) ◀

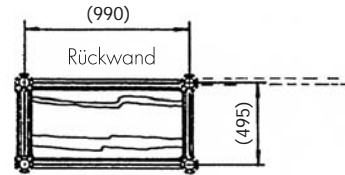

Zargenlänge + 28 = Plattenmaß (Tiefe) ◀

Beispiel

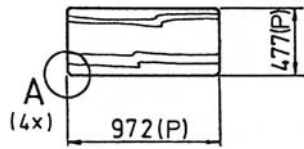

Beispiel 1
Rückwand 16 mm

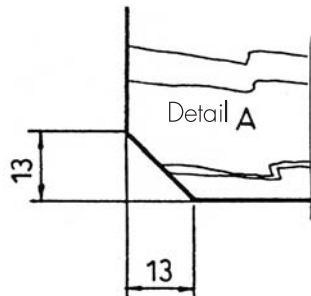
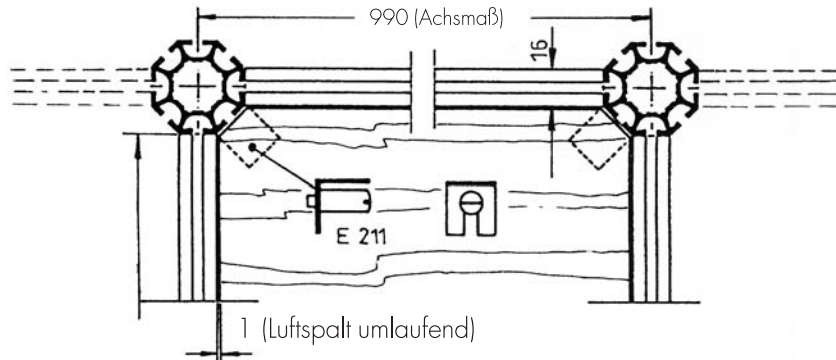

Beispiel

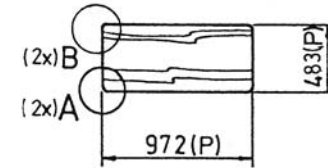

Beispiel 2
Rückwand 4 mm

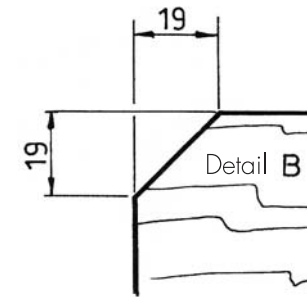
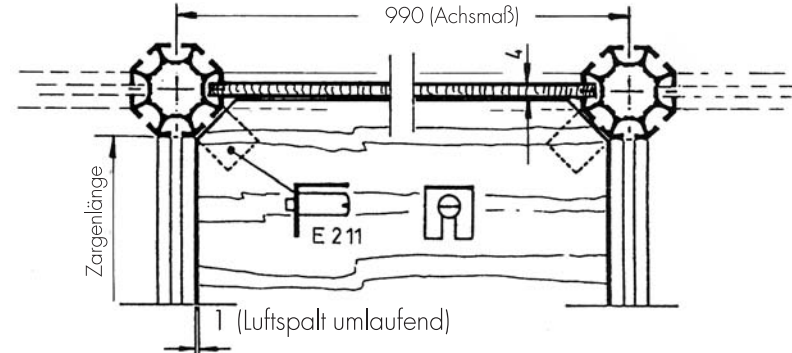

TI MB-W 4.0.04.1990 10/05 SHIFT