

~ = opening for cable outlet

\* = frame connector for horizontal assembly

+ = frame connector for vertical assembly (always 2 connectors per frame)

Note: The distance from the corner to the system connection (\*) and the cable outlets (~) is identical with the standard frame sizes.

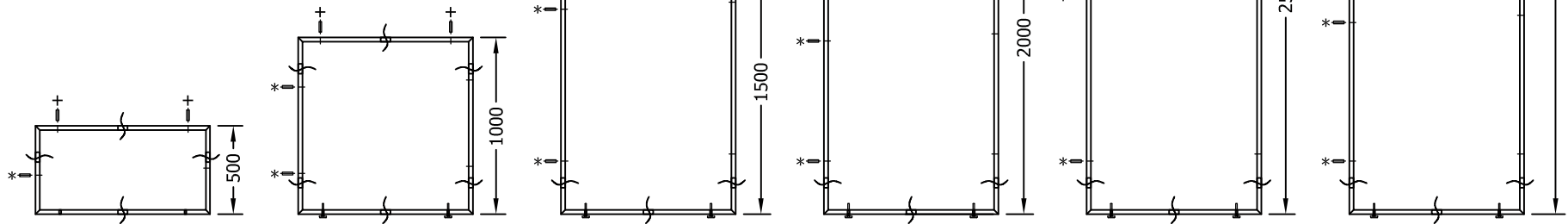

width of frames: 450 - 1250mm

octawall 60 panel/fabric  
frame-to-frame connection vertical and horizontal:  
fixing set W 835

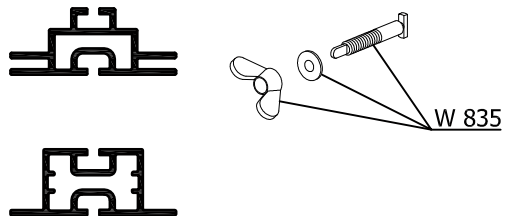

octawall 40 panel  
frame-to frame connection vert.: fixing set W 915  
frame-to-frame connection hor.: tension lock Z 961/13

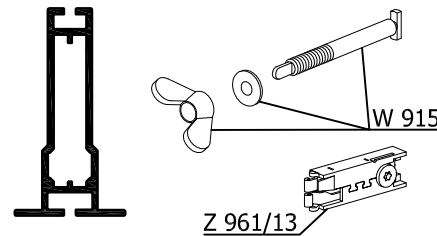

octawall 40 fabric  
frame-to-frame connection vertical and horizontal:  
fixing-set M 1477

